



Webbs

Helping people move since 1994

Wolverhampton Road | Walsall | WS3 4AE

£1,150 PCM

 **Webbs**
estate agents

Summary

Located just a stone's throw from Pelsall Village and its excellent local amenities, this well-presented three-bedroom home on Wolverhampton Road is available to let, offering an ideal opportunity for tenants seeking a spacious and comfortable rental in a prime location.

To the front, a large driveway provides ample parking and leads to the garage. Inside, the spacious lounge diner serves as the heart of the home, with patio doors opening onto the private rear garden—filling the space with natural light and creating a bright, welcoming atmosphere. Stairs from this central area lead to the first floor.

At the front of the property, the modern, refitted kitchen offers generous storage and worktop space, with convenient internal access to the garage, which also features a useful utility area at the rear.

Upstairs, three generously sized bedrooms offer comfortable accommodation, all served by a stylish four-piece suite bathroom.

Key Features

Rooms and Dimensions

PROPERTY DETAILS:

Lounge Diner

16'8" x 12'2" (5.081m x 3.730m)

Kitchen

9'8" x 8'10" (2.964m x 2.701m)

First Floor Landing

Bedroom One

12'7" x 10'0" (3.849m x 3.061m)

Bedroom Two

9'11" x 9'11" (3.024m x 3.034m)

Bedroom Three

12'7" x 6'3" (3.838m x 1.921m)

Family Bathroom

6'5" x 9'10" (1.956m x 3.005m)

Garage

16'2" x 7'5" (4.933m x 2.285m)

Please Note





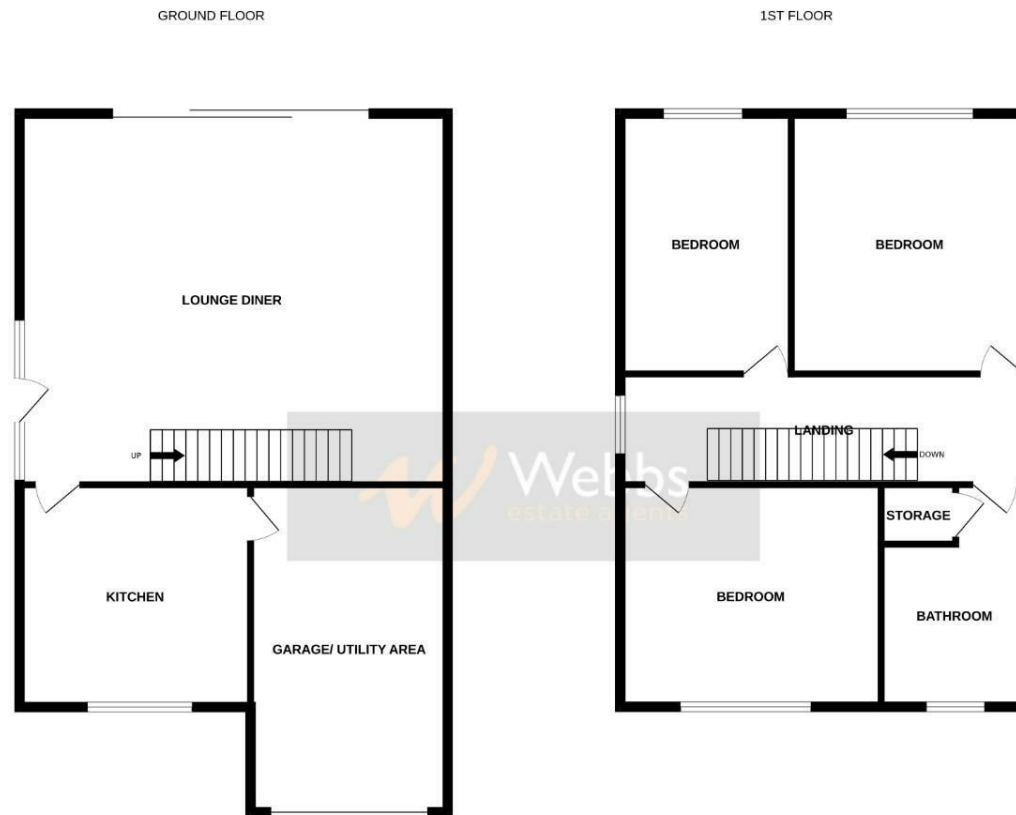

Whilst every attempt has been made to ensure the accuracy of the floorplan contained here, measurements of doors, windows, rooms and any other items are approximate and no responsibility is taken for any error, omission or mis-statement. This plan is for illustrative purposes only and should be used as such by any prospective purchaser. The services, systems and appliances shown have not been tested and no guarantee as to their operability or efficiency can be given.
Made with Metropix ©2025

Webbs Estate Agents - endeavour to maintain accurate depictions of properties in Virtual Tours, Floor Plans and descriptions, however, these are intended only as a guide and purchasers must satisfy themselves by personal inspection.

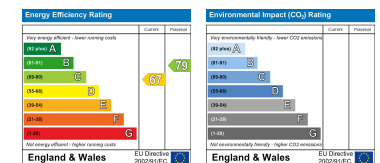

153 Avon Road, Cannock, WS11 1LF

Tel: 01543 468846 | Email: sales@webbsestateagents.co.uk | www.webbestateagents.co.uk