



Redwing Drive | Huntington, Cannock | WS12 4TH

Offers In The Region Of £235,000





# Summary

\*\* SOUGHT AFTER LOCATION \*\* EXTENDED MODERN PROPERTY \*\* LARGE LOUNGE \*\* MODERN KITCHEN \*\* THREE BEDROOMS \*\* FAMILY BATHROOM \*\* GATED COVERED DRIVEWAY \*\* ENCLOSED REAR GARDEN \*\* CLOSE TO CANNOCK CHASE \*\* LOCAL AMENITIES \*\* EXCELLENT SCHOOLS AND TRANSPORT LINKS \*\* EARLY VIEWING ADVISED \*\*

WEBBS ESTATE AGENTS are pleased to offer for sale a modern style extended home in a popular location offering easy access to Cannock Chase, excellent schools and transport links,local shops and amenities.  
In brief consisting of an entrance, modern kitchen, large lounge diner with stairs rising to the first floor. To the first floor there are three good-sized bedrooms and a family bathroom, externally the property has an enclosed rear garden with patio and lawn areas, ample off-road parking is provided by a block paved driveway.  
This is an ideal first-time buyer home and EARLY VIEWING IS ADVISED TO AVOID DISAPPOINTMENT.

# Key Features

- EXTENDED THREE BEDROOM SEMI DETACHED HOME
- EXCELLENT SCHOOLS AND TRANSPORT LINKS
- BLOCK PAVED FRONT AND COVERED SIDE DRIVEWAY
- POPULAR LOCATION
- EARLY VIEWING ADVISED
- SPACIOUS LOUNGE DINER
- MODERN STYLE KITCHEN
- IDEAL FOR CANNOCK CHASE
- QUIET CUL-DE-SAC LOCATION

# Rooms and Dimensions

## ENTRANCE

## KITCHEN

11'1" x 8'8" (3.396 x 2.656 )

## SPACIOUS LOUNGE DINER

13'11" x 13'3" ( 4.264 x 4.053 )

## LANDING

## BEDROOM ONE

11'0" x 9'0" (3.369 x 2.764 )

## BEDROOM TWO

15'7" x 6'3" (4.765 x 1.917 )

## BEDROOM THREE

9'0" x 7'5" (2.750 x 2.283 )

## BATHROOM

5'9" x 5'6" (1.772 x 1.687 )

## REAR GARDEN

## FRONT AND COVERED SIDE DRIVEWAY

## Identification checks - C







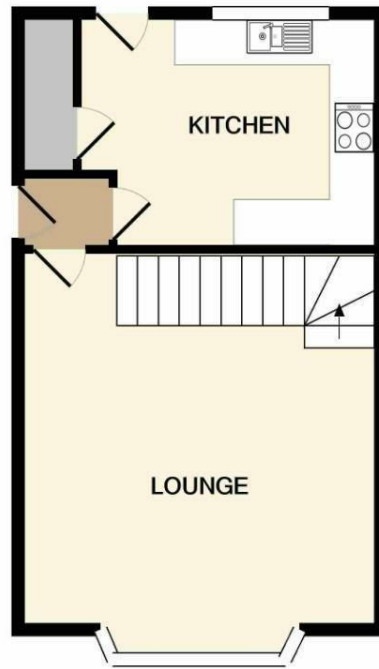

GROUND FLOOR

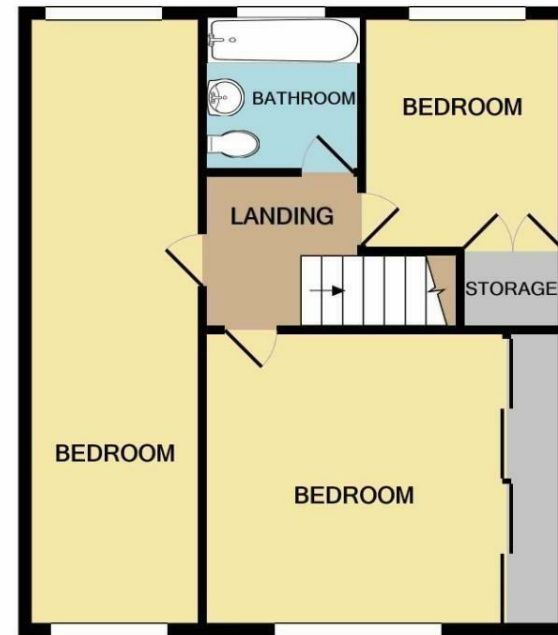

1ST FLOOR

Whilst every attempt has been made to ensure the accuracy of the floor plan contained here, measurements of doors, windows, rooms and any other items are approximate and no responsibility is taken for any error, omission, or mis-statement. This plan is for illustrative purposes only and should be used as such by any prospective purchaser. The services, systems and appliances shown have not been tested and no guarantee as to their operability or efficiency can be given  
Made with Metropix ©2021

Webbs Estate Agents - endeavour to maintain accurate depictions of properties in Virtual Tours, Floor Plans and descriptions, however, these are intended only as a guide and purchasers must satisfy themselves by personal inspection.

