



Webbs

Helping people move since 1994

Stagborough Way | Cannock | WS12 1UD  
Offers In The Region Of £245,000

 **Webbs**  
estate agents



## Summary

**\*\* DESIRABLE LOCATION \*\* SEMI-DETACHED BUNGALOW \*\* TWO BEDROOMS \*\* CONSERVATORY \*\* CLOSE TO TOWN CENTRE \*\* EXCELLENT TRANSPORT LINKS \*\* PRIVATE REAR GARDEN \*\* CHAIN FREE \*\* AMPLE OFF ROAD PARKING \*\* VIEWING STRONGLY ADVISED \*\***

Webbs Estate Agents are delighted to present this spacious semi-detached bungalow, ideally located with convenient access to public transport, Hednesford town centre, local amenities, and just a short distance from the picturesque Cannock Chase.

The well-proportioned accommodation briefly comprises: a welcoming entrance hallway, a fitted kitchen, a shower room, and a generous lounge situated at the rear of the property, leading into a large conservatory that enjoys views over the rear garden. The property also offers two spacious bedrooms, providing comfortable living space throughout.

Externally, the bungalow benefits from ample off-road parking and a neatly maintained front and rear gardens.

Offered with no onward chain – early viewing is highly recommended.

## Key Features

- DESIRABLE LOCATION
- WELL MAINTAINED FRONT AND REAR GARDENS
- CLOSE TO TOWN CENTRE AND TRANSPORT LINKS
- GAS CENTRAL HEATING AND DOUBLE GLAZING
- IDEAL FOR CANNOCK CHASE
- TWO GENEROUS BEDROOMS
- CONSERVATORY
- SPACIOUS LOUNGE AT THE REAR
- EPC RATING OF C
- VIEWING STRONGLY ADVISED

## Rooms and Dimensions

### ENTRANCE HALLWAY

### KITCHEN

9'5" x 7'7" (2.889 x 2.332 )

### SHOWER ROOM

6'5" x 5'5" (1.970 x 1.674 )

### LOUNGE

14'7" x 8'9" (4.466 x 2.685)

### CONSERVATORY

16'3" x 7'9" (4.978 x 2.369)

### BEDROOM ONE

12'11" x 9'11" (3.944 x 3.032)

### BEDROOM TWO

8'8" x 8'2" (2.654 x 2.493 )

### REAR GARDEN

### FRONT GARDEN AND DRIVEWAY

### Identification checks - C









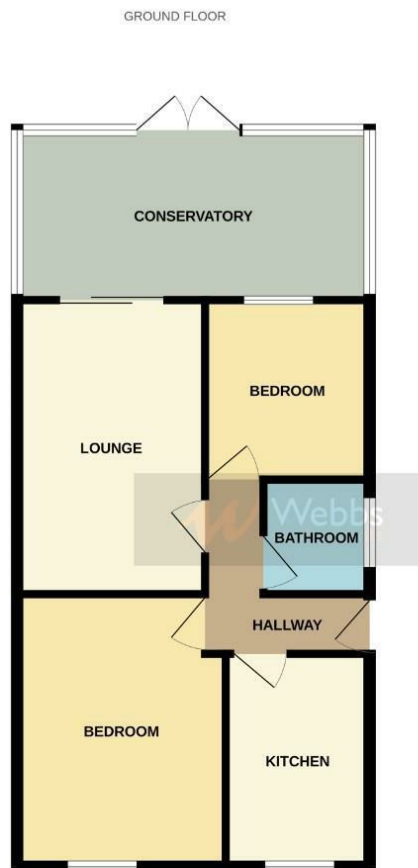

Whilst every attempt has been made to ensure the accuracy of the floorplan contained here, measurements of doors, windows, rooms and any other items are approximate and no responsibility is taken for any error, omission or mis-statement. This plan is for illustrative purposes only and should be used as such by any prospective purchaser. The services, systems and appliances shown have not been tested and no guarantee as to their operability or efficiency can be given.  
Made with floorplan 32025

Webbs Estate Agents endeavour to maintain accurate depictions of properties in Virtual Tours, Floor Plans and descriptions, however, these are intended only as a guide and purchasers must satisfy themselves by personal inspection.

