



PROUD  
GUILD  
MEMBER

The Sidings | Cannock | WS12 1RQ

£700 PCM

 **Webbs**  
estate agents



## Summary

Webbs Estate Agents are pleased to offer this well presented and spacious first floor maisonette in a very popular development bordering Cannock Chase, Hednesford Town Centre and the Train Station.

In brief, the accommodation comprises of; entrance with stairs rising to the living accommodation, a spacious lounge opens onto the kitchen with a range of integrated appliances, two generous bedrooms and bathroom.

Externally there are well maintained communal gardens and allocated residents parking.

## Key Features

## Rooms and Dimensions

### PROPERTY DETAILS:

#### Lounge

11'10" x 11'10" max (3.61 x 3.62 max)

#### Kitchen

5'9" x 9'4" (1.77 x 2.86)

#### Bedroom One

9'1" x 8'11" (2.79 x 2.73)

#### Bedroom Two

8'11" x 5'4" (2.72 x 1.65)

#### Bathroom

5'6" x 6'5" (1.70 x 1.96)

#### Please Note







## GROUND FLOOR

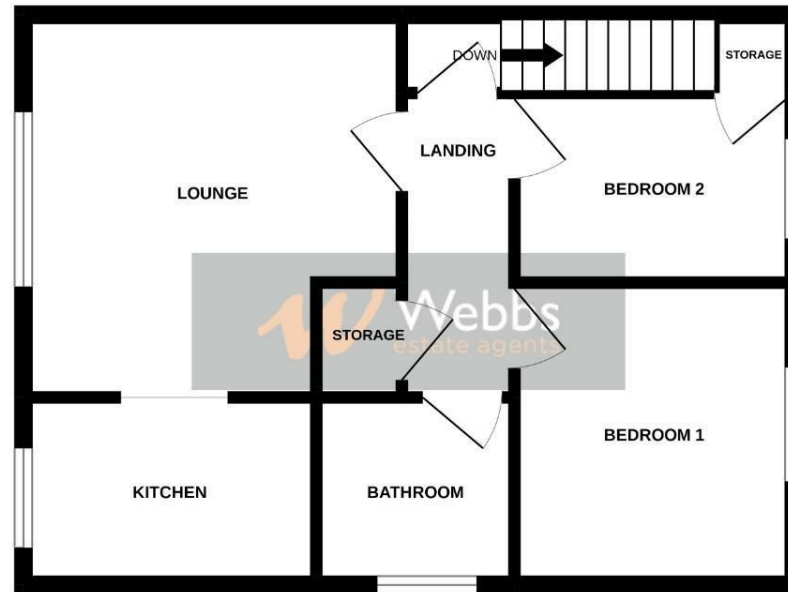

Whilst every attempt has been made to ensure the accuracy of the floorplan contained here, measurements of doors, windows, rooms and any other items are approximate and no responsibility is taken for any error, omission or mis-statement. This plan is for illustrative purposes only and should be used as such by any prospective purchaser. The services, systems and appliances shown have not been tested and no guarantee as to their operability or efficiency can be given.  
Made with Metropix ©2022

Webbs Estate Agents - endeavour to maintain accurate depictions of properties in Virtual Tours, Floor Plans and descriptions, however, these are intended only as a guide and purchasers must satisfy themselves by personal inspection.

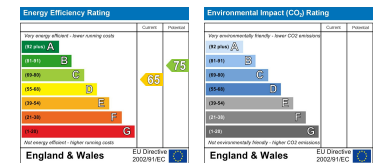

153 Avon Road, Cannock, WS11 1LF

Tel: 01543 468846 | Email: [sales@webbestateagents.co.uk](mailto:sales@webbestateagents.co.uk) | [www.webbestateagents.co.uk](http://www.webbestateagents.co.uk)

**Webbs**  
estate agents