



Park Street | Bridgtown, Cannock | WS11 0BX

Asking Price £200,000





## Summary

**\*\* WOW \*\* IMMACULATELY PRESENTED TWO BED SEMI-DETACHED \*\* CONSERVATORY \*\* BREAKFAST KITCHEN \*\* FAMILY BATHROOM \*\* PRIVATE DRIVE \*\* FULLY ENCLOSED REAR GARDEN \*\***

WEBBS ESTATE AGENT have the absolute pleasure to present for sale a good sized two bed semi . The property is on a quiet side street in Bridgetown . The property is just a short walk from Cannock town centre and is close to all major transport links. The property is not over looked form the front or rear giving a sense of complete privacy. The property briefly comprises of a good sized lounge, Kitchen/diner , conservatory . On the first floor there are two double bedrooms and a modern fitted family bathroom

EXTERNALLY.

There is good sized private rear garden , to the front here is a double drive with an electric car charging point .

**\*\* VIEWING IS ESSENTIAL TO APPRECIATE SIZE AND CONDITION \*\* PEACEFUL LOCATION \*\* CLOSE TO ALL LOCAL SCHOOLS AND AMENITIES \*\***

## Key Features

- IMMACULATE TWO BED SEMI DETACHED
- CONSERVATORY
- FULLY ENCLOSED PRIVATE REAR GARDEN
- WALKING DISTANCE TO CANNOCK TOWN
- BREAKFAST KITCHEN
- FAMILY BATHROOM
- QUIET LOCATION
- CLOSE TO ALL LOCAL AMENITIES AND MAJOR TRANSPORT LINKS

## Rooms and Dimensions

### ENTRANCE HALLWAY

### LOUNGE

14'8" x 9'11" (4.47m x 3.02m)

### BREAKFAST KITCHEN

12'10" x 8'4" (3.91m x 2.54m)

### CONSERVATORY

12'7" x 9'3" (3.84m x 2.82m)

### FIRST FLOOR LANDING

### MASTER BEDROOM

11'0 x 10'5" (3.35m x 3.18m)

### BEDROOM TWO

12'8" x 6'5" (3.86m x 1.96m)

### FAMILY BATHROOM

### EXTERNALLY

### FULLY ENCLOSED PRIVATE REAR GARDEN

### DOUBLE PRIVATE DRIVE

### Identification checks - C







GROUND FLOOR

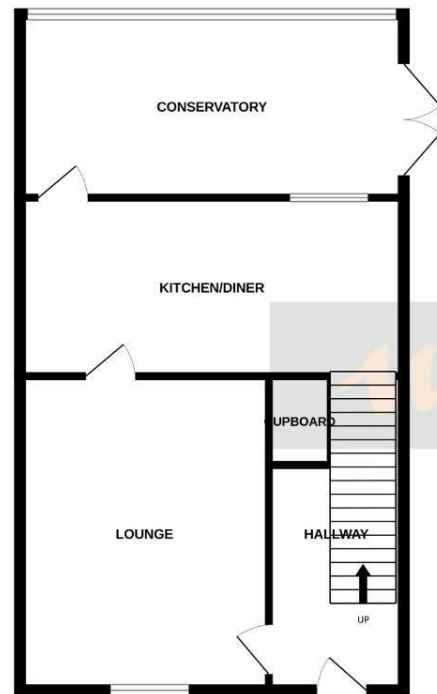

1ST FLOOR

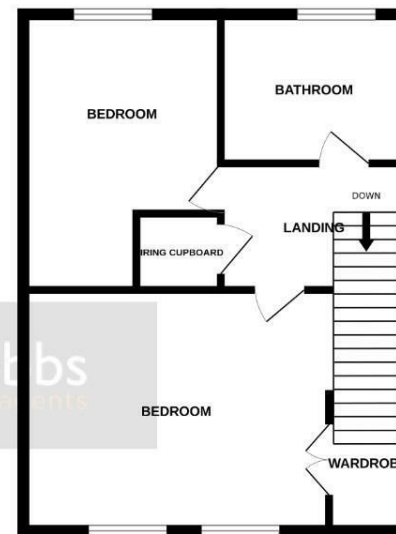

Whilst every attempt has been made to ensure the accuracy of the floorplan contained here, measurements of doors, windows, rooms and any other items are approximate and no responsibility is taken for any error, omission or mis-statement. This plan is for illustrative purposes only and should be used as such by any prospective purchaser. The services, systems and appliances shown have not been tested and no guarantee as to their operability or efficiency can be given.  
Made with Metropax G2025

Webbs Estate Agents - endeavour to maintain accurate depictions of properties in Virtual Tours, Floor Plans and descriptions, however, these are intended only as a guide and purchasers must satisfy themselves by personal inspection.

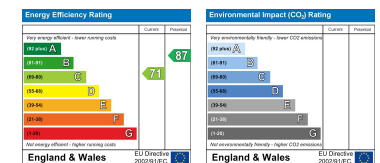

153 Avon Road, Cannock, WS11 1LF

Tel: 01543 468846 | Email: [sales@webbestateagents.co.uk](mailto:sales@webbestateagents.co.uk) | [www.webbestateagents.co.uk](http://www.webbestateagents.co.uk)