



School Lane | Shareshill, Wolverhampton | WV10 7LE
Offers Over £300,000



Summary

**** SOUGHT AFTER VILLAGE LOCATION ** EXTENDED FAMILY HOME ** DECEPTIVELY SPACIOUS ** VIEWING ADVISED ** THREE / FOUR BEDROOMS
** BATHROOM & ENSUITE ** LOUNGE DINER
** CONSERVATORY ** KITCHEN & UTILITY ROOM ** GARAGE & DRIVEWAY ** LANDSCAPED GARDEN ****

Webbs Estate Agents have pleasure in offering this extended and well-presented semi-detached family home, situated in a sought-after village location. Briefly comprising: porch, through hallway, lounge diner, conservatory, kitchen and utility room. On the first floor, the landing leads to three bedrooms, a family bathroom and stairs to the second floor. On the second floor, you will find a master suite comprising a generous bedroom, storage and ensuite shower room. Externally there is a fully enclosed landscaped rear garden, garage and driveway. VIEWING ADVISED!

Key Features

- EXTENDED FAMILY HOME
- VIEWING ADVISED
- BATHROOM & ENSUITE
- CONSERVATORY
- GARAGE & DRIVEWAY
- DECEPTIVELY SPACIOUS
- THREE / FOUR BEDROOMS
- LOUNGE DINER
- KITCHEN & UTILITY ROOM
- LANDSCAPED GARDEN

Rooms and Dimensions

ENTRANCE PORCH

THROUGH HALLWAY

LOUNGE DINER

22'11" x 11'0" (7.01m x 3.36m)

CONSERVATORY

8'11" x 9'6" (2.73m x 2.90m)

KITCHEN

10'0" x 7'11" (3.06m x 2.43m)

UTILITY ROOM

10'5" x 7'8" (3.19m x 2.35m)

FIRST FLOOR LANDING

BEDROOM TWO

11'1" x 10'10" (3.39m x 3.32m)

BEDROOM THREE

10'5" x 12'3" (3.20m x 3.75m)

STUDY

7'2" x 5'6" (2.19m x 1.68m)

FAMILY BATHROOM

7'3" x 5'10" (2.21m x 1.78m)

SECOND FLOOR

MASTER BEDROOM

13'11" x 10'8" (4.26m x 3.26m)

ENSUITE SHOWER ROOM

5'2" x 5'1" (1.58m x 1.55m)

LANDSCAPED REAR GARDEN

GARAGE

13'10" x 8'1" (4.22m x 2.47m)

PRIVATE DRIVEWAY

Identification checks - C

Premium Conveyancing





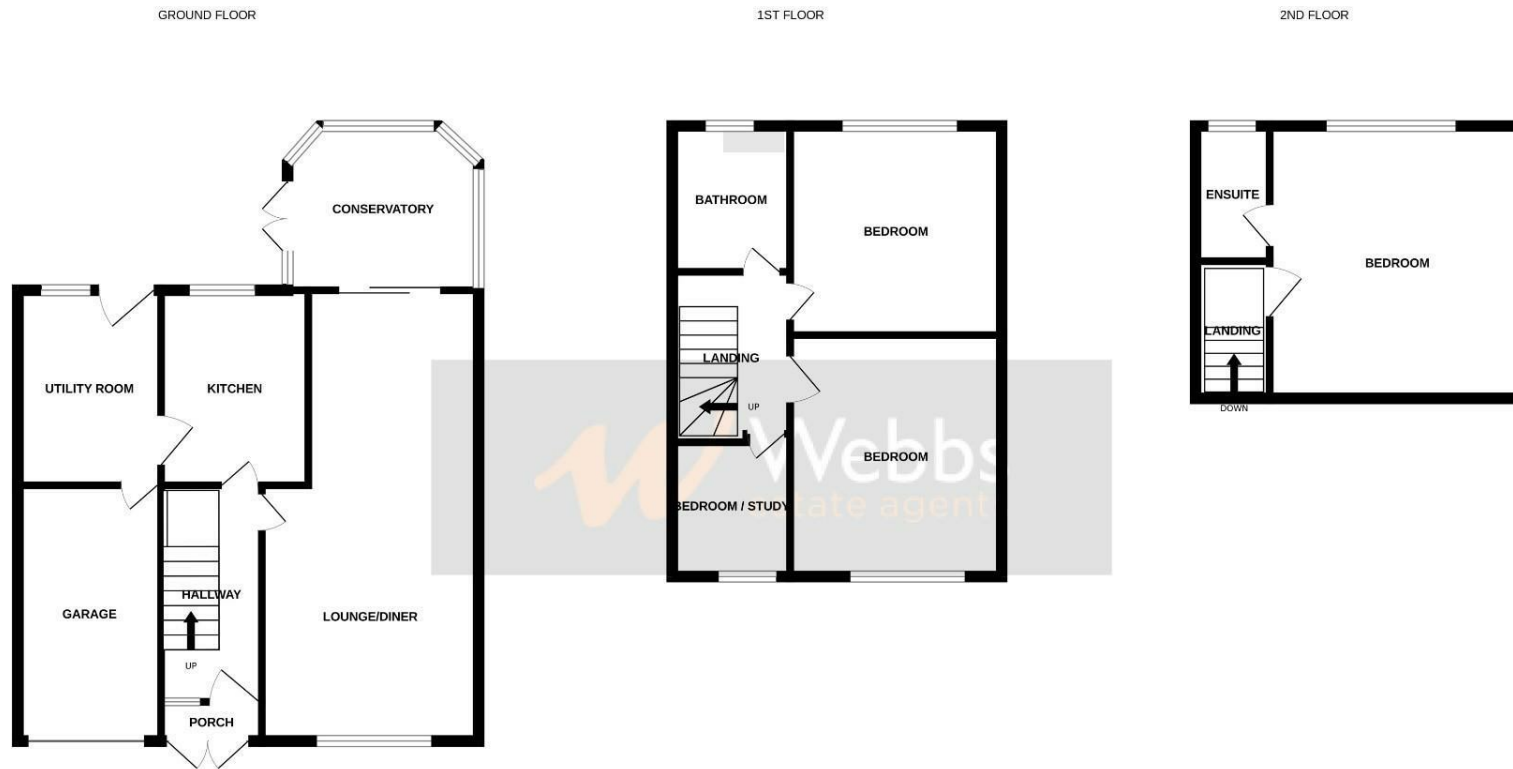

Whilst every attempt has been made to ensure the accuracy of the floorplan contained here, measurements of doors, windows, rooms and any other items are approximate and no responsibility is taken for any error, omission or mis-statement. This plan is for illustrative purposes only and should be used as such by any prospective purchaser. The services, systems and appliances shown have not been tested and no guarantee as to their operability or efficiency can be given.
Made with Metropix ©2025

Webbs Estate Agents - endeavour to maintain accurate depictions of properties in Virtual Tours, Floor Plans and descriptions, however, these are intended only as a guide and purchasers must satisfy themselves by personal inspection.

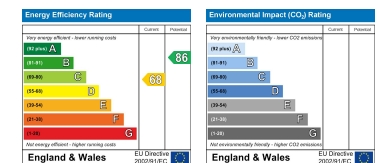

153 Avon Road, Cannock, WS11 1LF

Tel: 01543 468846 | Email: sales@webbestateagents.co.uk | www.webbestateagents.co.uk

