



Webbs

Helping people move since 1994

Hednesford Street | Cannock | WS11 1DJ

Offers Over £180,000



Summary

**** WOW ** DECEPTIVELY SPACIOUS TRADITIONAL TERRACED** BOASTING FOUR BEDROOMS ** MASTER ENSUITE ** FAMILY BATHROOM & GUEST WC ** UTILITY ROOM ** EXCELLENT FIRST TIME BUY ** WALKING DISTANCE OF CANNOCK TOWN ****

WEBBS ESTATE AGENTS ARE EXCITED TO OFFER THE OPPORTUNITY TO PURCHASE A UNIQUE 1900'S MID TERRACED located in Cannock close to the Town Centre. To the ground floor the property briefly comprises of a dining room, lounge, kitchen fully fitted with modern high gloss units, a separate utility room and a much-desired guest WC. The first floor has three bedrooms, a shared family bathroom and access to the second floor comprising of the master en-suite complete with ample storage and en-suite bathroom.

Externally benefiting from having an enclosed rear garden having paved, decking and gravel areas, floral borders and gated side access to the front.

Key Features

- TRADITIONAL 1900'S TERRACED HOUSE
- FOUR BEDROOMS
- FAMILY BATHROOM & GUEST WC
- UTILITY ROOM
- EXCELLENT FIRST TIME BUY
- DECEPTIVELY SPACIOUS THROUGHOUT
- EN-SUITE TO MAIN BEDROOM
- TWO RECEPTION ROOMS
- WALKING DISTANCE TO CANNOCK TOWN CENTRE
- CALL 01543 468846 TO VIEW

Rooms and Dimensions

DINING ROOM

12'4" x 11'6" (3.78 x 3.51)

LOUNGE

12'4" x 11'3" (3.78 x 3.45)

KITCHEN

8'9" x 6'2" (2.67 x 1.88)

GUEST WC

UTILITY ROOM

9'1" x 5'8" (2.77 x 1.73)

LANDING

BEDROOM TWO

11'6" x 9'3" (3.53 x 2.82)

BEDROOM THREE

8'7" x 7'4" (2.64 x 2.26)

BEDROOM FOUR

14'0" x 12'4" (4.29 x 3.78)

MASTER BEDROOM

14'4" x 10'4" (4.39 x 3.17)

EN-SUITE

ENLOSED REAR GARDEN

Identification checks - C

Legal Pack

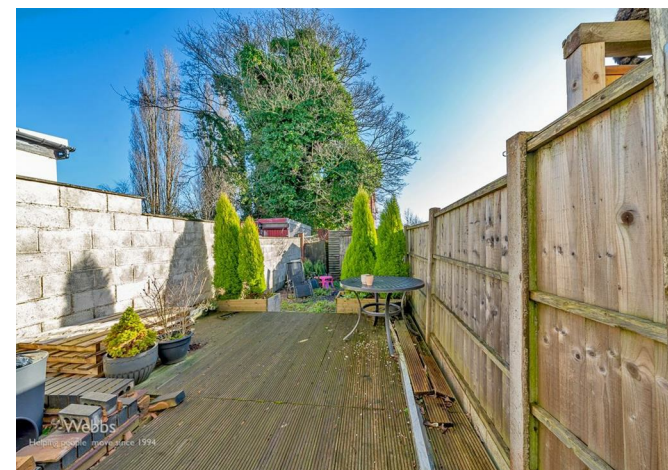



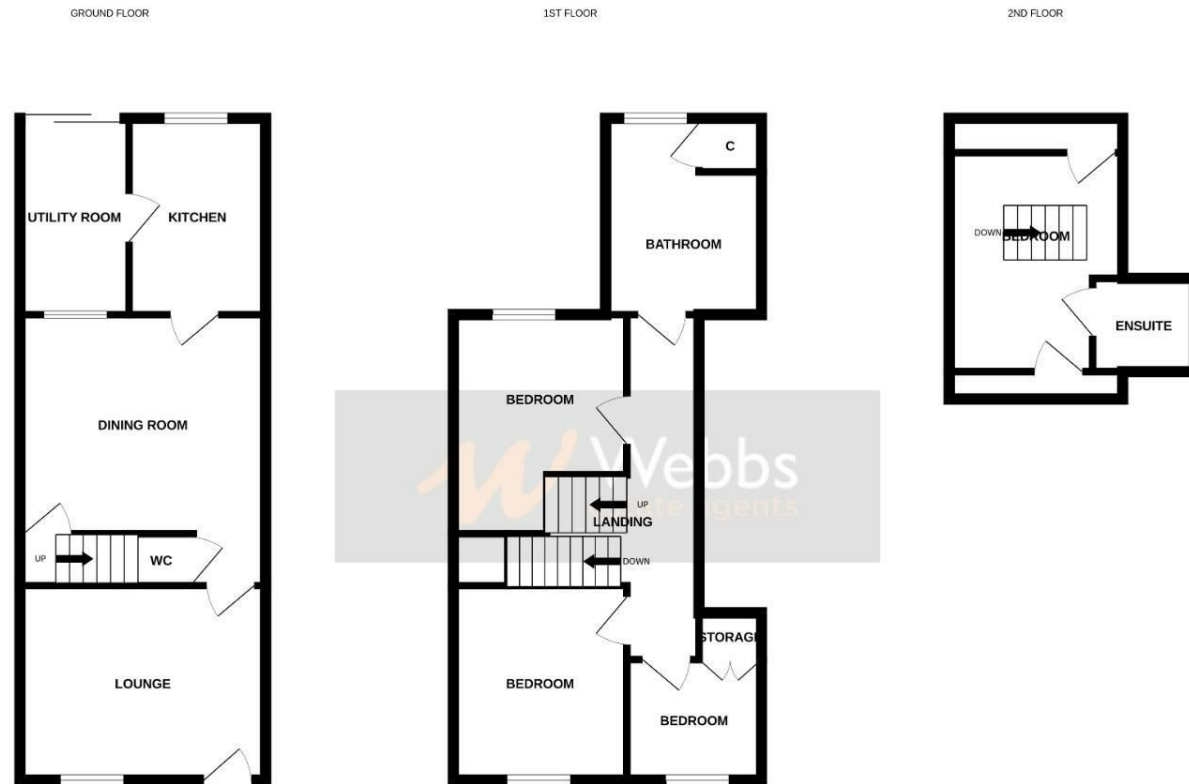

Whilst every attempt has been made to ensure the accuracy of the floorplan contained here, measurements of doors, windows, rooms and any other items are approximate and no responsibility is taken for any error, omission or mis-statement. This plan is for illustrative purposes only and should be used as such by any prospective purchaser. The services, systems and appliances shown have not been tested and no guarantee as to their operability or efficiency can be given.
Made with Metropix ©2025

Webbs Estate Agents - endeavour to maintain accurate depictions of properties in Virtual Tours, Floor Plans and descriptions, however, these are intended only as a guide and purchasers must satisfy themselves by personal inspection.

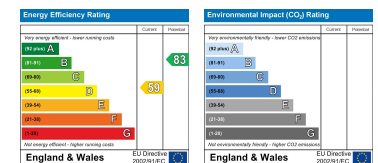

153 Avon Road, Cannock, WS11 1LF

Tel: 01543 468846 | Email: sales@webbestateagents.co.uk | www.webbestateagents.co.uk

Webbs
estate agents