



Webbs

Helping people move since 1994

**Walsall Road | Great Wyrley, Walsall | WS6 6NH**

**Offers Over £210,000**

 **Webbs**  
estate agents



## Summary

**\*\* WOW \*\* DECEPTIVELY SPACIOUS HOME \*\* POPULAR VILLAGE LOCATION \*\* INTERNAL VIEWING IS ESSENTIAL \*\* THREE BEDROOMS \*\* FAMILY BATHROOM \*\* CELLAR \*\* LOUNGE \*\* DINING ROOM \*\* STUNNING KITCHEN \*\* UTILITY ROOM \*\* 2 CAR REAR PARKING \*\* PRIVATE REAR GARDEN \*\***

Webbs Estate Agents have pleasure in offering this VERY WELL PRESENTED Victorian period spacious end-of-terraced family home, situated in the popular village location of Great Wyrley, being close to all local amenities, shops and schools. This beautiful home comprises: a lounge, dining room, kitchen and utility room. On the first floor, the landing leads to a family bathroom and three bedrooms. Externally there is a fore garden, private rear garden and 2 CAR PARKING TO REAR. INTERNAL VIEWING IS STRONGLY ADVISED !!

## Key Features

- END TERRACE HOME
- THREE BEDROOMS
- DINING ROOM
- KITCHEN & UTILITY AREA
- UPVC DG & GCH
- 2 CAR PARKING TO REAR
- VERY WELL PRESENTED
- LIVING ROOM
- FAMILY BATHROOM
- EARLY VIEWING ESSENTIAL

## Rooms and Dimensions

### AWAITING VENDOR APPROVAL

#### DINING ROOM

12'5" x 12'9" (3.80 x 3.89)

#### LIVING ROOM

12'0" x 12'5" (3.67 x 3.8)

#### KITCHEN

13'5" x 7'6" (4.10 x 2.3)

#### UTILITY ROOM

4'7" x 7'3" (1.4 x 2.23)

#### CELLAR

#### LANDING

#### BEDROOM ONE

12'5" x 11'1" (3.81 x 3.38)

#### BEDROOM TWO

9'5" x 6'3" (2.89 x 1.92)

#### BEDROOM THREE

14'2" x 7'7" (4.34 x 2.33)

#### BATHROOM

5'4" x 9'6" (1.64 x 2.91)

#### REAR GARDEN

#### REAR DRIVEWAY

#### Identification Checks







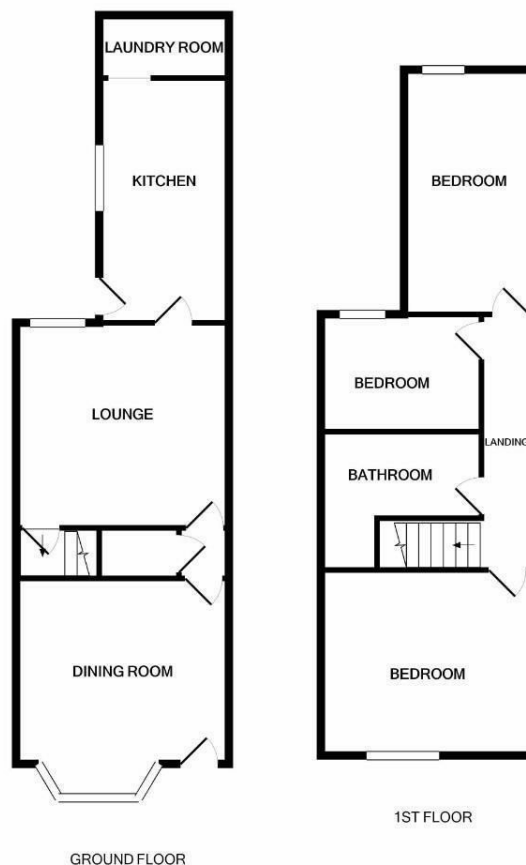

Whilst every attempt has been made to ensure the accuracy of the floor plan contained here, measurements of doors, windows, rooms and any other items are approximate and no responsibility is taken for any error, omission, or mis-statement. This plan is for illustrative purposes only and should be used as such by any prospective purchaser. The services, systems and appliances shown have not been tested and no guarantee as to their operability or efficiency can be given.  
Made with Metropix ©2021

Webbs Estate Agents - endeavour to maintain accurate depictions of properties in Virtual Tours, Floor Plans and descriptions, however, these are intended only as a guide and purchasers must satisfy themselves by personal inspection.

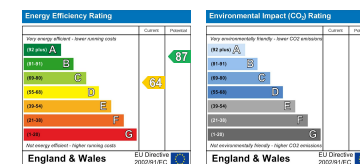

153 Avon Road, Cannock, WS11 1LF

Tel: 01543 468846 | Email: [sales@webbestateagents.co.uk](mailto:sales@webbestateagents.co.uk) | [www.webbestateagents.co.uk](http://www.webbestateagents.co.uk)