



Webbs

Helping people move since 1994

Walsall Road | Great Wyrley, Walsall | WS6 6AP

Offers Over £300,000

 **Webbs**
estate agents

Summary

**** WOW ** FABULOUS PLOT ** DETACHED BUNGALOW ** SOUGHT AFTER LOCATION ** TWO/THREE BEDROOMS ** FAMILY BATHROOM ** SPACIOUS ** KITCHEN DINER ** UTILITY ROOM ** GENEROUS DRIVEWAY & FRONT GARDEN ** PRIVATE REAR GARDEN ** WELL PRESENTED ** INTERNAL INSPECTION ESSENTIAL ****

Webb's Estate Agents have pleasure in offering this deceptively spacious detached bungalow set back from the road, situated in the sought-after location of Great Wyrley and being close to all local amenities, excellent transport links and school catchments.

Briefly comprises; through hallway, spacious lounge, kitchen diner, utility room, three bedrooms and family bathroom.

Externally benefiting from a private driveway providing ample off-road parking, front and rear gardens, VIEWING ADVISED TO FULLY APPRECIATE THE SIZE AND LOCATION OF THE PROPERTY ON OFFER.

Key Features

- DETACHED BUNGALOW
- INTERNAL VIEWING IS ESSENTIAL
- SPACIOUS LOUNGE DINER
- GENEROUS FRONT GARDEN
- REAR GARDEN
- POPULAR LOCATION
- THREE BEDROOMS
- KITCHEN DINER & UTILITY
- PRIVATE DRIVEWAY

Rooms and Dimensions

ENTRANCE PORCH

THROUGH HALLWAY

SPACIOUS LOUNGE

16'8" x 10'3" (5.09m x 3.13m)

KITCHEN DINER

11'5" x 11'1" (3.50m x 3.39m)

UTILITY ROOM

7'1" x 6'11" (2.18m x 2.13m)

BEDROOM ONE

10'3" x 9'1" (3.14m x 2.79m)

BEDROOM TWO / DINING ROOM

16'7" x 10'9" (5.08m x 3.29m)

BEDROOM THREE

10'4" x 7'7" (3.15m x 2.33m)

FAMILY BATHROOM

GENEROUS FRONT GARDEN

DRIVEWAY

REAR GARDEN

Identification checks - C





GROUND FLOOR

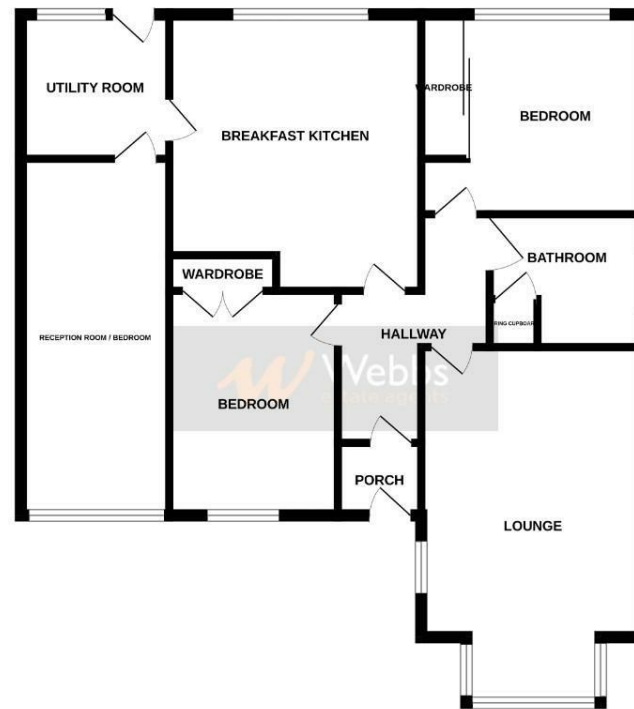

Whilst every attempt has been made to ensure the accuracy of the floorplan contained herein, measurements of doors, windows, rooms and any other items are approximate and no responsibility is taken for any error, omission or misstatement. This plan is for illustrative purposes only and should be used as such by the prospective purchaser. The services, systems and appliances shown have not been tested and no guarantee as to their operability or efficiency can be given.
 Made with AutoCAD ©2024

Webbs Estate Agents - endeavour to maintain accurate depictions of properties in Virtual Tours, Floor Plans and descriptions, however, these are intended only as a guide and purchasers must satisfy themselves by personal inspection.

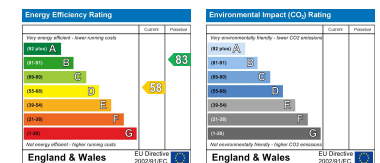

153 Avon Road, Cannock, WS11 1LF

Tel: 01543 468846 | Email: sales@webbestateagents.co.uk | www.webbestateagents.co.uk

