



Webbs

Helping people move since 1994

Littleworth Road | Wimblebury, Cannock | WS12 1HY

Offers In Excess Of £240,000

 **Webbs**
estate agents

Summary

**** SOUGHT AFTER AND POPULAR RESIDENTIAL LOCATION** MODERN SEMI DETACHED HOUSE ** MAINTAINED AND IMPROVED TO A VERY GOOD STANDARD THROUGHOUT ** DECEPTIVELY SPACIOUS ** INTERNAL VIEWING ADVISED ** THREE GOOD SIZED BEDROOMS ** MODERN BATHROOM AND EN SUITE ** GUEST WC ** SPACIOUS MAIN LIVING ROOM ** MODERN OPEN PLAN KITCHEN/DINING ROOM ** PARKING FOR 2 CARS ** PRIVATE REAR GARDEN ** UPVC DOUBLE GLAZING ** GAS CENTRAL HEATING ****

Webbs Estate Agents have pleasure in offering this impressive and very well maintained modern semi detached home, situated on a desirable residential location being close to all local amenities, shops and schools. Briefly comprising on the ground floor : Reception hallway , guest WC, living room, modern open plan fitted kitchen/dining room. The first floor landing leads to three good sized bedrooms(master with modern en suite) and modern family bathroom with WC. Externally the rear garden is private and enclosed with parking for two cars to the rear. For a viewing please call 01543 468846.

Key Features

- IMPRESSIVE MODERN SEMI DETACHED HOME
- POPULAR AND CONVENIENT LOCATION
- MODERN EN SUITE, GUEST WC AND FAMILY BATHROOM
- STUNNING MODERN OPEN PLAN KITCHEN DINING ROOM
- TWO CAR PARKING TO REAR
- VERY WELL MAINTAINED THROUGHOUT
- THREE GOOD SIZED BEDROOMS
- SPACIOUS MAIN LIVING ROOM
- PRIVATE AND ENCLOSED REAR GARDEN
- IDEAL FIRST TIME BUYER HOME

Rooms and Dimensions

Entrance hallway

Guest WC

Open plan Kitchen dining room

17'8" x 12'11" max 8'3" min (5.40m x 3.96m max 2.53m min)

Living room

16'2" x 10'9" (4.94m x 3.30m)

First floor landing

Bedroom one

12'1" x 9'2" (3.69m x 2.81m)

En suite

9'2" x 4'6" (2.81m x 1.39m)

Bedroom two

11'5" x 8'9" (3.50m x 2.68m)

Bedroom three

8'6" x 6'6" (2.60m x 2.00m)

Family bathroom

7'3" x 5'6" (2.21m x 1.68m)

Private and enclosed landscaped rear garden

Two parkings bay to rear

Identification checks - C





GROUND FLOOR

1ST FLOOR

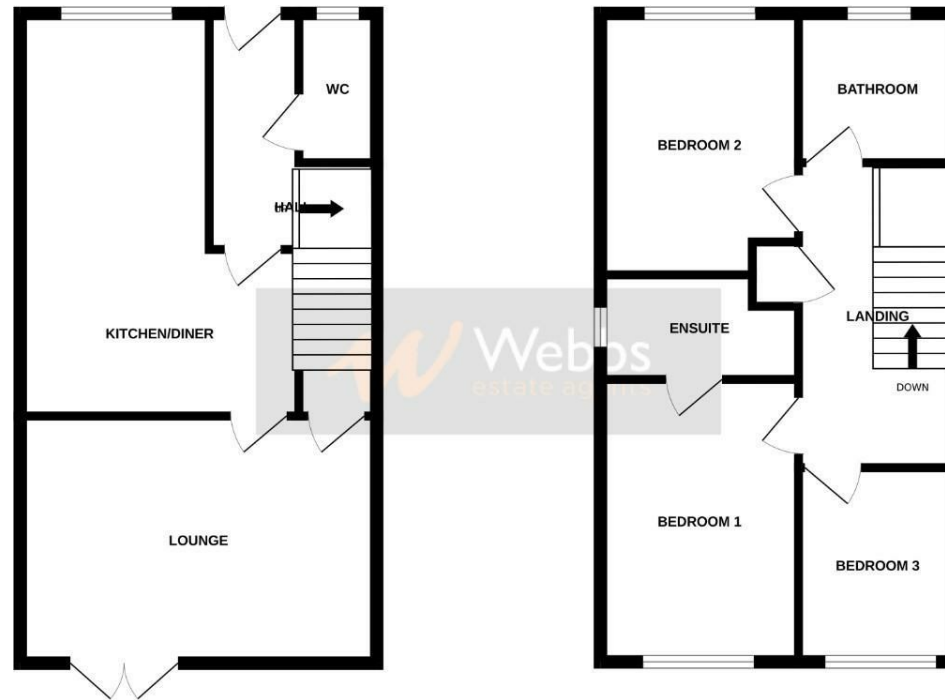

Whilst every attempt has been made to ensure the accuracy of the floorplan contained here, measurements of doors, windows, rooms and any other items are approximate and no responsibility is taken for any error, omission or mis-statement. This plan is for illustrative purposes only and should be used as such by any prospective purchaser. The services, systems and appliances shown have not been tested and no guarantee as to their operability or efficiency can be given.
Made with Metropix ©2024

Webbs Estate Agents - endeavour to maintain accurate depictions of properties in Virtual Tours, Floor Plans and descriptions, however, these are intended only as a guide and purchasers must satisfy themselves by personal inspection.

