



Miners Way | Hednesford, Cannock | WS12 4WL

Offers Over £230,000

 **Webbs**
estate agents

Summary

****WOW ** OUTSTANDING VIEWS ** SOUGHT AFTER LOCATION ** THREE BEDROOMS ** EN-SUITE TO MASTER BEDROOM ** SPACIOUS LOUNGE ** MODERN KITCHEN DINER ** SET OVER THREE FLOORS ** CLOSE TO CANNOCK CHASE ** IDEAL FOR TOWN CENTRE AND TRAIN STATION ** EARLY VIEWING STRONGLY RECOMMENDED ****

Webbs Estate Agents are pleased to offer for sale a very well presented and spacious home in the popular location of Hednesford offering easy access to Cannock Chase, Hednesford Town Centre and Train Station. In brief consisting: of entrance hallway, a spacious lounge which has open views to the front, an inner hall, a utility cupboard (plumbing for guest WC) and a modern kitchen diner with integrated appliances. To the second floor there are two bedrooms and family bathroom, to the second floor the master bedroom and en-suite complete the living accommodation, externally the enclosed rear garden is mainly laid to lawn and off road parking is provided by a driveway to the front, early viewing is advised.

Key Features

- FABULOUS POSITION
- SPACIOUS FAMILY HOME
- THREE DOUBLE BEDROOMS
- SPACIOUS LOUNGE
- UTILITY CUPBOARD WITH PLUMBING FOR WC
- OVER LOOKING OPEN FIELDS
- REMAINDER OF BUILDERS WARRANTY
- BATHROOM & ENSUITE
- KITCHEN DINER
- GARDENS & DRIVEWAY

Rooms and Dimensions

ENTRANCE HALLWAY

SPACIOUS LOUNGE

14'8" x 11'9" (4.48m x 3.60m)

UTILITY CUPBOARD WITH PLUMBING FOR WC

KITCHEN DINER

11'9" x 7'8" (3.60m x 2.35m)

LANDING

BEDROOM TWO

11'9" x 8'9" (3.60m x 2.69m)

BEDROOM THREE

11'10" x 9'1" (3.61m x 2.77m)

FAMILY BATHROOM

7'11" x 5'6" (2.43m x 1.69m)

SECOND FLOOR LANDING

MASTER BEDROOM

17'1" x 8'5" (5.23m x 2.58m)

ENSUITE SHOWER ROOM

11'1" x 5'0" (3.39m x 1.53m)

REAR GARDEN

PRIVATE DRIVEWAY





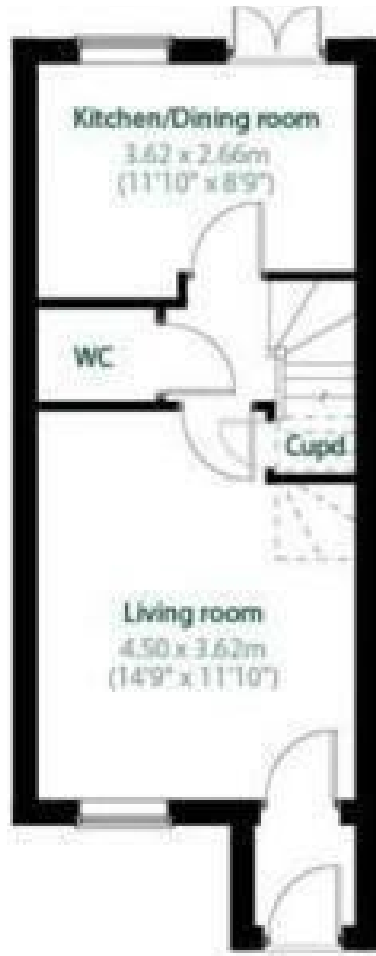

Webbs Estate Agents - endeavour to maintain accurate depictions of properties in Virtual Tours, Floor Plans and descriptions, however, these are intended only as a guide and purchasers must satisfy themselves by personal inspection.

