



Brooklands Avenue | Walsall | WS6 6LG

£750 PCM

 **Webbs**
estate agents

Summary

Webbs Estate Agents have pleasure in offering this very well presented first floor flat, situated in a popular location, being close to all local amenities.

Briefly comprising of, lounge, kitchen, two bedrooms and bathroom, with off road parking to rear.

Unfortunately, pets and smokers are not considered.

Key Features

- First Floor Flat
- Close to Amenities
- Kitchen
- Bathroom
- Popular Location
- Lounge
- Two Bedrooms
- Off Road Parking

Rooms and Dimensions

PROPERTY DETAILS:





4a Brooklands Avenue

Approx. 44.1 sq. metres (475.0 sq. feet)

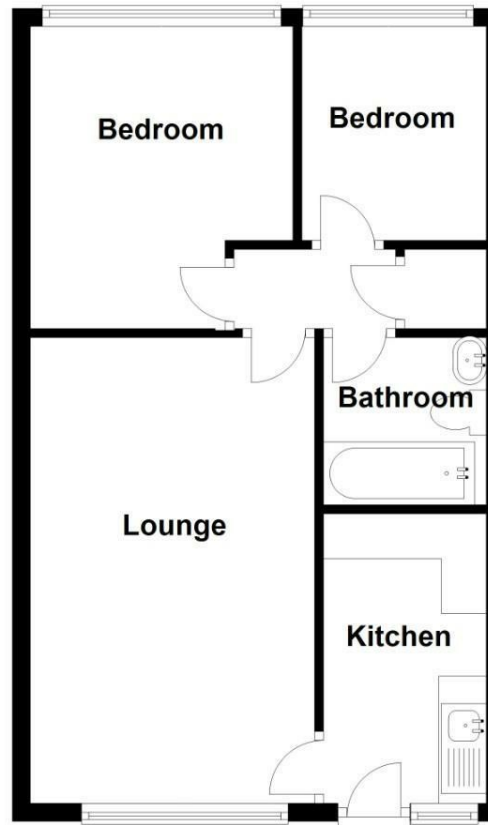

Total area: approx. 44.1 sq. metres (475.0 sq. feet)

Webbs Estate Agents - endeavour to maintain accurate depictions of properties in Virtual Tours, Floor Plans and descriptions, however, these are intended only as a guide and purchasers must satisfy themselves by personal inspection.

