



Webbs

Helping people move since 1994

**Lower Road | Hednesford, Cannock | WS12 1NB**

**Offers In The Region Of £395,000**

 **Webbs**  
estate agents

## Summary

**\*\* SIMPLY STUNNING \*\* DETACHED BUNGALOW \*\* THREE BEDROOMS \*\* HIGHLY SOUGHT AFTER LOCATION \*\* GENEROUS PLOT \*\* POTENTIAL TO EXTEND \*\* NEW ROOF \*\* WELL MAINTAINED \*\* ORANGERY \*\* DETACHED GARAGE \*\* VIEWING STRONGLY ADVISED TO AVOID DISAPPOINTMENT \*\***

Webbs Estate Agents have pleasure in offering this very well presented, deceptively spacious detached bungalow, situated in a sought after location, being close to all local amenities, shops and schools. Briefly comprising: through hallway, lounge, dining room, two/three bedrooms, family shower room, extended galley kitchen and orangery. Externally this lovely home sits on a large plot providing not only a large rear garden but ample parking for a number of vehicles and detached garage, viewing is the only way to fully appreciate this stunning property

## Key Features

- SPACIOUS BUNGALOW
- VIEWING ADVISED
- TWO RECEPTION ROOMS
- REFITTED SHOWER ROOM
- DETACHED GARAGE
- POPULAR LOCATION
- THREE BEDROOMS
- GALLERY KITCHEN
- STUNNING GARDENS
- GENEROUS DRIVEWAY

## Rooms and Dimensions

### AWAITING VENDOR APPROVAL

### THROUGH HALLWAY

### LOUNGE / BEDROOM

13'3" x 11'6" (4.06m x 3.51m)

### SITTING ROOM / BEDROOM

13'10" x 12'8" (4.23m x 3.88m)

### DINING ROOM

11'9" x 11'8" (3.60m x 3.56m)

### GALLEY KITCHEN

24'0" x 4'4" (7.33m x 1.33m)

### ORANGERY

11'2" x 10'6" (3.42m x 3.22m)

### MASTER BEDROOM

11'6" x 10'9" (3.53m x 3.28m)

### SHOWER ROOM

8'3" x 5'6" (2.54m x 1.69m)

### DETACHED GARAGE

20'1" x 11'0" (6.13m x 3.36m)

### GENEROUS LANDSCAPED GARDENS

### Material Information WH





GROUND FLOOR

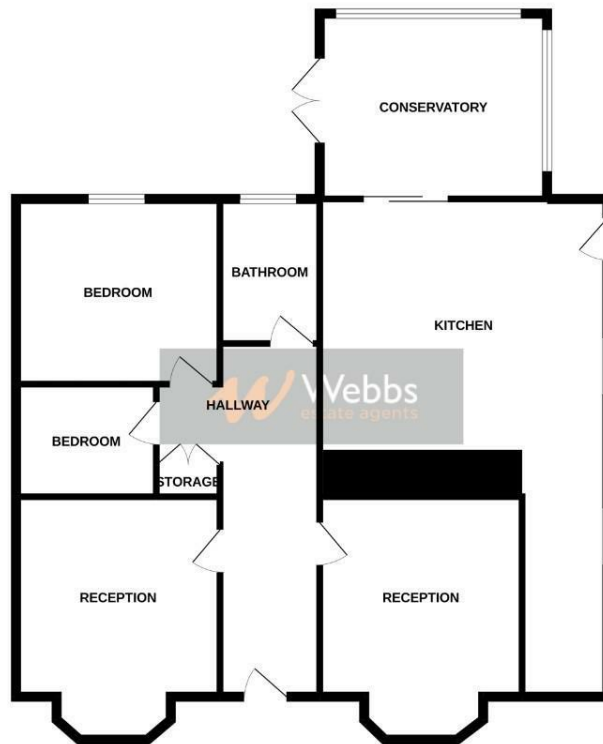

Whilst every attempt has been made to ensure the accuracy of the floorplan contained here, measurements of doors, windows, rooms and any other items are approximate and no responsibility is taken for any errors, omissions or mis-statement. This plan is for illustrative purposes only and should be used as such by any prospective purchaser. The services, systems and appliances shown have not been tested and no guarantee as to their operability or efficiency can be given.  
Made with Metronix ©2022

Webbs Estate Agents - endeavour to maintain accurate depictions of properties in Virtual Tours, Floor Plans and descriptions, however, these are intended only as a guide and purchasers must satisfy themselves by personal inspection.

