

BRITISH
PROPERTY
AWARDS

2023 - 2024



GOLD WINNER

LETTING AGENT
IN CANNOCK



Brownhills Road | Walsall | WS8 7BS

£895 PCM



Summary

Webbs Estate Agents are excited to present this deceptively spacious and beautifully presented traditional semi-detached house for rent. Located in a popular residential area, it is conveniently close to amenities, shops, and schools.

This charming property features a lounge, dining room, kitchen, bathroom, two double bedrooms, and ample storage space.

Externally, there is an enclosed garden at the rear.

Additional benefits include gas central heating and double glazing.

Key Features

- Traditional Semi Detached House
- Dining Room
- Bathroom
- Garden to Rear
- Double Glazing
- Lounge
- Kitchen
- Two Double Bedrooms
- Gas Central Heating
- Viewing Essential

Rooms and Dimensions

PROPERTY DETAILS:

First Reception Room (front)

10'8" (10'0" min) x 11'7" (3.254 (3.067 min) x 3.545)

Second Reception Room (back)

10'9" (10'11" min) x 11'7" (3.284 (3.33 min) x 3.554)

Kitchen

8'6" x 8'2" (2.599 x 2.504)

Bathroom

8'2" x 4'6" (2.494 x 1.391)

Bedroom One (front)

10'9" (7'10" to wardrobe) x 11'8" (3.282 (2.413 to wardrobe) x 3.568)

Bedroom Two (rear)

9'11" (7'5" min) x 11'7" (3.036 (2.281 min) x 3.544)





Brownhills Road
Walsall Wood

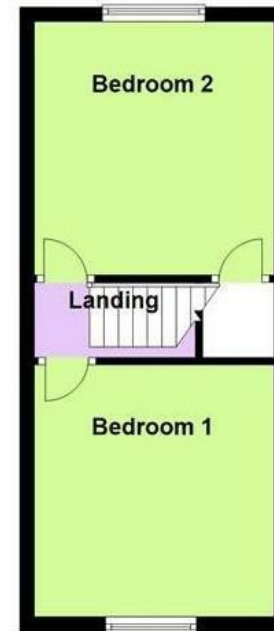
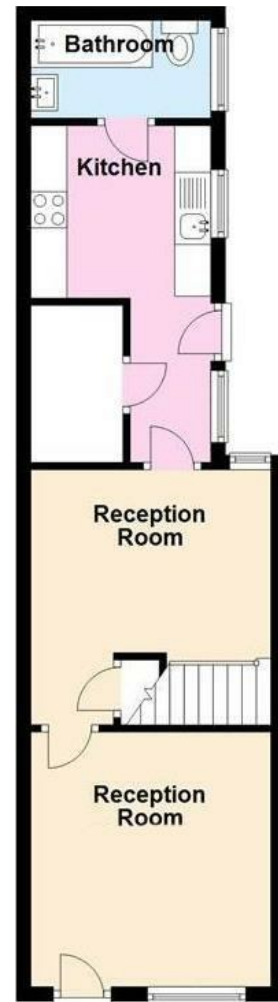

Webbs Estate Agents - endeavour to maintain accurate depictions of properties in Virtual Tours, Floor Plans and descriptions, however, these are intended only as a guide and purchasers must satisfy themselves by personal inspection.

Energy Efficiency Rating		Environmental Impact (CO ₂) Rating	
Current	Potential	Current	Potential
<p>Key Average Rating - lower energy costs</p> <p>100-120 A</p> <p>85-100 B</p> <p>70-85 C</p> <p>55-70 D</p> <p>40-55 E</p> <p>25-40 F</p> <p>10-25 G</p>	<p>84</p>	<p>Key Environmental Impact - lower CO₂ emissions</p> <p>100-120 A</p> <p>85-100 B</p> <p>70-85 C</p> <p>55-70 D</p> <p>40-55 E</p> <p>25-40 F</p> <p>10-25 G</p>	<p>69</p>
<p>EU Directive 2002/91/EC</p> <p>England & Wales</p>		<p>EU Directive 2002/91/EC</p> <p>England & Wales</p>	