



**Tower View Road | Great Wyrley, Walsall | WS6 6HE**  
**Offers Over £240,000**





## Summary

**\*\* NO CHAIN \*\* FABULOUS GENEROUS CORNER PLOT \*\* FULL PLANNING FOR DOUBLE STOREY EXTENSION TO SIDE \*\* OUTSTANDING POTENTIAL \*\* POPULAR LOCATION \*\* VIEWING ADVISED \*\* THREE BEDROOMS \*\* TWO BATHROOMS \*\* LOUNGE DINER\*\* KITCHEN \*\* GARAGE \*\* PRIVATE DRIVEWAY \*\* GENEROUS GARDENS TO SIDE, FRONT & REAR \*\***

Webbs Estate Agents have pleasure in offering this deceptively spacious family home, set on a generous plot in a popular location being close to all local amenities, shops and schools. Benefitting from full planning for a two-storey extension to the side. Briefly comprising: hallway, kitchen, lounge diner, family bathroom and bedroom to ground floor. On the first floor, the landing leads to two double bedrooms and a STUNNING refitted family bathroom. Externally there is a private driveway, garage, and generous gardens to the side, front & rear. Offered with NO CHAIN

## Key Features

- SPACIOUS SEMI DETACHED
- OUTSTANDING POTENTIAL
- VIEWING ADVISED
- GENEROUS PLOT
- NO CHAIN
- PLANNING CONSENT FOR TWO STOREY EXTENSION
- REFITTED FAMILY BATHROOM
- POPULAR LOCATION

## Rooms and Dimensions

### ENTRANCE HALL

### KITCHEN

8'7" x 8'1" (2.62m x 2.46m)

### LOUNGE/DINING ROOM

30'9" max x 10'3" (9.37m max x 3.12m)

### BEDROOM THREE

29'6" x 36'1" x 26'2" x 22'11" (9'11" x 8'7")

### GROUND FLOOR BATHROOM

7'5" x 3'5" (2.26m x 1.04m)

### LANDING

### BEDROOM ONE

### BEDROOM TWO

### REFITTED BATHROOM

### Identification checks - C







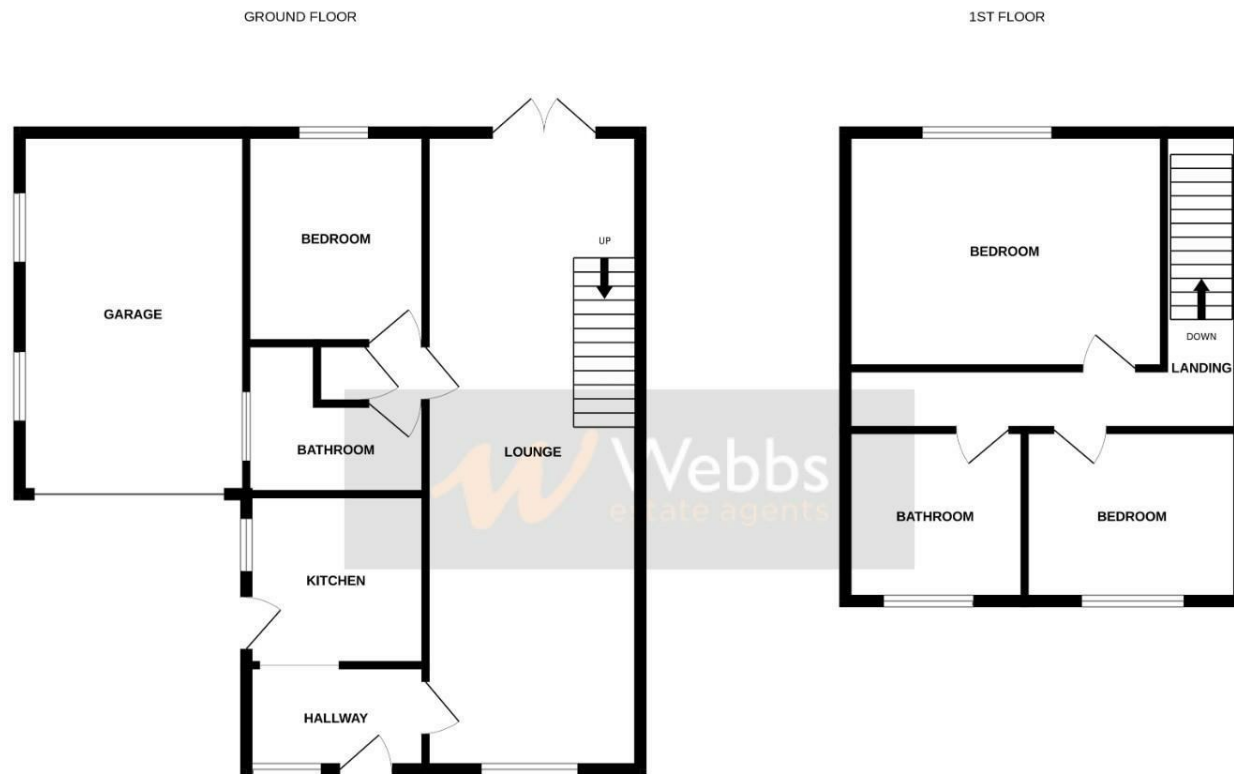

Whilst every attempt has been made to ensure the accuracy of the floorplan contained here, measurements of doors, windows, rooms and any other items are approximate and no responsibility is taken for any error, omission or mis-statement. This plan is for illustrative purposes only and should be used as such by any prospective purchaser. The services, systems and appliances shown have not been tested and no guarantee as to their operability or efficiency can be given.  
Made with Metropix ©2024

Webbs Estate Agents - endeavour to maintain accurate depictions of properties in Virtual Tours, Floor Plans and descriptions, however, these are intended only as a guide and purchasers must satisfy themselves by personal inspection.

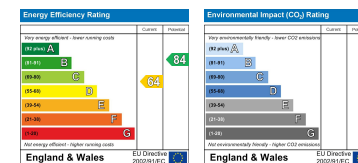

153 Avon Road, Cannock, WS11 1LF

Tel: 01543 468846 | Email: [sales@webbestateagents.co.uk](mailto:sales@webbestateagents.co.uk) | [www.webbestateagents.co.uk](http://www.webbestateagents.co.uk)

**Webbs**  
estate agents