



New Plant Lane | Chase Terrace, Burntwood | WS7 1JQ

Offers Over £240,000



Summary

** MODERN SEMI DETACHED HOME ** THREE BEDROOMS ** EN-SUITE TO MASTER ** SPACIOUS LOUNGE ** CONSERVATORY ** MODERN BREAKFAST KITCHEN ** GARAGE AND DRIVEWAY ** ENCLOSED GARDEN ** EXCELLENT TRANSPORT LINKS ** CLOSE TO LOCAL SHOPS AND AMENITIES ** VIEWING STRONGLY ADVISED **

Webbs Estate Agents are pleased to offer for sale a well-presented and spacious modern semi-detached home, offering excellent transport links, close to Chasewater Country Park, local shops and amenities.

In brief consisting of an entrance hallway, guest WC, a modern breakfast kitchen with ample wall and floor units, a spacious lounge with patio doors to the conservatory.

To the first floor there are three bedrooms, family bathroom and an en-suite shower room to the master bedroom, externally the enclosed low-maintenance rear garden has patio seating area, ample off road parking is provided by single garage and driveway, VIEWING ESSENTIAL

Key Features

- MODERN SEMI DETACHED HOME
- THREE BEDROOMS
- CONSERVATORY
- EN-SUITE TO MASTER BEDROOM
- GARAGE AND DRIVEWAY
- EXCELLENT TRANSPORT LINKS
- SPACIOUS LOUNGE
- MODERN BREAKFAST KITCHEN
- ENCLOSED GARDEN
- IDEAL FOR CHASEWATER COUNTRY PARK

Rooms and Dimensions

ENTRANCE HALLWAY

GUEST WC

MODERN BREAKFAST KITCHEN

11'1" x 9'3" (3.40m x 2.82m)

SPACIOUS LOUNGE

14'7" x 13'6" (4.47m x 4.14m)

CONSERVATORY

9'1" x 8'7" (2.77m x 2.62m)

LANDING

BEDROOM ONE

12'2" x 11'3" (3.73m x 3.45m)

EN-SUITE SHOWER ROOM

BEDROOM TWO

9'1" x 7'4" (2.79m x 2.26m)

BEDROOM THREE

8'2" x 7'1" (2.49m x 2.16m)

FAMILY BATHROOM

ENCLOSED GARDEN

SINGLE GARAGE AND DRIVEWAY

19'1" x 9'3" (5.84m x 2.82m)







Ground Floor

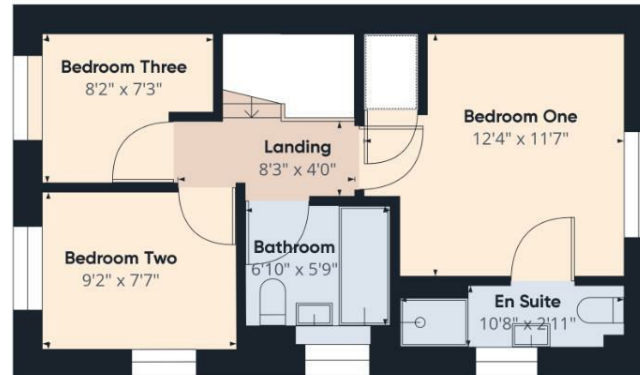

Floor 1



Approximate total area[®]
833.65 ft²

(1) Excluding balconies and terraces

While every attempt has been made to ensure accuracy, all measurements are approximate, not to scale. This floor plan is for illustrative purposes only.

GIRAFFE 360

Webbs Estate Agents - endeavour to maintain accurate depictions of properties in Virtual Tours, Floor Plans and descriptions, however, these are intended only as a guide and purchasers must satisfy themselves by personal inspection.

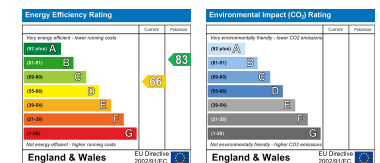

153 Avon Road, Cannock, WS11 1LF

Tel: 01543 468846 | Email: sales@webbestateagents.co.uk | www.webbestateagents.co.uk

