

## 27 WAVERLEY ROAD, EN2 7DF



**£1,800**

- FIRST FLOOR
- LARGE LOUNGE
- 3 BEDROOMS
- CLOAKROOM
- PARKING
- UNFURNISHED
- KITCHEN
- BATHROOM
- GARAGE

# Barrydene Court, Enfield, EN2

APPROX GROSS INTERNAL FLOOR AREA: 854 sq. ft / 79 sq. m

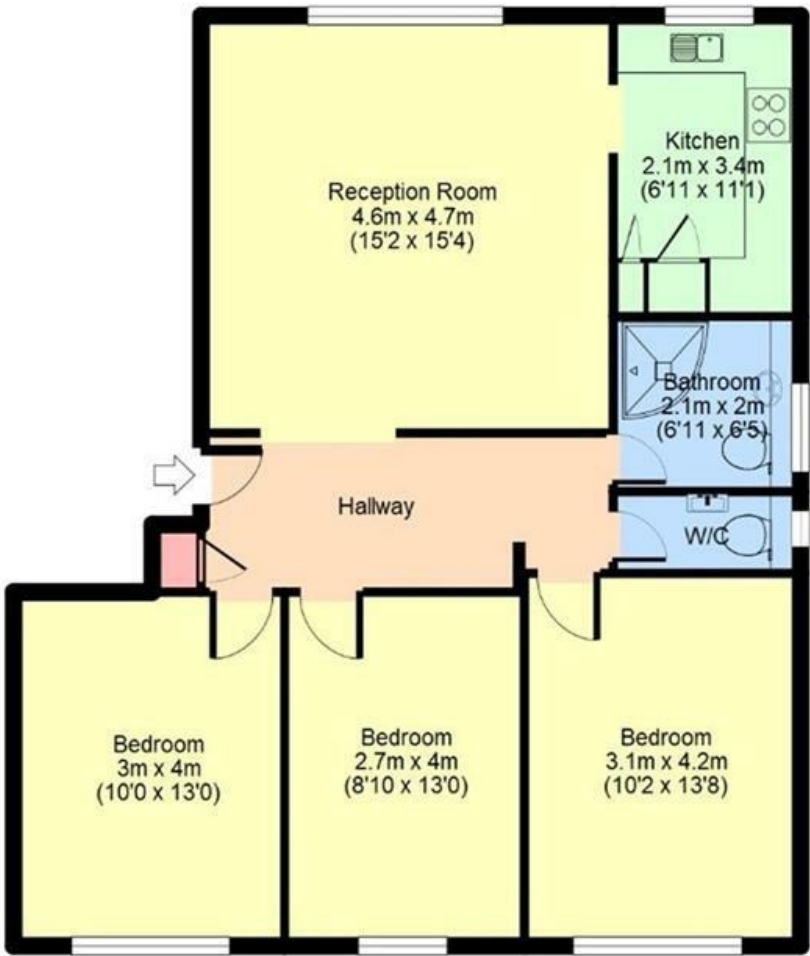

For identification purposes only  
Measurements are approx and not to scale

Energy Efficiency Rating		
	Current	Potential
Very energy efficient - lower running costs		
(92 plus) A		
(81-91) B		
(69-80) C	76	80
(55-68) D		
(39-54) E		
(21-38) F		
(1-20) G		
Not energy efficient - higher running costs		
England & Wales	EU Directive 2002/91/EC	