



ROYAL DRIVE, N11 3FR



£360,000 Leasehold

- SET WITHIN ACRES OF GROUNDS
- 24 HOUR SECURITY/COURTESY BUS
- KITCHEN
- TWO BATHROOMS
- CHAIN FREE
- VICTORIAN BUILDING
- LOUNGE
- TWO BEDROOMS
- TENNIS COURT/GYM ON SITE

Property Details

Princess Mark Manor is set in acres of ground and boasts beautiful Victorian buildings that have been meticulously preserved to keep the historic architecture, restoring the grand Victorian façade, the ornate interior details like high ceilings and large windows, and integrating these with modern luxury features. This two-bedroom, two-bathroom flat located boasts a spacious living area with high ceilings and large windows that flood the space with natural light. The open-plan kitchen is fully equipped, perfect for modern lifestyles. The master bedroom features an en-suite bathroom, adding an extra layer of privacy and luxury. Residents benefit from secure parking, access to a state-of-the-art gym and swimming pool, and beautifully landscaped gardens. The 24-hour security service ensures peace of mind in this serene setting. Princess Park Manor is ideally situated near New Southgate and Arnos Grove stations, providing easy access to central London. The local area is rich with amenities, including shops, parks, and schools, making it an ideal choice for those seeking convenience and quality in one package. Viewings are by appointment only, offering a unique opportunity to own a piece of history infused with modern luxury. Contact our sales team today to schedule a visit.

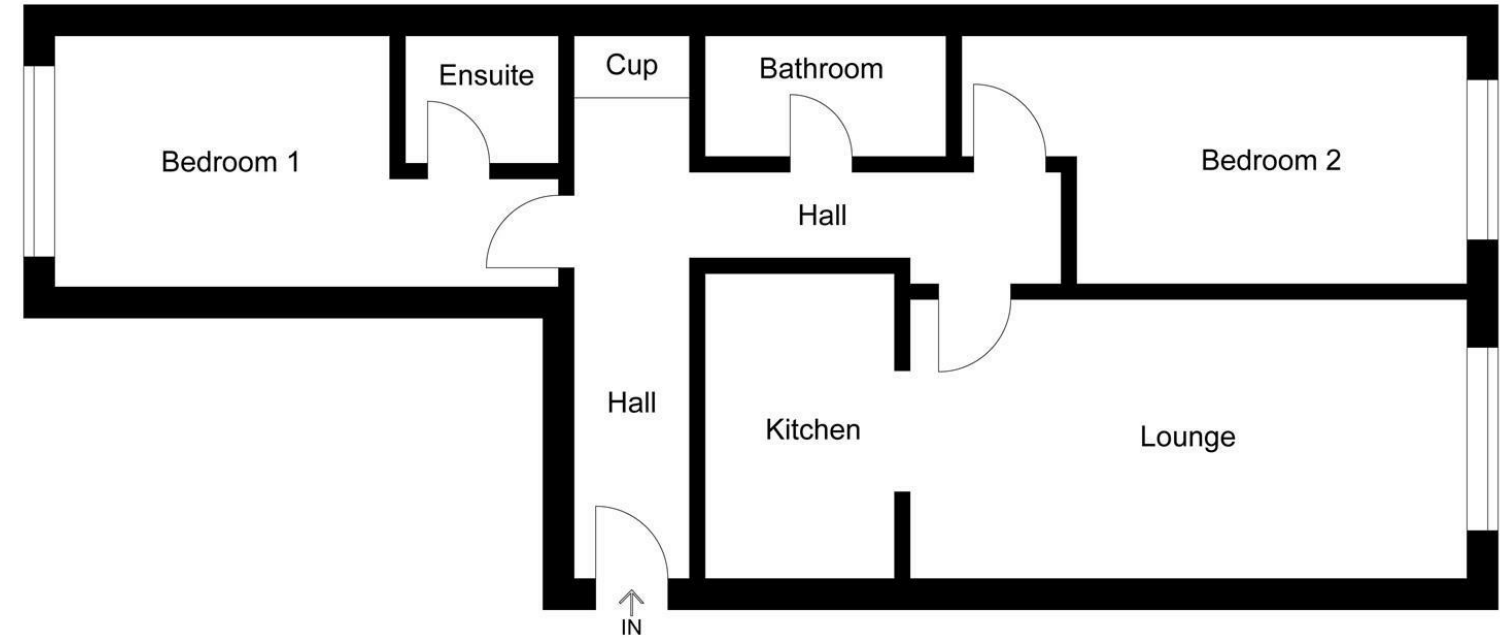

Illustration for identification purposes only, measurements are approximate, not to scale.

Energy Efficiency Rating		Current	Potential
Very energy efficient - lower running costs			
(92 plus) A			
(81-91) B		81	81
(69-80) C			
(55-68) D			
(39-54) E			
(21-38) F			
(1-20) G			
Not energy efficient - higher running costs			
England & Wales		EU Directive 2002/91/EC	

