

NEWSHOLME DRIVE, N21 1SQ



£350,000 Freehold

- FIRST FLOOR
- KITCHEN
- VIEWS OVER COMMUNAL GARDENS
- LIFT TO ALL FLOORS
- GATED COMMUNITY
- 2 BEDROOMS
- BATHROOM
- CHAIN FREE
- COMMUNAL RESIDENTS LOUNGE
- 24 HOUR OFFICE ONSITE

Property Details

A first floor two Bedroomed flat in a prestigious serviced retirement complex. This is a spacious, bright and airy apartment occupying a desirable position in the development. The accommodation comprises entrance hall, spacious living room, newly decorated kitchen with a new work surface, new oven, hob and extractor fan, as well as an integrated fridge/ freezer and a washing machine, master bedroom with walk-in wardrobe, a second double bedroom, a stunning newly refurbished bathroom with shower area and, plus a sizable walk-in storeroom.

The office is manned 24 hours, there is a weekly service clean included, a residents' lounge, restaurant, laundry, guest suite, gardens, hobby room & library. Blake Court is next to Highlands Village which includes Sainsbury's and Lloyds Pharmacy, as well as being close to bus routes to Southgate Underground and Enfield Town. There's always plenty going on back at the court too with a busy social calendar in place! Three-course dinners are served every day and once a week, the court offers a continental breakfast, as well as themed meals from time to time which are always great fun.

The site has been carefully designed for property owners to get around independently. Lifts and stairs connect each floor so wheelchair users are able to enjoy each area of the court. And if friends or family would like to visit, there's a guest suite available for use. Great if they want to see the sights of the capital at the same time!

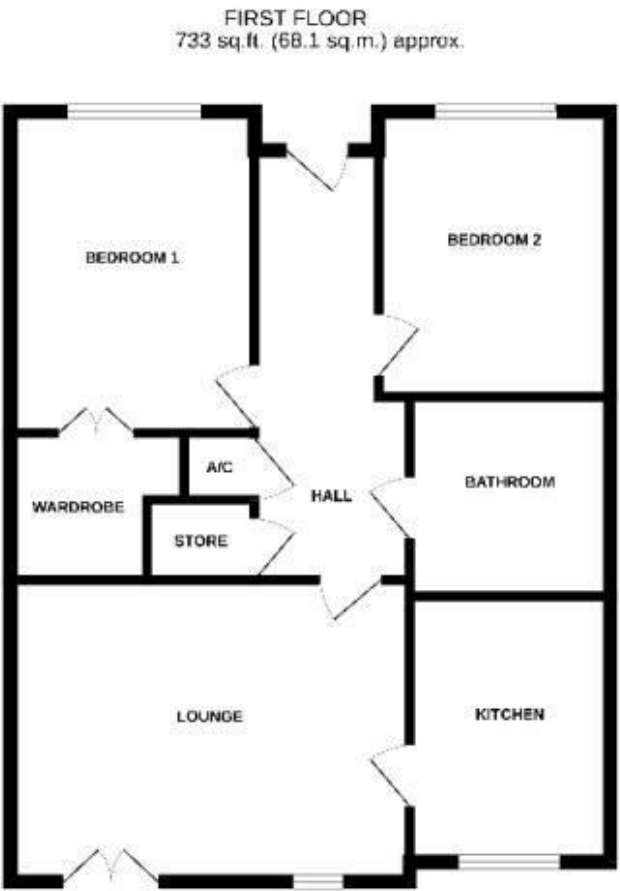

Energy Efficiency Rating		
	Current	Potential
Very energy efficient - lower running costs		
(92 plus) A		
(81-91) B	79	79
(69-80) C		
(55-68) D		
(39-54) E		
(21-38) F		
(1-20) G		
Not energy efficient - higher running costs		
England & Wales	EU Directive 2002/91/EC 