

NEWSHOLME DRIVE, N21 1SQ



£1,250

- FIRST FLOOR
- LOUNGE
- DOUBLE BEDROOM
- ON SITE RESTAURANT
- COMMUNAL GARDENS
- LIFT
- MODERN KITCHEN
- GUEST SUITE
- 24 HOUR A DAY STAFF
- SECURE PARKING

Property Details

PROPERTY DETAILS

RETIREMENT FLAT. OVER 65'S ONLY. We have pleasure in offering for rent this first floor retirement apartment within this fully managed development. There is a visitor guest suite, lift access and a warden pull cord in each room. The property offers a spacious reception room, newly fitted modern kitchen, bathroom and double bedroom. Other services include staff on duty 24 hours a day, on site restaurant, secure parking and communal gardens.

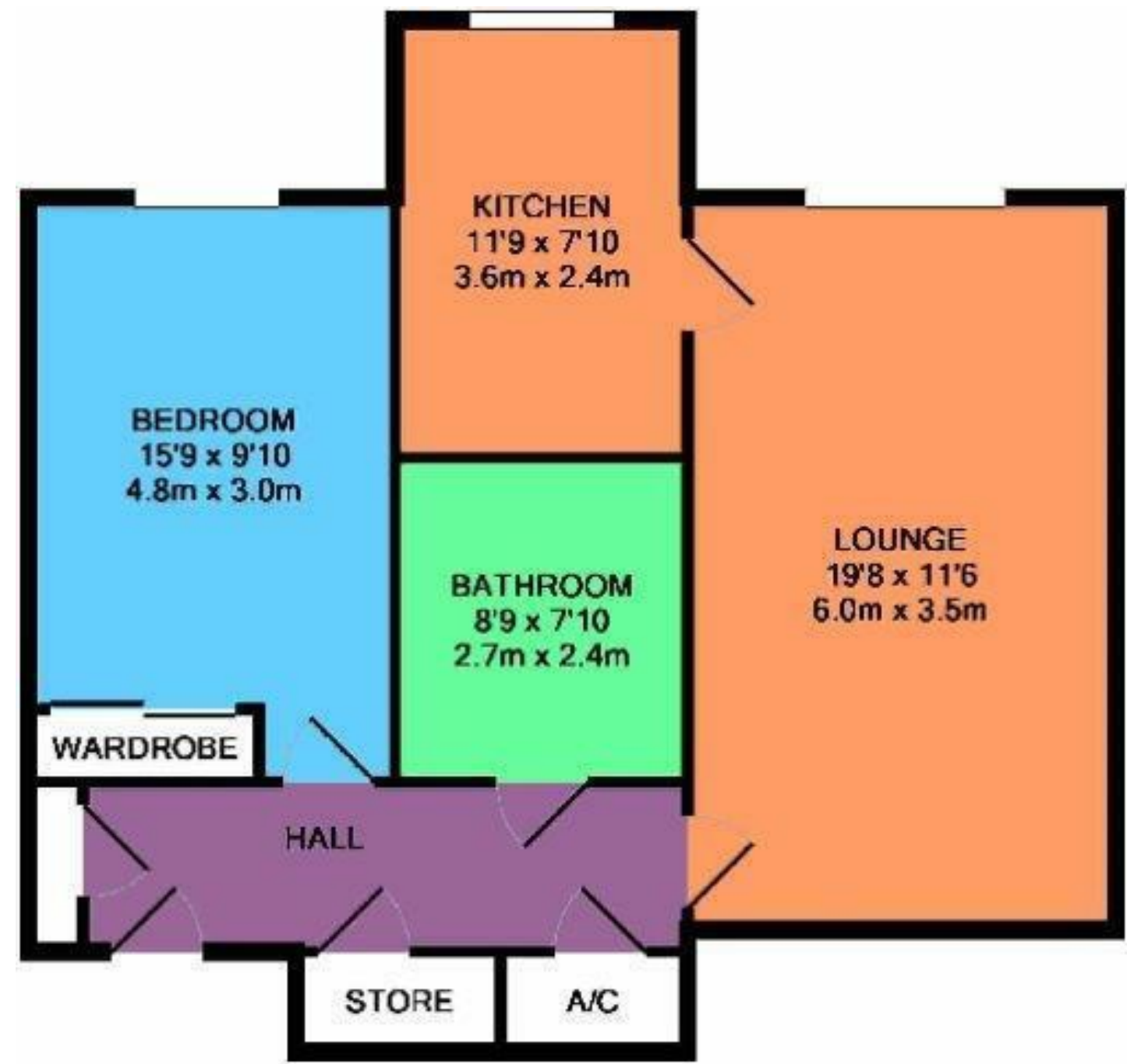

TOTAL APPROX. FLOOR AREA 653 SQ.FT. (60.7 SQ.M.)

While every attempt has been made to ensure the accuracy of this floor plan, measurements of doors, windows and rooms are approximate. Furniture layouts are indicative, loose furniture and appliances not included on the purchase price of the apartment are shown. Made with Metapic 2021.8

Energy Efficiency Rating		Current	Potential
Very energy efficient - lower running costs			
(92 plus) A			
(81-91) B		79	79
(69-80) C			
(55-68) D			
(39-54) E			
(21-38) F			
(1-20) G			
Not energy efficient - higher running costs			
England & Wales		EU Directive 2002/91/EC	