



NEWSHOLME DRIVE, N21 1SQ



£410,000 Leasehold

- FIRST FLOOR
- KITCHEN
- WET ROOM
- RECENTLY REDECORATED
- LEASE TERM 990 YEARS FROM 1997
- LOUNGE
- TWO BEDROOMS
- CHAIN FREE
- COMMUNAL FACILITIES

Property Details

Redecorated and re-carpeted first floor floor RETIREMENT flat in this prestigious development with stunning views. Lounge, kitchen, 2 bedrooms, bathroom, communal lounge, hobbies room, communal restaurant/dining room/laundry room, communal gardens. 24 Hour staff. Lease term is 990 years from 1997.

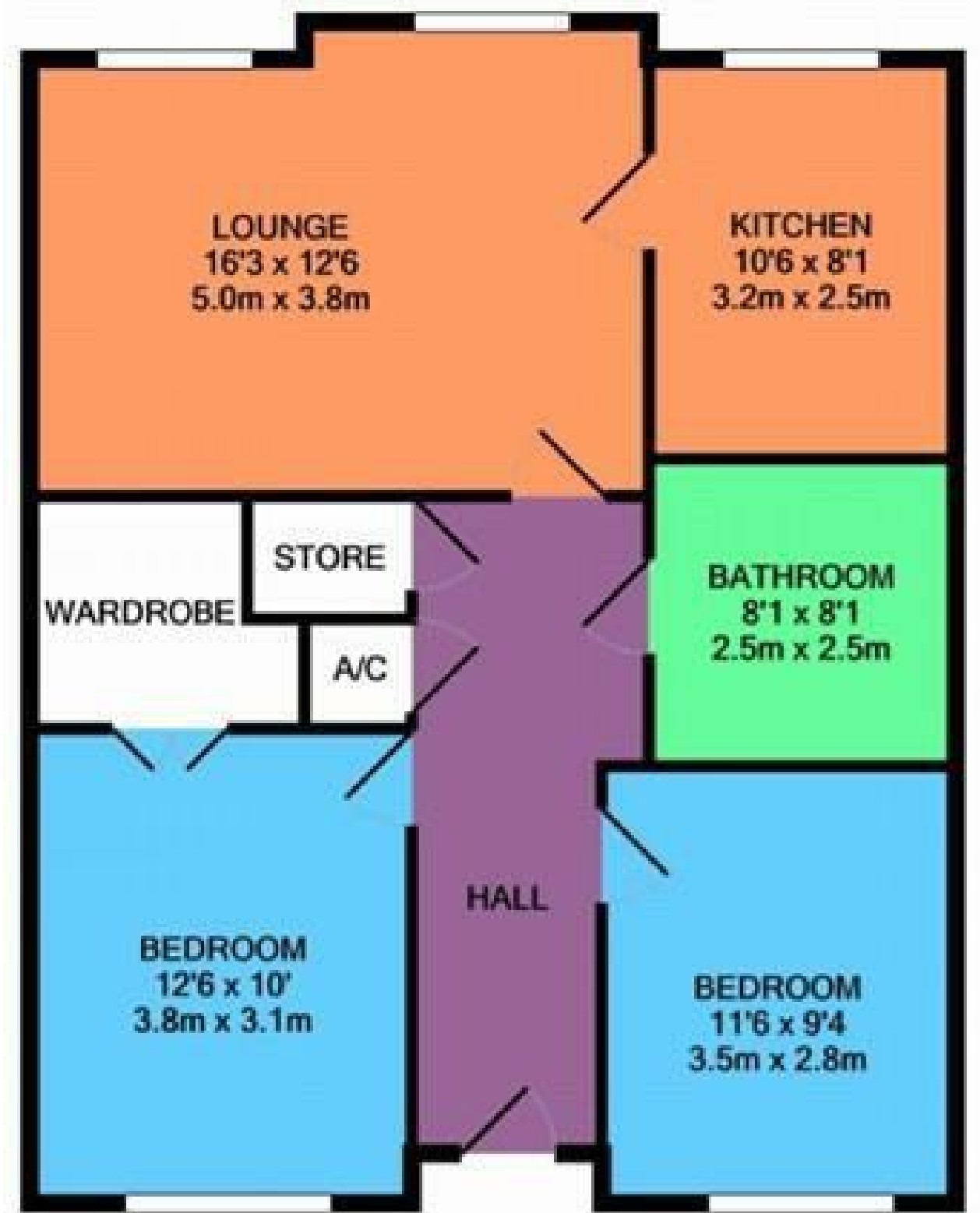

TOTAL APPROX. FLOOR AREA 734 SQ.FT. (68.2 SQ.M.)

Energy Efficiency Rating		Current	Potential
Very energy efficient - lower running costs			
(92 plus) A			
(81-91) B		81	81
(69-80) C			
(55-68) D			
(39-54) E			
(21-38) F			
(1-20) G			
Not energy efficient - higher running costs			
England & Wales		EU Directive 2002/91/EC	

