



Agatha Place, Peterborough
£200,000 **Freehold**

**Sharman
Quinney**

Key Features



- Modern End Terraced Home
- Two Double Bedrooms
- Lounge + Kitchen
- Downstairs Cloakroom
- Off Road Parking

Ideal First Time Home or a Great Investment this immaculate Modern End Terraced Home is located in walking distance to local shops and schools and in brief the accommodation comprises of, Entrance Hall with stairs to the first floor landing and doors to, Downstairs Cloak which is fitted with a low level WC and pedestal wash hand basin, Lounge with a built-in understairs storage cupboard, Kitchen with a range of base and eye level units, cupboards and drawers, worktop space, one and a quarter sink unit, built-in induction hob and oven, extractor fan over, space for fridge /freezer, plumbing for a washing machine, French doors opening out to the rear garden, Upstairs First Floor Landing has doors to the Two Double Bedrooms, three piece Family Bathroom, Outside to the front there is Two Allocated Parking Spaces providing Off Road Parking, side gated access to the



Enclosed Low Maintenance Rear Garden which is mainly paved and has a wooden decking giving a patio seating area.

Entrance Hall - 8'2" x 4'1"

Downstairs Cloakroom - 4'8" x 3'1"

Lounge - 15'4"max x 9'4"max

Fitted Kitchen - 12'6" x 8'1"

First Floor Landing - 6'5"max x 5'8"max (including stairs)

Bedroom 1 - 12'9"max x 9'3"max (including cupboard)

Bedroom 2 - 12'8"max x 8'2"max

Family Bathroom - 6'7"max x 5'9"max



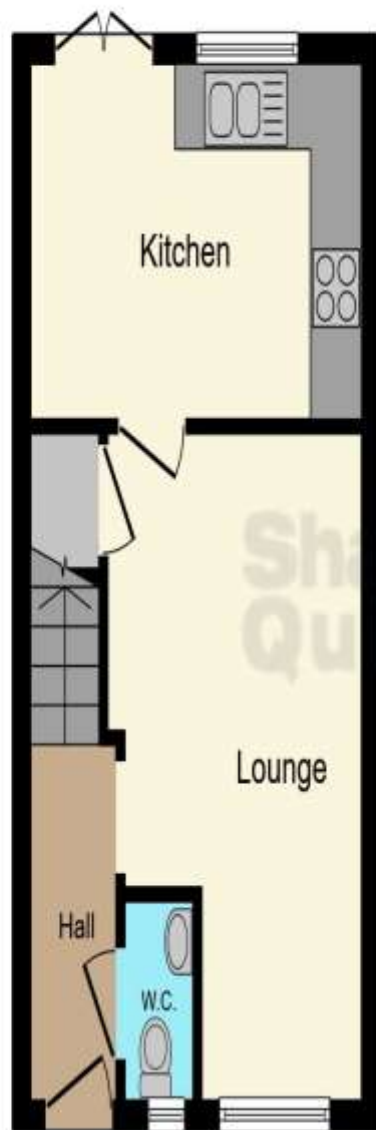

Ground Floor

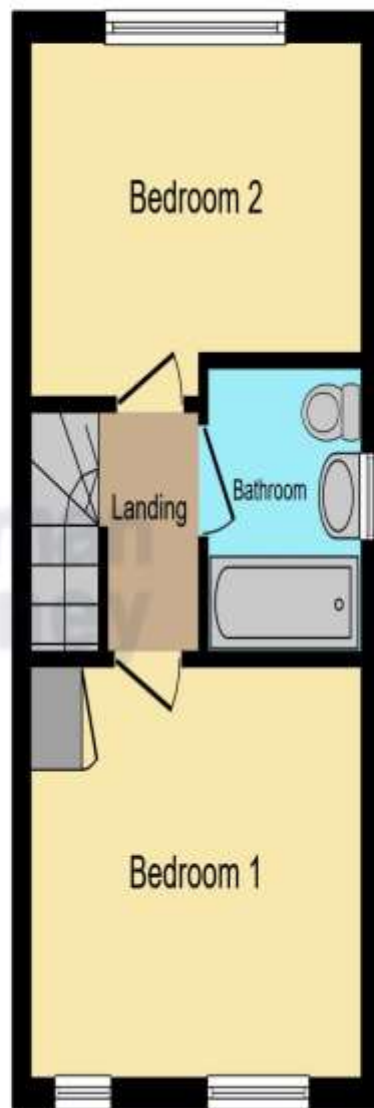

First Floor

This floor plan is for illustrative purposes only. It is not drawn to scale. Any measurements, floor areas (including any total floor area), openings and orientation are approximate. No details are guaranteed, they cannot be relied upon for any purpose and they do not form part of any agreement. No liability is taken for any error, omission or misstatement. A party must rely upon its own inspection(s). Powered by www.focalagent.com

To view this property call Sharman Quinney on:
01733 896222

Selling your property?

Contact us to arrange a **FREE**
home valuation.

 01733 896222

 13 Desborough Avenue, Stanground,
PETERBOROUGH, Cambridgeshire, PE2 8RG

 stanground@sharmanquinney.co.uk

 www.sharmanquinney.co.uk



 SCAN ME



Sharman Quinney Holdings Limited is registered in England and Wales under company number 4174227, Registered Office is Cumbria House, 16-20 Hockliffe Street, Leighton Buzzard, Bedfordshire, LU7 1GN. VAT Registration Number is 500 2481 05.

1: These particulars do not constitute part or all of an offer or contract. 2: The measurements indicated are supplied for guidance only and as such must be considered incorrect. 3: Potential buyers are advised to recheck the measurements before committing to any expense. 4: Sharman Quinney has not tested any apparatus, equipment, fixtures, fittings or services and it is the buyers interests to check the working condition of any appliances. 5: Sharman Quinney has not sought to verify the legal title of the property and buyers must obtain verification from their legal representative. 6: Intending purchasers will be asked to produce identification documentation at a later stage and we would ask your co-operation in order that there will be no delay in agreeing the sale. Ref: SSQ204772 - 0003

