



Littledale Crescent, Peterborough
Offers in Excess of £240,000 Leasehold

**Sharman
Quinney**

Key Features

 3  2  B  B



999 Years remaining as of 01 Jan 2015

£Ask Agent Ground Rent pcm

Review due: Ask Agent

£Ask Agent Service Charge pcm

Review due: Ask Agent

- Modern Semi-Detached Home
- Three Bedrooms
- En-Suite shower Room
- Kitchen/Diner
- Downstairs Cloakroom

Perfect First Time Home this Semi-Detached Home is set back from the main road and is close to an open green area which ideal area to walk your dog, it is also in walking distance to some local shops. In brief the accommodation comprises of, Entrance Hall with stairs to the first floor landing, doors giving access to the two piece Downstairs



Cloakroom, Lounge, Kitchen/Diner which has a range of fitted base and eye level, units, cupboards and drawers, worktop space, built-in electric hob and oven, space for a fridge/freezer, plumbing for washing machine and dishwasher, double doors opening out to the rear garden. Upstairs First Floor Landing with door to the Three Bedrooms, three piece En-Suite Shower Room and to the three piece Family bathroom. Outside to the front a double width driveway provides Off Road Parking, side gated access to the Rear Garden

Entrance Hall:

Downstairs Cloakroom - 5'6"max x 3'max

Lounge- 15'max 12'1"max (irregular shaped room)

Kitchen/Diner - 15'3" x 8'9"

First Floor Landing:

Bedroom 1 - 12'max x 9'5"max (irregular shaped room)

En-Suite Shower Room - 6'3"max x 5'7"max (including three piece suite)

Bedroom 2 - 9'1" x 7'6"

Bedroom 3 - 7'6" x 5'9"



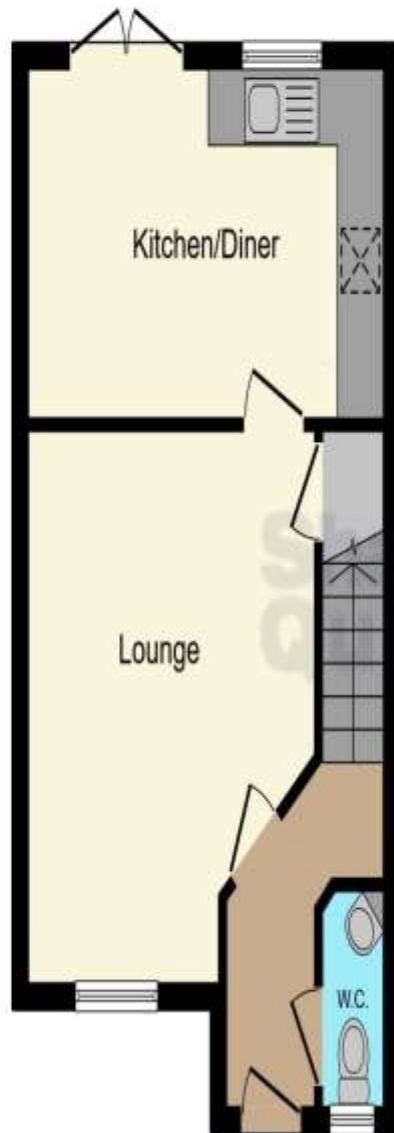

Ground Floor

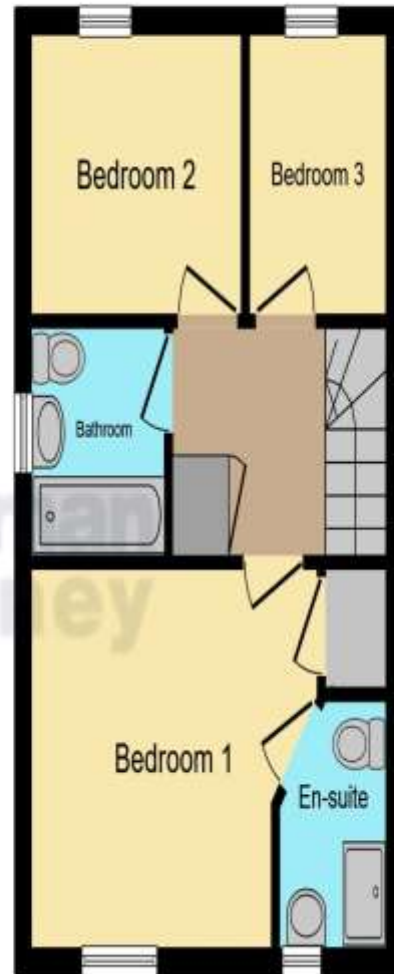

First Floor

Family Bathroom - 5'9"max x 5'9"max

This floor plan is for illustrative purposes only. It is not drawn to scale. Any measurements, floor areas (including any total floor area), openings and orientation are approximate. No details are guaranteed, they cannot be relied upon for any purpose and they do not form part of any agreement. No liability is taken for any error, omission or misstatement. A party must rely upon its own inspection(s). Powered by www.focalagent.com

To view this property call Sharman Quinney on:
01733 896222

Selling your property?

Contact us to arrange a **FREE**
home valuation.

 01733 896222

 13 Desborough Avenue, Stanground,
PETERBOROUGH, Cambridgeshire, PE2 8RG

 stanground@sharmanquinney.co.uk

 www.sharmanquinney.co.uk



 SCAN ME



Sharman Quinney Holdings Limited is registered in England and Wales under company number 4174227, Registered Office is Cumbria House, 16-20 Hockliffe Street, Leighton Buzzard, Bedfordshire, LU7 1GN. VAT Registration Number is 500 2481 05.

1: These particulars do not constitute part or all of an offer or contract. 2: The measurements indicated are supplied for guidance only and as such must be considered incorrect. 3: Potential buyers are advised to recheck the measurements before committing to any expense. 4: Sharman Quinney has not tested any apparatus, equipment, fixtures, fittings or services and it is the buyers interests to check the working condition of any appliances. 5: Sharman Quinney has not sought to verify the legal title of the property and buyers must obtain verification from their legal representative. 6: Intending purchasers will be asked to produce identification documentation at a later stage and we would ask your co-operation in order that there will be no delay in agreeing the sale. Ref: :SSQ204708 - 0003