

# HUNTERS®

HERE TO GET *you* THERE



## Gregson Terrace

South Hetton, DH6 2SX

Asking Price £95,000



END TERRACE BUNGALOW... Located on Gregson Terrace of South Hetton, this delightful bungalow offers a cosy retreat for those seeking comfort and convenience. Boasting a lounge, conservatory, one bedroom, and a well-appointed bathroom, this property is perfect for a single occupant or a couple looking for a peaceful abode. Spanning 560 square feet, this recently refurbished home exudes a fresh and modern appeal, ready to welcome its new owners with open arms. The ideal home for those yearning for simplicity and style, this bungalow is a gem waiting to be discovered. Don't miss the opportunity to make this charming property your own and experience the tranquillity of South Hetton living at its finest. "No Chain"



Entrance Hallway

Entrance to this fantastic and well presented bungalow is accessed via a double glazed door to the front of the property which enters the hallway. The hallway provides access to the master bedroom, bathroom and lounge with a double glazed window to the side, a radiator and a useful storage cupboard housing the combi boiler.

Master Bedroom 11'11" x 9'9" (3.64m x 2.99m)

The master bedroom located to the front of the property features a double glazed bay window to the front overlooking the wonderful front gardens and a radiator.

Bathroom 7'11" x 4'11" (2.42m x 1.50m)

This spectacular bathroom comprises of a low level w/c, a pedestal hand wash basin set to a vanity cabinet and a panelled bathroom with a shower overhead, attractive contemporary wall and flooring together with a contemporary chrome finished elevated towel radiator.

Lounge 17'3" x 10'5" (5.27m x 3.18m)

Positioned to the rear of this delightful residence, the adorable principle reception room features double glazed patio doors to the conservatory, a radiator. Further attributes include wall mounted electric fireplace, a door to the lounge and entrance hallway.

Kitchen 13'8" x 4'11" (4.18m x 1.52m)

The outstanding contemporary kitchen comprises of a wealth of wall and floor cabinets and contrasting work surfaces which integrate a stainless steel sink and drainer unit complete with mixer tap fittings positioned below a double glazed window to the side of the bungalow. Additional attributes include a brushed steel effect oven and a ceramic hob set beneath a complimenting extractor canopy, fitted microwave, fridge freezer and fitted automatic washing machine and dryer, laminate flooring and a radiator.

Conservatory 8'6" x 7'9" (2.61m x 2.37m)

Located to the rear of the property off the lounge, the double glazed conservatory is perfect for relaxing and unwinding in the evenings.

Outside Space

To the front of the property is a wonderful garden area, perfect for sitting in the sun and a small courtyard to the rear. The garden to the front will be maintained by the landlord.

Area Map



Floor Plans

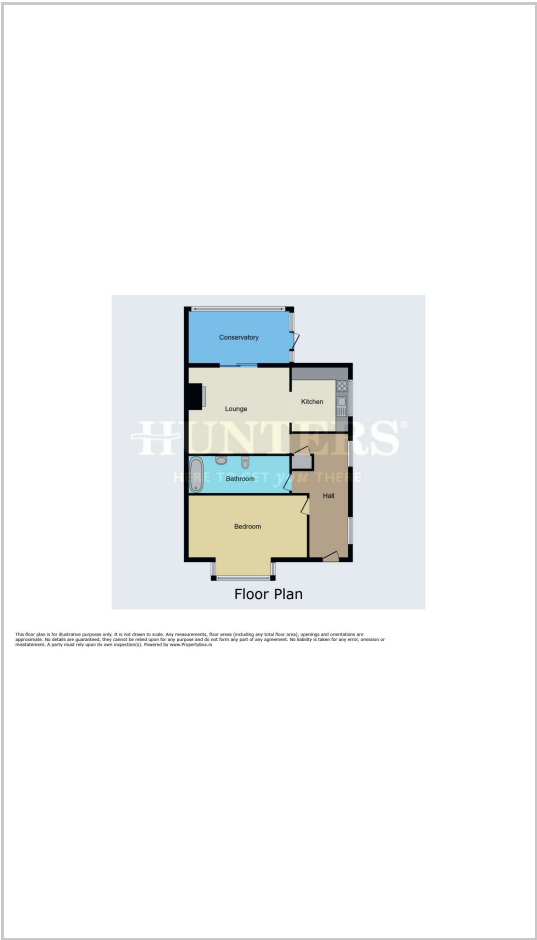

Energy Efficiency Graph

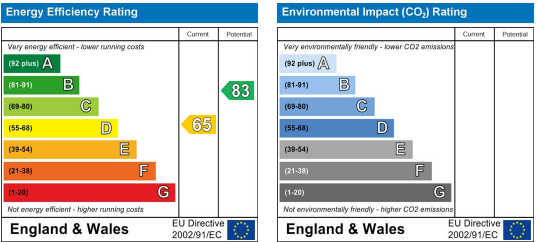

These particulars are intended to give a fair and reliable description of the property but no responsibility for any inaccuracy or error can be accepted and do not constitute an offer or contract. We have not tested any services or appliances (including central heating if fitted) referred to in these particulars and the purchasers are advised to satisfy themselves as to the working order and condition. If a property is unoccupied at any time there may be reconnection charges for any switched off/disconnected or drained services or appliances - All measurements are approximate. **THINKING OF SELLING?** If you are thinking of selling your home or just curious to discover the value of your property, Hunters would be pleased to provide free, no obligation sales and marketing advice. Even if your home is outside the area covered by our local offices we can arrange a Market Appraisal through our national network of Hunters estate agents.