



Seaview Road

Shoeburyness

- NO ONWARD CHAIN
- FOUR BEDROOMS
- DOUBLE GLAZING
- GAS CENTRAL HEATING



Guide Price £350,000 to £365,000

VACANT FOUR BEDROOM HOME arranged over three floors with double glazing and gas central heating. Large lounge diner and kitchen with separate utility room and separate cloakroom. Four bedrooms and bathroom to the top two floors. Close to local shops and the seafront.





AGENTS NOTES

VACANT FOUR BEDROOM HOUSE arranged over three floors with two bedrooms within the roof space and two further bedrooms on the first floor with a family bathroom.

The ground floor accommodation is very well laid out with a partially open plan lounge and large dining area with direct access to the garden.

The large kitchen is accessed directly from the dining area which also benefits from a small inner hallway with wash basin and doors to the ground floor cloakroom and separate utility room.

The location is excellent for a short stroll to the Town centre and the seafront is also well within walking distance.

Some updating is required but is a lot of property for the right buyer especially as a family home...

Ready to move into !!



HALL

LOUNGE

12' 4" x 12' 2" (3.76m x 3.71m)

DINING ROOM

12' 2" x 12' 3" (3.71m x 3.73m)

KITCHEN

13' 0" x 7' 6" (3.96m x 2.29m)

UTILITY ROOM

8' 2" x 4' 6" (2.49m x 1.37m)

CLOAKROOM

LANDING

BATHROOM

10' 2" x 6' 6" (3.1m x 1.98m)

BEDROOM

15' 6" x 12' 4" (4.72m x 3.76m)

BEDROOM

10' 2" x 5' 6" (3.1m x 1.68m)

LANDING

BEDROOM

14' 4" x 8' 6" (4.37m x 2.59m)

BEDROOM

8' 10" x 8' 4" (2.69m x 2.54m)

GARDEN



These particulars are accurate to the best of our knowledge but do not constitute an offer or contract. Photos are for representation only and do not imply the inclusion of fixtures and fittings. The floor plans are not to scale and only provide an indication of the layout.

Ground Floor

Approx. 56.1 sq. metres (603.5 sq. feet)



First Floor

Approx. 37.7 sq. metres (406.3 sq. feet)



Second Floor

Approx. 26.0 sq. metres (279.9 sq. feet)

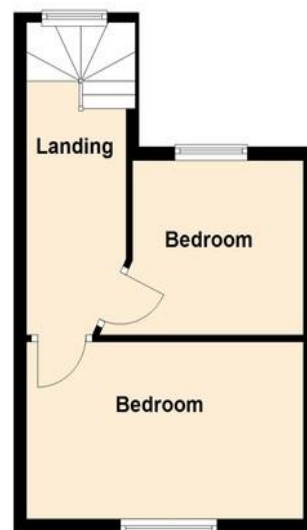

Total area: approx. 119.8 sq. metres (1289.7 sq. feet)

Regulated by RICS

t. 01702 34 11 77
More than an estate agent
www.hairandson.co.uk

Residential Sales
190 London Road
Southend-On-Sea
Essex SS1 1PJ

