



Matthew James

St James House | St James Road | Surbiton | Surrey KT6 4QH

T: +44 (0) 20 8390 2266

E: enquiries@matthewjamesestateagents.co.uk

www.matthewjamesestateagents.co.uk



Adelaide Road, Surbiton, KT6 4SU

A very spacious third floor lift serviced studio apartment with parking. Located on a popular residential road within a short walk of Surbiton Mainline station and high street. The many benefits include a very large studio room with sitting/dining, sleeping and study space. There is a separate fitted kitchen with appliances and a modern white bathroom suite with a shower over the bath. Electric heating and double glazing. A welcoming entrance hallway and storage cupboard. There is basement parking and a lock up store. Well maintained communal areas and garden. Council tax band B. We are informed the service charge is £392.82 pa. Lease in excess of 900 years. Sold with no onward chain.

Guide Price £230,000 Leasehold

EPC Rating: D

Adelaide Road, KT6

Approximate Area = 369 sq ft / 34.3 sq m
Store = 5 sq ft / 0.5 sq m
Total = 374 sq ft / 34.7 sq m
For identification only - Not to scale

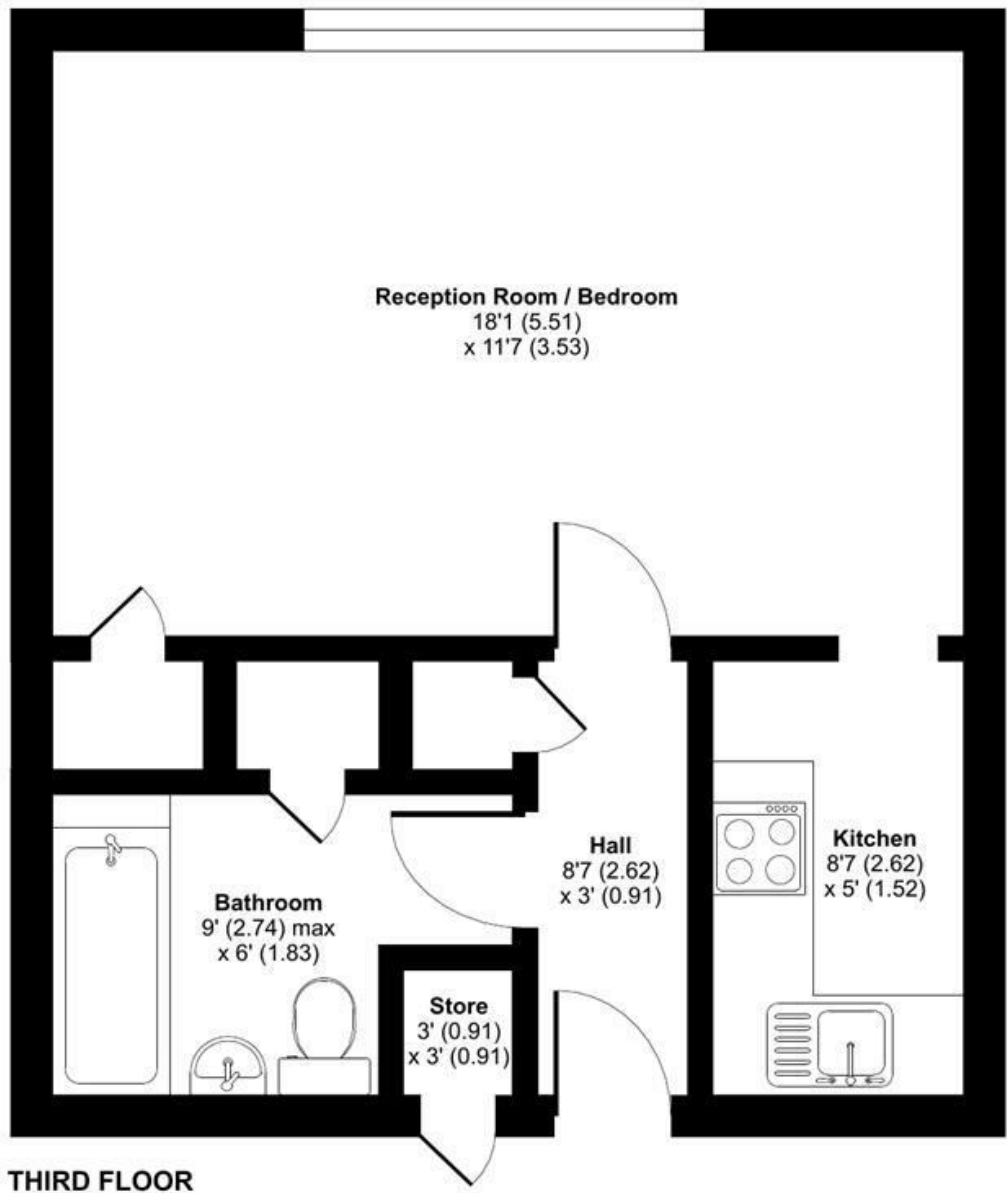

Floor plan produced in accordance with RICS Property Measurement 2nd Edition, Incorporating International Property Measurement Standards (IPMS2 Residential). © nchecom 2024. Produced for Matthew James. REF: 1217334

We aim to make our property details a reliable guide. However they are not guaranteed and do not form part of a contract. Information in relation to lease length, service charge and ground rent has been provided by the vendor, they are likely to be subject to reviews and increases in the future and will need to be verified by your legal representative. Please note that appliances and heating systems have not been tested and therefore no warranty can be given as to their good working order. Carpets, curtains, gas fires, electrical goods/fitings and other fixtures, unless expressly mentioned, are not included in the sale of this property. If there are any important matters which are likely to affect your decision to buy, please contact our office.

