



Matthew James

St James House | St James Road | Surbiton | Surrey KT6 4QH

T: +44 (0) 20 8390 2266

E: enquiries@matthewjamesestateagents.co.uk

www.matthewjamesestateagents.co.uk



## Galsworthy Road, Kingston upon Thames, KT2 7BP

An excellent two double bedroom ground floor purpose built apartment, with a garage and a lock-up store. Located opposite Kingston Hospital, within walking distance of Norbiton station, Kingston Town Centre and Richmond Park. The many benefits include a good size living room with sitting and dining space. A separate contemporary fitted kitchen with appliances. There is a large main bedroom with fitted wardrobes and a double second also with wardrobes. The modern fitted white bathroom suite includes a shower over the bath. Gas central heating and double glazing. Well maintained communal gardens. There is a garage in a block and a lock-up store. Council tax band C. Lease in excess of 900 years, we are informed the service charge for 2023 was £1780. Sold with no onward chain.

**Guide Price £367,000 Leasehold**

**EPC Rating: C**

# Galsworthy Road, Kingston Upon Thames, KT2

Approximate Area = 604 sq ft / 56.1 sq m

For identification only - Not to scale

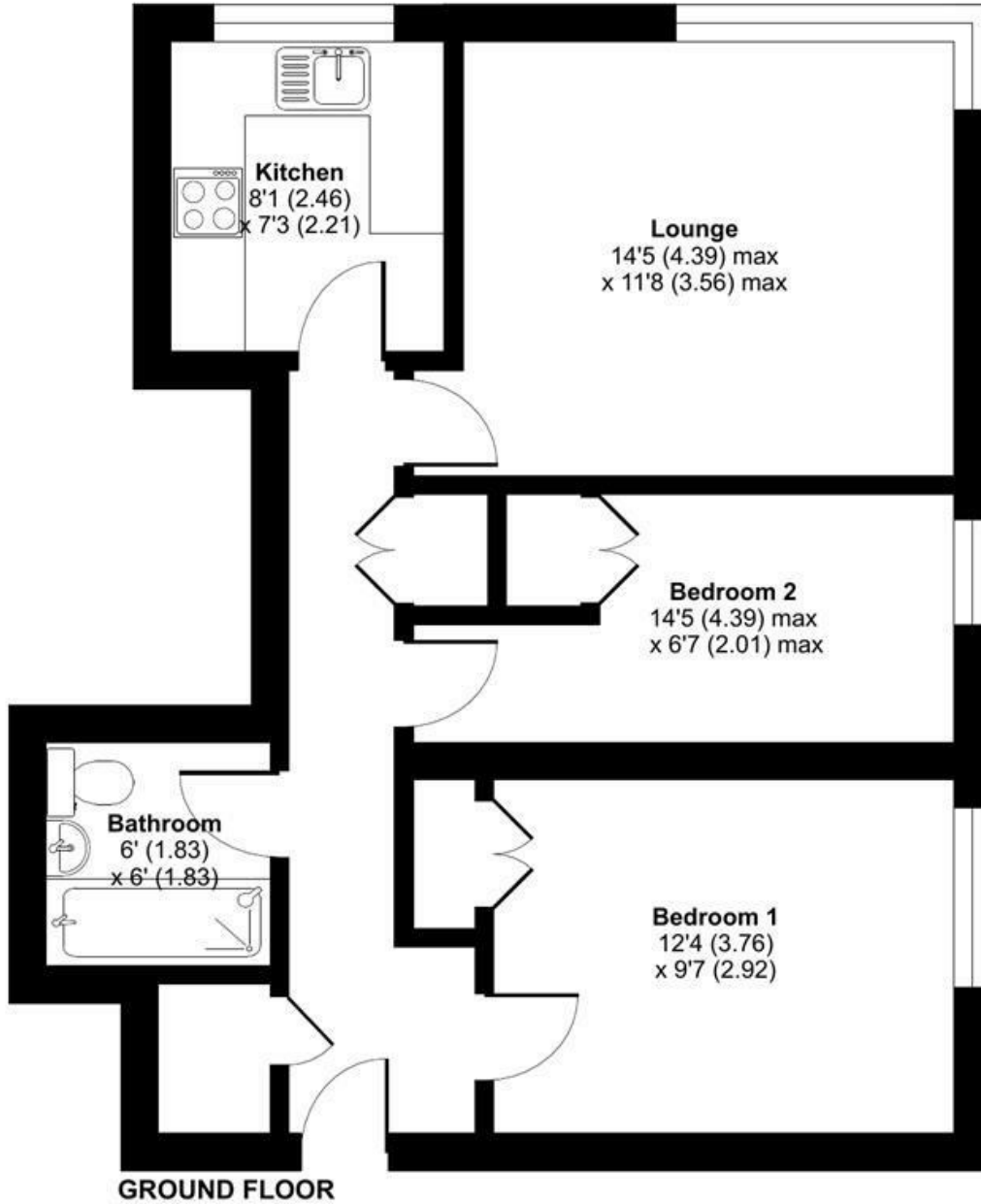

Floor plan produced in accordance with RICS Property Measurement Standards incorporating International Property Measurement Standards (IPMS2 Residential). © nichecom 2024. Produced for Matthew James. REF: 1073672

We aim to make our property details a reliable guide. However they are not guaranteed and do not form part of a contract. Information in relation to lease length, service charge and ground rent has been provided by the vendor, they are likely to be subject to reviews and increases in the future and will need to be verified by your legal representative. Please note that appliances and heating systems have not been tested and therefore no warranty can be given as to their good working order. Carpets, curtains, gas fires, electrical goods/fittings and other fixtures, unless expressly mentioned, are not included in the sale of this property. If there are any important matters which are likely to affect your decision to buy, please contact our office.

