



125

— YEARS OF —

**Lambert
& Foster**



STATION VILLA
STATION ROAD, GOUDHUST, KENT, TN17 1HA



**Lambert
& Foster**

GOUDHURST HIGH STREET 1 MILE | MARDEN 6 MILES | TUNBRIDGE WELLS 9 MILES

STATION VILLA, STATION ROAD, GOUDHURST, KENT TN17 1HA

A delightful four-bedroom semi-detached Victorian cottage, thoughtfully extended to create superb dining and entertaining space. This charming family home offers off-road parking, gardens, and a versatile timber outbuilding (formerly a double car port). Enjoy easy access to picturesque countryside footpaths, perfect for outdoor enthusiasts. The property also benefits from approved planning permission for a garden room to the rear (Ref: TW19/00995/FULL) and falls within the sought-after Cranbrook School catchment area.

GUIDE PRICE £650,000

FREEHOLD



DIRECTIONS

Using WHAT3WORDS; zapped,hanging,sailor



DESCRIPTION

Station Villa is a character Victorian cottage, which has benefited from a sympathetic, two storey extension. This fine four-bedroom family home presents brick elevations, set with a mixture of multi paned single glazed casement and UPVC double glazed windows, beneath a pitched and hipped tiled roof with flat roof to the extension.

The period accommodation is arranged over three floors with features including the sitting room with open fireplace, exposed wooden floors, aspect to front extending out across the road to fields. A particular feature is the kitchen/dining room with island and breakfast bar, space and housing for range style cooker and American style fridge/freezer, twin bowl ceramic sink with mixer tap over, quartz work surfaces, engineered wooden parquet flooring, a triple aspect incorporating double doors opening out to the garden. Open plan snug with fireplace (currently sealed) with useful storage cupboards. Leading on to a rear boot/dog room and utility room with space and plumbing for washing machine, tiled floor and door to outside. A useful cloakroom is fitted with traditional high-level WC and twin bowl ceramic wash hand basin.

Arranged over the first and second floors are four bedrooms including a triple aspect main bedroom enjoying distant views out across to fields and with an en-suite shower room with walk-in shower, close coupled wc and wash hand basin. The family bathroom is fitted with a traditional suite including separate electric shower, freestanding rolltop bath with mixer tap and shower attachment, vanity unit with marble top, mixer tap and inset wash hand basin. Bedrooms two and three have feature cast iron fireplaces.

Bedroom four on the second floor has exposed floorboards, enjoys a double aspect including Velux roof line windows with fine views out across rooftops and fields beyond.





GARDENS & GROUNDS

Outside, a drive with five bar gate opens onto gravel parking and to a detached timber outbuilding (former double car port) with useful lean to providing covered storage. The garden comprises lawn and extensive paved sun terrace with a brick-built barbecue.

- Four bedrooms
- Main bedroom with en-suite shower room
- Impressive kitchen/dining/family room
- Sitting room with open fireplace
- Rear boot/dog room, utility room and cloakroom with wc
- Off road parking
- Useful timber outbuilding



FLOORPLANS

For identification purposes only. The position and size of doors, windows, appliances and other features are approximate only.

Station Villa, Station Road, Goudhurst, Cranbrook, TN17 1HA

Approximate Area = 1627 sq ft / 151.1 sq m

Limited Use Area(s) = 15 sq ft / 1.3 sq m

Total = 1642 sq ft / 152.4 sq m

For identification only - Not to scale

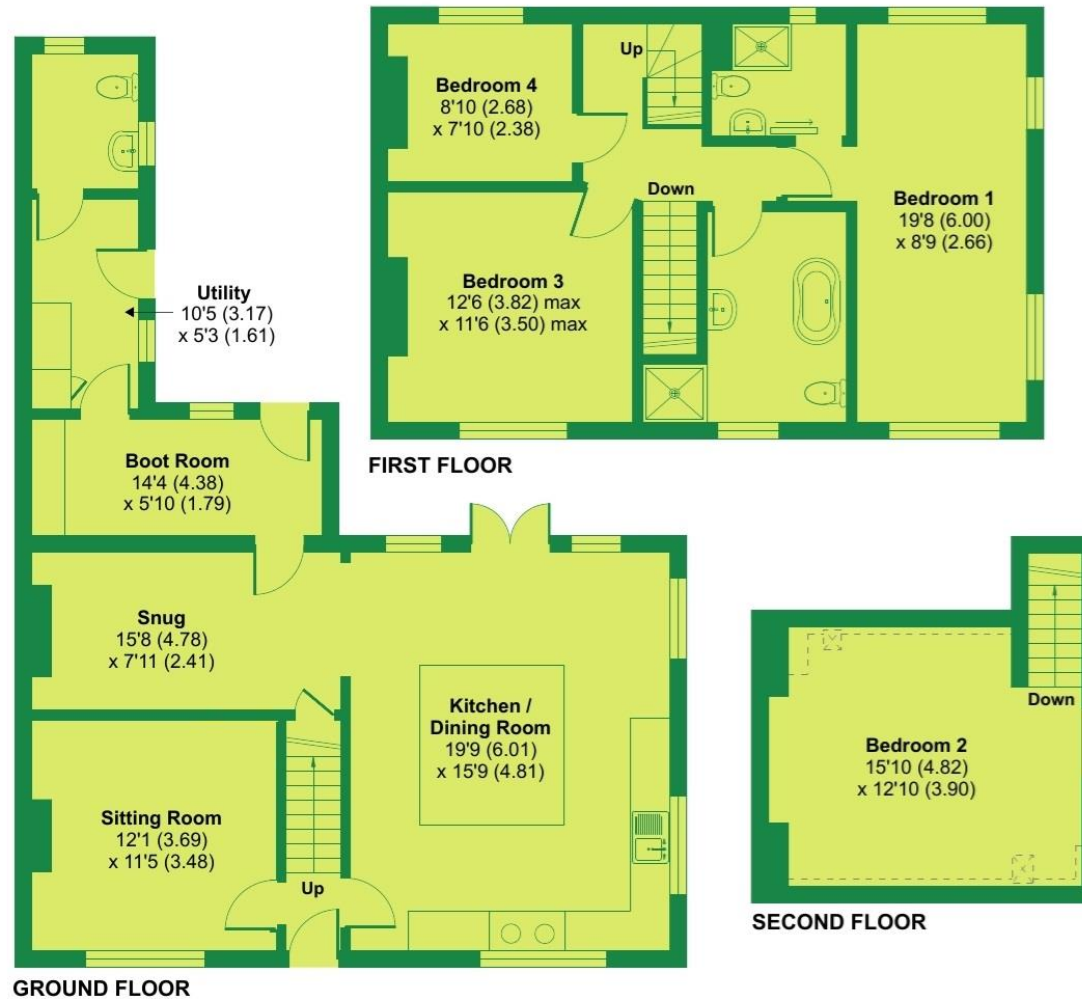

Floor plan produced in accordance with RICS Property Measurement 2nd Edition, Incorporating International Property Measurement Standards (IPMS2 Residential). © n̄checom 2025. Produced for Lambert and Foster Ltd. REF: 1254741



VIEWING: By appointment only. **Cranbrook Office:** 01580 712888

TENURE: Freehold

SERVICES & UTILITIES:

Electricity supply: Mains

Water supply: Mains

Sewerage: Shared private treatment plant

Heating: Oil fired central heating

BROADBAND & MOBILE COVERAGE: Standard and Ultrafast fibre available (Visit <https://checker.ofcom.org.uk/en-gb/broadband-coverage> or enquire with the office for more information).

LOCAL AUTHORITY: www.tunbridgewells.gov.uk

COUNCIL TAX: Band D **EPC:** E (47)

The Estate Agents Act 1979:

The seller of this property is an employee of Lambert & Foster.



PARTICULARS, PLANS AND SCHEDULES: The particulars and acreages stated, together with the plans are believed but not guaranteed to be correct. They are given by the Agents to assist viewers but are specifically excluded from any contract. Prospective purchasers must satisfy themselves as to the information enclosed.

IMPORTANT NOTICE: Lambert & Foster themselves and the vendors and/or lessors of this property whose agents they are, give notice that: The particulars are set out as a general outline only for guidance and do not constitute part of an offer or contract. All descriptions, dimensions, references to condition and necessary permissions for the use and occupation and other details are given in good faith and are believed to be correct. Any intending purchasers/lessees should not rely on them as statements or presentations of fact but satisfy themselves by inspection or otherwise as to the correctness of each of them. If there are any points which are of particular importance to you, please contact the office and we will be pleased to check the information, particularly if you are travelling some distance to view the property.

In accordance with the Consumer Protection from Unfair Trading Regulations 2008 (CPR), we must advise that we have not tested any of the main services, various electrical or gas appliances and fixtures which may be referred to in these sales particulars. Any prospective purchasers are strongly advised to satisfy themselves that such are in working order. No person in the employment of the Agents has any authority to make or give any representations or warranty whatever in relation to this property.

MONEY LAUNDERING REGULATION: In accordance with Money Laundering Regulations, we are now required to obtain proof of identification for all vendors and purchasers. You will need to supply information required for us to complete our identification checks which will include your date of birth, main residential address and a colour copy of your passport or photo driving licence. Lambert & Foster apologise for any inconvenience this may cause, but it is a legal requirement. Lambert & Foster will not be able to conclude a sale on your behalf to any person or people who are unable to provide confirmation of identification. Note: Lambert & Foster currently employs the services of Smartsearch to verify the identity and address of vendors/purchasers.



OFFICES LOCATED AT:

PADDOCK WOOD, KENT
Tel. 01892 832 325
77 Commercial Road,
Paddock Wood, Kent TN12 6DS

WADHURST, EAST SUSSEX
Tel. 01435 873 999
Helix House, High Street
Wadhurst, East Sussex TN5 6AA

HYTHE, KENT
Tel. 01303 814 444
Hillhurst Farm, Stone St,
Westenhanger, Hythe CT21 4HU

CRANBROOK, KENT
Tel. 01580 712 888
Weald Office, 39 High Street
Cranbrook, Kent TN17 3DN



**Lambert
& Foster**



arla | propertymark naea | propertymark

PROPERTY PROFESSIONALS FOR OVER 120 YEARS