



Temple Fields, Hertford, SG14 3LS

Welcome to Temple Fields, Hertford

A beautifully presented, larger-than-average three-bedroom first-floor apartment located in the highly sought-after and peaceful village of Bengeo. Recently refurbished throughout, this bright and spacious home offers well-proportioned accommodation ideal for families or downsizers. The property features three generous double bedrooms, each with built-in wardrobes, providing ample storage. The open plan living and dining area enjoys excellent natural light and flows seamlessly into the modern, newly installed kitchen, complete with high-quality integrated appliances and underfloor heating. From the living space, doors open directly onto own private balcony offering delightful views over the well-kept communal gardens to the rear. A contemporary recently installed family bathroom, fitted to a high standard, further enhances the appeal of this wonderful home. Additional benefits include double glazing throughout, low annual service charges, and allocated parking and visitor parking. Perfectly positioned, the apartment is just a short stroll from Bengeo Primary School and enjoys easy access to scenic countryside walks, making it an ideal blend of village tranquillity and everyday convenience.



-Accommodation Overview-

Entrance Hall:

Two storage cupboards.

Open Lounge / Kitchen:

20' 6" x 10' 11" (6.25m x 3.33m)

Double glazed window to rear aspect, underfloor heating, opens to kitchen.

Kitchen Area:

Modern fitted wall and floor units with work surface over, sink unit with mixer tap over, integrated appliances, electric hob with oven beneath and extractor canopy over, double glazed doors leading to private balcony.

-Balcony-

Lovely views across well-kept communal gardens.

Bedroom One:

12' 7" x 10' 11" (3.84m x 3.33m)

Double glazed window, fitted wardrobe, underfloor heating.

Bedroom Two:

11' 9" excluding wardrobe x 9' 7" (3.58m excluding wardrobe x 2.92m)

Double glazed window, fitted wardrobe, underfloor heating.

Bedroom Three:

8' 8" excluding wardrobe x 7' 6" (2.64m excluding wardrobe x 2.29m)

Double glazed window, fitted wardrobe, underfloor heating.

Bathroom:

Three-piece suite comprising of bath with shower unit over, wash hand basin with mixer tap over, WC, tiled walls and flooring, obscure double-glazed window.

-Exterior-

Parking:

Allocated parking space and visitor parking available.

Communal Gardens

Well-kept communal gardens.



check out more properties at williamhbrown.co.uk

Welcome to Temple Fields, Hertford

- Completely Refurbished Three Double Bedroom First Floor Apartment
- Modern Fitted Kitchen With Integrated Appliances
- Located In A Desirable Location Of Bengeo
- Private Balcony
- Close To Local Amenities

Tenure: Leasehold **EPC Rating:** C

Council Tax Band: D

Service Charge: £100.00 Yearly

Ground Rent: £10.00 Yearly

This is a Leasehold property with details as follows; Term of Lease 125 years from 29 Feb 1988. Should you require further information please contact the branch. Please Note additional fees could be incurred for items such as Leasehold packs.

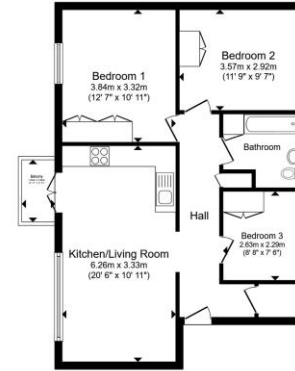

Total floor area 66.7 m² (717 sq.ft.) approx.
This floor plan is for illustrative purposes only. It is not drawn to scale. Any measurements, floor areas (including any total floor area), openings and orientation are approximate. No details are guaranteed. They cannot be relied upon for any purpose and they do not form part of any agreement. No liability is taken for any error, omission or misstatement. A party must rely upon its own inspection(s). Powered by www.properbox.io

**william
h brown**

Offers In Excess Of
£275,000



Please note the marker reflects the postcode not the actual property

check out more properties at williamhbrown.co.uk



Property Ref:
HFD108102 - 0001

1. MONEY LAUNDERING REGULATIONS Intending purchasers will be asked to produce identification documentation at a later stage and we would ask for your co-operation in order that there is no delay in agreeing the sale. 2. These particulars do not constitute part or all of an offer or contract. 3. The measurements indicated are supplied for guidance only and as such must be considered incorrect. Potential buyers are advised to recheck measurements before committing to any expense. 4. We have not tested any apparatus, equipment, fixtures or services and it is in the buyer's interest to check the working condition of any appliances. 5. Where an EPC, or a Home Report (Scotland only) is held for this property, it is available for inspection at the branch by appointment. If you require a printed version of a Home Report, you will need to pay a reasonable production charge reflecting printing and other costs. 6. We are not able to offer an opinion either written or verbal on the content of these reports and this must be obtained from your legal representative. 7. Whilst we take care in preparing these reports, a buyer should ensure that his/her legal representative confirms as soon as possible all matters relating to title including the extent and boundaries of the property and other important matters before exchange of contracts.

William H Brown is a trading name of Sequence (UK) Limited which is registered in England and Wales under company number 4268443, Registered Office is Cumbria House, 16-20 Hockliffe Street, Leighton Buzzard, Bedfordshire, LU7 1GN. VAT Registration Number is 500 2481 05.

**william
h brown**



01992 586501



Hertford@williamhbrown.co.uk



21 Castle Street, HERTFORD, Hertfordshire,
SG14 1ER



williamhbrown.co.uk