



**Bamburgh Close, Grantham NG31 8UL**



**welcome to**

**Bamburgh Close, Grantham**

\*GUIDE PRICE of £235,000 - £245,000\* - Very well presented modern, three bedroom, semi-detached house boasting accommodation to include a kitchen/diner with french doors leading to the garden, lounge, three bedrooms, one with en-suite and family bathroom. Good sized off road parking.



### **Entrance**

Entering the property through a part glazed uPVC door into the entrance hall with a radiator, staircase leading to the first floor landing, and doors leading to the downstairs cloakroom, kitchen/diner and lounge.

### **Downstairs Cloakroom**

With a window to the rear aspect, and comprising of a two piece suite including a pedestal wash hand basin and low level WC, there is partial tiling to the walls, a radiator.

### **Lounge**

15' 5" x 10' 2" ( 4.70m x 3.10m )

This generous family lounge offers a wealth of light, with a window to both front and rear aspects, a radiator, carpet, TV point and telephone point.

### **Kitchen/diner**

15' 5" x 9' 7" min ( 4.70m x 2.92m min )

Boasting a range of units at both floor and eye level with worktops over, inset stainless steel sink unit with single drainer and mixer tap. Built in electric oven and 4-ring gas hob with extractor hood above. Integral fridge-freezer, with further plumbing for automatic washing machine. Wall mounted gas fired boiler and window to the front aspect.

The dining area provides space for a dining suite, with French doors opening to the rear garden, two radiators and spotlights to the ceiling.

### **First Floor Landing**

Staggered staircase to the first floor landing, with door to the airing cupboard, and doors leading through to the bedrooms and family bathroom.

### **Master Bedroom**

11' 2" x 10' 4" ( 3.40m x 3.15m )

This double master bedroom has a fitted wardrobe to one wall, window to the side aspect and door leading through to the en-suite.

### **En-Suite**

Three piece modern suite comprising of shower cubicle, pedestal wash hand basin and low level WC. a radiator, spotlights to ceiling, extractor fan and obscure window to the rear aspect.

### **Bedroom Two**

11' 11" x 7' 7" ( 3.63m x 2.31m )

This double bedroom has a window to the rear aspect, and a radiator.

### **Bedroom Three**

10' 9" x 7' 6" irregular shape ( 3.28m x 2.29m irregular shape )

This irregular shaped room is a good size third bedroom with a window to the front aspect, and a radiator.

### **Family Bathroom**

Three piece suite comprising of panel bath, pedestal wash hand basin and low level WC. There is a radiator, extractor fan, part tiling to the walls and obscure window to the rear aspect.

### **General Description Outside**

Approaching the property, there is access via a shared driveway and providing off road parking for several vehicles. There is a small lawned area with some mature shrubs and pathway leading to the front door.

To the rear, the garden is fully enclosed by fencing, mainly laid to lawn and with a patio area ideal for outdoor dining.



***view this property online*** [williamhbrown.co.uk/Property/GST111876](http://williamhbrown.co.uk/Property/GST111876)



welcome to

## Bamburgh Close, Grantham

- Modern, Three Bedroom, Semi-Detached House
- Lounge and Kitchen/Diner with French Doors to the Garden
- En-suite to the Master and Family Bathroom
- Off Road Parking for Several Vehicles
- Well Presented Throughout

Tenure: Freehold EPC Rating: B

guide price

**£235,000 - £245,000**

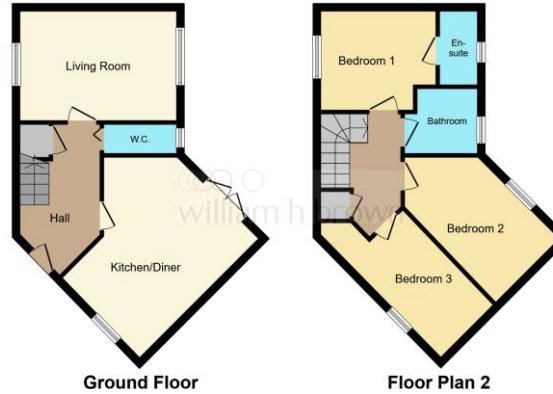

Please note the marker reflects the postcode not the actual property

**view this property online** [williamhbrown.co.uk/Property/GST111876](http://williamhbrown.co.uk/Property/GST111876)



Property Ref:  
GST111876 - 0007

1. MONEY LAUNDERING REGULATIONS Intending purchasers will be asked to produce identification documentation at a later stage and we would ask for your co-operation in order that there is no delay in agreeing the sale. 2. These particulars do not constitute part or all of an offer or contract. 3. The measurements indicated are supplied for guidance only and as such must be considered incorrect. Potential buyers are advised to recheck measurements before committing to any expense. 4. We have not tested any apparatus, equipment, fixtures or services and it is in the buyers interest to check the working condition of any appliances. 5. Where an EPC, or a Home Report (Scotland only) is held for this property, it is available for inspection at the branch by appointment. If you require a printed version of a Home Report, you will need to pay a reasonable production charge reflecting printing and other costs. 6. We are not able to offer an opinion either written or verbal on the content of these reports and this must be obtained from your legal representative. 7. Whilst we take care in preparing these reports, a buyer should ensure that his/her legal representative confirms as soon as possible all matters relating to title including the extent and boundaries of the property and other important matters before exchange of contracts.

William H Brown is a trading name of Sequence (UK) Limited which is registered in England and Wales under company number 4268443, Registered Office is Cumbria House, 16-20 Hockliffe Street, Leighton Buzzard, Bedfordshire, LU7 1GN. VAT Registration Number is 500 2481 05.



william h brown



**01476 566363**



[Grantham@williamhbrown.co.uk](mailto:Grantham@williamhbrown.co.uk)



63 High Street, GRANTHAM, Lincolnshire,  
NG31 6NN



[williamhbrown.co.uk](http://williamhbrown.co.uk)