



**Lydgate Green, Southampton SO19 6LP**

**welcome to**

## **Lydgate Green, Southampton**

BOOK TO VIEW!!

Welcome to this three bedroom end of terrace house, located in a residential area with schools and local amenities nearby. The property comprises three well-appointed bedrooms, spacious lounge, fitted kitchen/diner, family bathroom with separate w/c and front and rear gardens.

### **Entrance Hall**

Double glazed door and window to the front aspect, stairs to first floor landing, radiator, carpeted, doors to;

### **Lounge**

18' 4" x 10' 6" ( 5.59m x 3.20m )

Double glazed window to the front aspect, double glazed sliding doors to the rear aspect, radiator, TV point, fireplace feature, carpeted.

### **Kitchen/Diner**

18' 8" x 7' 2" ( 5.69m x 2.18m )

Double glazed window and door to the front aspect, wall and base cupboard units, work surfaces, gas hob, electric oven, partially tiled walls, space for fridge/freezer, plumbing for washing machine, door to garden.

### **Landing**

Airing cupboard, doors to;

### **Bedroom One**

12' 6" x 10' 7" ( 3.81m x 3.23m )

Double glazed window to the front aspect, TV point.

### **Bedroom Two**

12' 8" x 10' 3" ( 3.86m x 3.12m )

Double glazed window to the front aspect, cupboard, radiator.

### **Bedroom Three**

7' 3" x 8' 3" ( 2.21m x 2.51m )

Double glazed window to the rear aspect, TV point, carpeted.

### **Separate W/C**

Double glazed window to the rear aspect, w/c.

### **Bathroom**

Double glazed window to the rear aspect, bath with electric shower above, wash hand basin, radiator.







**Welcome to this three bedroom end of terrace house, located in a residential area with local amenities and schools on your doorstep. Lydgate Green offers great access to the M27 and nearby bus routes.**

**The ground floor of the property boasts a spacious lounge and fitted kitchen/diner, with both rooms providing access to the rear garden. Upstairs, there are three well-appointed bedrooms and a family bathroom with separate w/c.**

**Outside, this family home offers front and rear gardens, ideal for families requiring their own outdoor space.**

**A viewing is highly recommended to appreciate this home!**



***view this property online*** [fox-and-sons.co.uk/Property/BIT110765](https://fox-and-sons.co.uk/Property/BIT110765)



welcome to

## Lydgate Green, Southampton

- End of Terrace House
- Three Bedrooms
- Spacious Lounge
- Fitted Kitchen/Diner
- Bathroom with Separate W/c

Tenure: Freehold EPC Rating: D

Council Tax Band: B

offers over

**£240,000**



Ground Floor

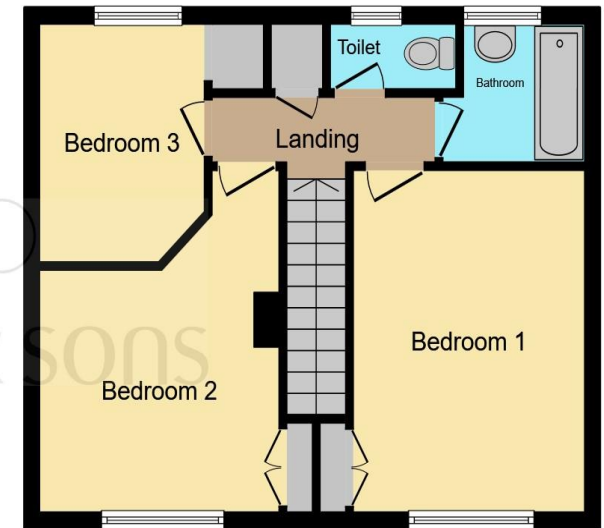

First Floor

This floor plan is for illustrative purposes only. It is not drawn to scale. Any measurements, floor areas (including any total floor area), openings and orientation are approximate. No details are guaranteed, they cannot be relied upon for any purpose and they do not form part of any agreement. No liability is taken for any error, omission or misstatement. A party must rely upon its own inspection(s). Powered by [www.focalagent.com](http://www.focalagent.com)

view this property online [fox-and-sons.co.uk/Property/BIT110765](http://fox-and-sons.co.uk/Property/BIT110765)



Property Ref:

BIT110765 - 0002

1. MONEY LAUNDERING REGULATIONS Intending purchasers will be asked to produce identification documentation at a later stage and we would ask for your co-operation in order that there is no delay in agreeing the sale. 2. These particulars do not constitute part or all of an offer or contract. 3. The measurements indicated are supplied for guidance only and as such must be considered incorrect. Potential buyers are advised to recheck measurements before committing to any expense. 4. We have not tested any apparatus, equipment, fixtures or services and it is in the buyers interest to check the working condition of any appliances. 5. Where an EPC, or a Home Report (Scotland only) is held for this property, it is available for inspection at the branch by appointment. If you require a printed version of a Home Report, you will need to pay a reasonable production charge reflecting printing and other costs. 6. We are not able to offer an opinion either written or verbal on the content of these reports and this must be obtained from your legal representative. 7. Whilst we take care in preparing these reports, a buyer should ensure that his/her legal representative confirms as soon as possible all matters relating to title including the extent and boundaries of the property and other important matters before exchange of contracts.

Fox & Sons is a trading name of Sequence (UK) Limited which is registered in England and Wales under company number 4268443, Registered Office is Cumbria House, 16-20 Hockliffe Street, Leighton Buzzard, Bedfordshire, LU7 1GN. VAT Registration Number is 500 2481 05.

  
fox & sons



**023 8044 6724**



[Bitterne@fox-and-sons.co.uk](mailto:Bitterne@fox-and-sons.co.uk)



390c Bitterne Road, Bitterne, SOUTHAMPTON,  
Hampshire, SO18 1BY



**[fox-and-sons.co.uk](http://fox-and-sons.co.uk)**