



**Park Road, Bexhill-On-Sea TN39 3HY**

**welcome to**

**Park Road, Bexhill-On-Sea**

New to the market is this immaculately presented TWO BEDROOM MAISONETTE with a PRIVATE REAR GARDEN! Located in a prime location and offering charm, character and stylish living accommodation throughout. This property is a must see - arrange your viewing today!





**Ground Floor**

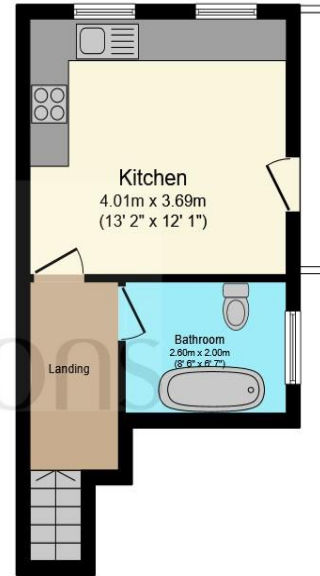

**First Floor**

**Entrance Porch & Hall**

**Lounge**

17' 8" x 16' 1" ( 5.38m x 4.90m )

**Bedroom One**

16' x 13' 1" ( 4.88m x 3.99m )

**Bedroom Two**

11' 11" x 9' ( 3.63m x 2.74m )

**Kitchen**

13' 2" x 12' 1" ( 4.01m x 3.68m )

**Bathroom**

8' 6" x 6' 7" ( 2.59m x 2.01m )

**Garden & Off-Road Parking**

Total floor area 99.2 m<sup>2</sup> (1,068 sq.ft.) approx

This floor plan is for illustrative purposes only. It is not drawn to scale. Any measurements, floor areas (including any total floor area), openings and orientation are approximate. No details are guaranteed, they cannot be relied upon for any purpose and they do not form part of any agreement. No liability is taken for any error, omission or misstatement. A party must rely upon its own inspection(s). Powered by [www.focalagent.com](http://www.focalagent.com)

welcome to

## Park Road, Bexhill-On-Sea

- Two Bedroom Maisonette
- Private Rear Garden
- Directly Opposite Egerton Park
- Spacious Lounge with a Bay Window, Feature Fireplace & Period Charm
- Lower Ground Floor Level

Tenure: Leasehold EPC Rating: D

Council Tax Band: A Service Charge: Ask Agent

Ground Rent: Ask Agent

This is a Leasehold property. We are awaiting further details about the Term of the lease. For further information please contact the branch. Please note additional fees could be incurred for items such as Leasehold packs.

# £270,000



Please note the marker reflects the postcode not the actual property

view this property online [fox-and-sons.co.uk/Property/BOS112913](https://fox-and-sons.co.uk/Property/BOS112913)



Property Ref:  
BOS112913 - 0002

1. MONEY LAUNDERING REGULATIONS Intending purchasers will be asked to produce identification documentation at a later stage and we would ask for your co-operation in order that there is no delay in agreeing the sale. 2. These particulars do not constitute part or all of an offer or contract. 3. The measurements indicated are supplied for guidance only and as such must be considered incorrect. Potential buyers are advised to recheck measurements before committing to any expense. 4. We have not tested any apparatus, equipment, fixtures or services and it is in the buyers interest to check the working condition of any appliances. 5. Where an EPC, or a Home Report (Scotland only) is held for this property, it is available for inspection at the branch by appointment. If you require a printed version of a Home Report, you will need to pay a reasonable production charge reflecting printing and other costs. 6. We are not able to offer an opinion either written or verbal on the content of these reports and this must be obtained from your legal representative. 7. Whilst we take care in preparing these reports, a buyer should ensure that his/her legal representative confirms as soon as possible all matters relating to title including the extent and boundaries of the property and other important matters before exchange of contracts.

fox & sons



01424 224243



BexhillonSea@fox-and-sons.co.uk



1 Devonshire Square, BEXHILL-ON-SEA, East Sussex, TN40 1AB



[fox-and-sons.co.uk](https://fox-and-sons.co.uk)