



**4 Yewtree Close, Durrington Salisbury SP4 8NG**

**welcome to**

## **Yewtree Close, Durrington Salisbury**

Spacious five-bedroom detached home, set in the heart of Durrington in a quiet cul-de-sac. Close to amenities and schools, makes this property a perfect family home.

**Book to View Now!**

### **Auctioneer's Comments**

This property is offered through Modern Method of Auction. Should you view, offer or bid your data will be shared with the Auctioneer, iamsold Limited. This method requires both parties to complete the transaction within 56 days, allowing buyers to proceed with mortgage finance (subject to lending criteria, affordability and survey). The buyer is required to sign a reservation agreement and make payment of a non-refundable Reservation Fee of 4.5% of the purchase price including VAT, subject to a minimum of £6600.00 including VAT. This fee is paid in addition to purchase price and will be considered as part of the chargeable consideration for the property in the calculation for stamp duty liability. Buyers will be required to complete an identification process with iamsold and provide proof of how the purchase would be funded. The property has a Buyer Information Pack containing documents about the property. The documents may not tell you everything you need to know, so you must complete your own due diligence before bidding. A sample of the Reservation Agreement and terms and conditions are contained within this pack. The buyer will also make payment of no more than £349 inc. VAT towards the preparation cost of the pack. Please confirm exact costs with the auctioneer. The estate agent and auctioneer may recommend the services of other providers to you, in which they will be paid for the referral. These services are optional, and you will be advised of any payment, in writing before any services are accepted. Listing is subject to a start price and undisclosed reserve price that can change.

### **Front Garden**

Reinforced with iron girders and sleepers across the front of the property, laid to lawn with idyllic views.

### **Entrance Hall**

Front door has obscured glass. Karndean flooring, radiator, understairs storage.

### **Downstairs Cloakroom**

Tiled flooring, w/c, sink, heated towel rail, extractor fan.

### **Study**

9' 6" x 10' 7" ( 2.90m x 3.23m )

Carpet, radiator, Hammond's built-in cabinets, front aspect double glazed bay window.

### **Lounge**

22' 3" x 13' 1" ( 6.78m x 3.99m )

Carpet flooring, patio doors to garden, front aspect window double glazed, two radiators, gas fireplace, t.v. aerial point.

### **Dining Room**

15' x 13' 1" ( 4.57m x 3.99m )

Karndean flooring, patio doors to garden, two radiators.

### **Reception Room Three**

15' x 8' 7" ( 4.57m x 2.62m )

Carpet, radiator, front aspect double glazed window, t.v. aerial point.

### **Kitchen**

13' x 9' 6" ( 3.96m x 2.90m )

Rear aspect double glazed window, Karndean flooring, peninsular with storage, new five ring gas burner, extractor hood, integrated fridge, radiator, new double electric oven, under unit lighting. Archway to dining room and utility.

### **Utility Room**

5' 9" x 5' 6" ( 1.75m x 1.68m )

Karndean flooring, gas boiler, space for washing machine, dishwasher, tumble dryer, double glazed door to garden.







### **Landing**

Carpet, two storage cupboards (one containing immersion heater), hatch with stairs to a part boarded attic.

### **Bedroom One**

13' 6" x 10' 3" ( 4.11m x 3.12m )

Carpet, radiator, front aspect double glazed bay window with views of the vista, built-in wardrobes, t.v. aerial point.

### **En-Suite**

Refitted: with w/c, sink with vanity, electric power shower, heated towel rail, front aspect double glazed window, extractor fan.

### **Bedroom Two**

15' x 10' 7" ( 4.57m x 3.23m )

Carpet, radiator, built-in wardrobe, rear aspect double glazed window, t.v. aerial point.

### **En-Suite**

Vinyl flooring, rear aspect double glazed window, heated towel rail, w/c, sink with vanity, electric power shower, extractor fan.

### **Bedroom Three**

13' 5" x 10' 9" ( 4.09m x 3.28m )

Carpet, radiator, front aspect double glazed window, array of built-in storage, dressing table and desk.

### **Bedroom Four**

7' 7" x 8' 7" ( 2.31m x 2.62m )

Carpet, radiator, rear aspect double glazed window, built-in desk and storage, built-in over head storage, t.v. aerial point, built-in wardrobe.

### **Bedroom Five**

15' x 8' 9" ( 4.57m x 2.67m )

Carpet, radiator, front aspect double glazed window, built-in wardrobe, wonderful views.

### **Family Bathroom**

Vinyl flooring, rear aspect double glazed window, heated towel rail, w/c, bath with electric power shower, extractor fan, built-in storage.

### **Rear Garden**

Patio area, laid to lawn with three power points for electricity, outside water tap and water feature. Personnel door to double garage. rear access to garden. Pagoda with climbing plants, gate at side for access to the front garden. bin storage and water butt.

### **Double Garage And Driveway**

Power and lighting, part boarded raft storage, built-in workshop and cupboard.



***view this property online*** [fox-and-sons.co.uk/Property/AME105628](http://fox-and-sons.co.uk/Property/AME105628)



welcome to

## Yewtree Close, Durrington Salisbury

- Sale by Modern Auction (T&Cs apply)
- Subject to an undisclosed Reserve Price
- Buyers fees apply
- Five Bedroom Detached Family Home.
- Four Reception Rooms Including Study.

Tenure: Freehold EPC Rating: C

Council Tax Band: E

guide price

**£500,000**

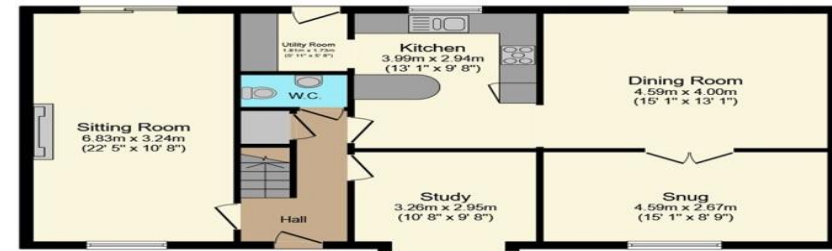

**Ground Floor**

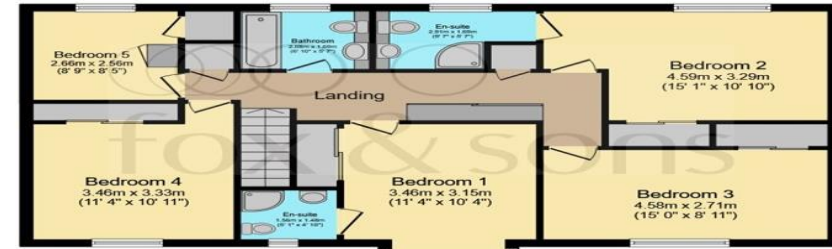

**First Floor**



**Garage**

Total floor area 203.3 m<sup>2</sup> (2,188 sq.ft.) approx

This floorplan is for illustrative purposes only and is not drawn to scale. Measurements, floor-areas, openings and orientations are approximate. They should not be relied upon for any purpose and do not form any part of an agreement. No liability is taken for any error or mis-statement. All parties must rely on their own inspections.

view this property online [fox-and-sons.co.uk/Property/AME105628](https://fox-and-sons.co.uk/Property/AME105628)



Property Ref:  
AME105628 - 0008

1. MONEY LAUNDERING REGULATIONS Intending purchasers will be asked to produce identification documentation at a later stage and we would ask for your co-operation in order that there is no delay in agreeing the sale. 2. These particulars do not constitute part or all of an offer or contract. 3. The measurements indicated are supplied for guidance only and as such must be considered incorrect. Potential buyers are advised to recheck measurements before committing to any expense. 4. We have not tested any apparatus, equipment, fixtures or services and it is in the buyers interest to check the working condition of any appliances. 5. Where an EPC, or a Home Report (Scotland only) is held for this property, it is available for inspection at the branch by appointment. If you require a printed version of a Home Report, you will need to pay a reasonable production charge reflecting printing and other costs. 6. We are not able to offer an opinion either written or verbal on the content of these reports and this must be obtained from your legal representative. 7. Whilst we take care in preparing these reports, a buyer should ensure that his/her legal representative confirms as soon as possible all matters relating to title including the extent and boundaries of the property and other important matters before exchange of contracts.



**01980 624155**



[Amesbury@fox-and-sons.co.uk](mailto:Amesbury@fox-and-sons.co.uk)



49 Salisbury Street, AMESBURY, Wiltshire, SP4 7AW



[fox-and-sons.co.uk](https://fox-and-sons.co.uk)