



69 Princess Way, Amesbury Salisbury SP4 7GH

welcome to

Princess Way, Amesbury Salisbury

Four- bedroom, detached, family home in the popular Kings Gate development. High specification throughout for modern living.

Book now to view this beautiful home!



Front

Driveway and garage with electrics and lighting.

Entrance Hall

Amtico flooring, purpose built, under-stairs storage, Google thermostat on the lower level of the house.

Downstairs Cloakroom

W/c, sink, radiator, Amtico flooring.

Lounge

20' 1" x 11' 5" (6.12m x 3.48m)

Amtico flooring, French door to garden, front aspect double glazed window.

Kitchen

21' 8" x 10' 8" (6.60m x 3.25m)

Amtico flooring, electric induction hob, extractor hood, vertical radiator, dual aspect double glazed windows, integrated dishwasher, fridge/freezer, double oven.

Utility Room

7' x 4' 9" (2.13m x 1.45m)

Amtico flooring, space for washing machine and tumble dryer, combi boiler, back door to garden.

Landing

Carpet, airing cupboard, hatch to attic.

Bedroom One

11' 9" x 10' 8" (3.58m x 3.25m)

Carpet, built-in wardrobes, radiator, rear aspect double glazed window.

En-Suite

Rear aspect double-glazed window, vinyl flooring, shower, sink with vanity, w/c, heated towel rail.

Bedroom Two

11' x 11' 10" (3.35m x 3.61m)

Front aspect double glazed window, radiator.

Bedroom Three

10' 11" x 8' 9" (3.33m x 2.67m)

Carpet, radiator, rear aspect double glazed window.

Bedroom Four

9' 3" x 8' 4" (2.82m x 2.54m)

Carpet, radiator, front aspect double glazed window.

Family Bathroom

Vinyl flooring, front aspect double glazed window, heated towel rail, bath with shower attachment, w/c, sink, separate shower cubicle.

Rear Garden

Laid to lawn with patio area, outside water tap and outside wall unit where electrics can be connected, side access to garage and driveway.



Ground Floor

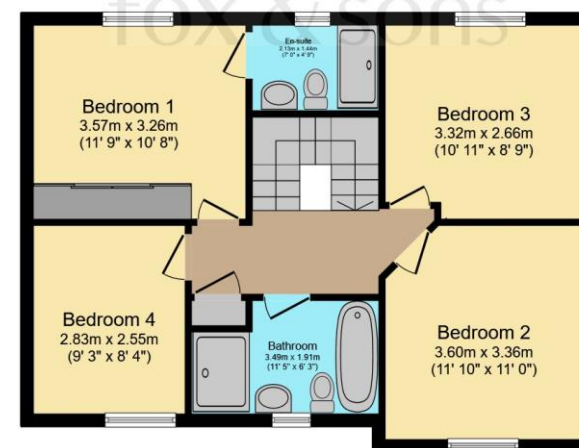

First Floor

Total floor area 123.5 m² (1,329 sq.ft.) approx

This floorplan is for illustrative purposes only and is not drawn to scale. Measurements, floor-areas, openings and orientations are approximate. They should not be relied upon for any purpose and do not form any part of an agreement. No liability is taken for any error or mis-statement. All parties must rely on their own inspections.



view this property online fox-and-sons.co.uk/Property/AME105587



welcome to

Princess Way, Amesbury Salisbury

- Detached Four-Bedroom Family Home
- Approx. 1,329 sq.ft.
- High Specification Throughout
- Close to Schools, Amenities and Public Transport
- Tax Band E

Tenure: Freehold EPC Rating: B

£465,000



Please note the marker reflects the postcode not the actual property

view this property online fox-and-sons.co.uk/Property/AME105587



Property Ref:
AME105587 - 0005

1. MONEY LAUNDERING REGULATIONS Intending purchasers will be asked to produce identification documentation at a later stage and we would ask for your co-operation in order that there is no delay in agreeing the sale. 2. These particulars do not constitute part or all of an offer or contract. 3. The measurements indicated are supplied for guidance only and as such must be considered incorrect. Potential buyers are advised to recheck measurements before committing to any expense. 4. We have not tested any apparatus, equipment, fixtures or services and it is in the buyers interest to check the working condition of any appliances. 5. Where an EPC, or a Home Report (Scotland only) is held for this property, it is available for inspection at the branch by appointment. If you require a printed version of a Home Report, you will need to pay a reasonable production charge reflecting printing and other costs. 6. We are not able to offer an opinion either written or verbal on the content of these reports and this must be obtained from your legal representative. 7. Whilst we take care in preparing these reports, a buyer should ensure that his/her legal representative confirms as soon as possible all matters relating to title including the extent and boundaries of the property and other important matters before exchange of contracts.

Fox & Sons is a trading name of Sequence (UK) Limited which is registered in England and Wales under company number 4268443, Registered Office is Cumbria House, 16-20 Hockliffe Street, Leighton Buzzard, Bedfordshire, LU7 1GN. VAT Registration Number is 500 2481 05.



fox & sons



01980 624155



Amesbury@fox-and-sons.co.uk



49 Salisbury Street, AMESBURY, Wiltshire, SP4 7AW



fox-and-sons.co.uk