

property details **approval form**

14 Akeman Close, Stretham, Ely, Cambridgeshire, England, CB6 3JR

Date: 01 November 2024

Property Ref and Version: ELY109334 - 0004

selling your home with us!



>> **let's get your property sold!**

After visiting your property we have compiled this document to show you all of the information we have gathered, including all images. We just need you to review this document to make sure everything we say in here is accurate before we officially begin marketing your home.

What is covered in this marketing approval form:

- | | |
|----------------------|---------------------|
| 1. Price | 5. Room Description |
| 2. Key Features | 6. Directions |
| 3. Short Description | 7. Property Images |
| 4. Long Description | 8. Floor Plan |

The information within this document will be used within our property particulars and on the internet; the format of how this information is displayed may be subject to change.

property details **approval form**

14 Akeman Close, Stretham, Ely, Cambridgeshire, England, CB6 3JR

Date: 01 November 2024

Property Ref and Version: ELY109334 - 0004

>> **price**

offers in excess of £220,000

Tenure: Freehold

>> **key features**

- > TERRACED HOUSE
- > VILLAGE LOCATION
- > TWO BEDROOMS
- > DRIVEWAY
- > NO ONWARD CHAIN
- > EPC Rating: C

>> **short description**

OFFERED WITH NO ONWARD CHAIN..... TWO BEDROOM TERRACED HOUSE IN THE VILLAGE OF STRETHAM. PERFECT FOR FIRST TIME BUYERS OR AN INVESTMENT. DON'T MISS OUT, CALL NOW TO VIEW.....

>> **long description**

Two Bedroom End Terraced House located in Stretham. The property comprises:

Entrance Hall with storage cupboard and stairs to first floor. Doors leading to...

The Kitchen is fitted with a range of wall and base units, with space for cooker & white goods and window to front.

The Lounge is a good size and has a window and sliding doors to the rear garden,

On the first floor Bedroom One has fitted storage cupboards and window to the rear. Bedroom Two & Bathroom.

property details **approval form**

14 Akeman Close, Stretham, Ely, Cambridgeshire, England, CB6 3JR

Date: 01 November 2024

Property Ref and Version: ELY109334 - 0004

Outside to the front of the property there is a private driveway and garden which is laid to lawn. To the rear the garden is mainly laid to lawn with a patio area & garden shed.

NO ONWARD CHAIN!!!!

Stretham is a village and civil parish 4 miles south-south-west of Ely and approx. 12 miles from Cambridge.

Ely is a cathedral city and civil parish in the East Cambridgeshire district of Cambridgeshire, England, about 14 miles north-northeast of Cambridge, 24 miles south east of Peterborough and 80 miles from London.

>> **directions**

>> **Agent Note**

property details **approval form**

14 Akeman Close, Stretham, Ely, Cambridgeshire, England, CB6 3JR

Date: 01 November 2024

Property Ref and Version: ELY109334 - 0004

>> **room description**

Entrance Hall

Kitchen

9' 8" x 7' 9" (2.95m x 2.36m)

Lounge

16' 7" x 11' 2" (5.05m x 3.40m)

Bedroom One

14' 1" x 8' 5" (4.29m x 2.57m)

Bedroom Two

10' 8" x 7' 9" (3.25m x 2.36m)

Bathroom

Outbuilding

12' 5" x 8' 5" (3.78m x 2.57m)

property details **approval form**

14 Akeman Close, Stretham, Ely, Cambridgeshire, England, CB6 3JR

Date: 01 November 2024

Property Ref and Version: ELY109334 - 0004

>> **room description**

property details **approval form**

14 Akeman Close, Stretham, Ely, Cambridgeshire, England, CB6 3JR

Date: 01 November 2024

Property Ref and Version: ELY109334 - 0004

>> **room description**

property details approval form

14 Akeman Close, Stretham, Ely, Cambridgeshire, England, CB6 3JR

Date: 01 November 2024

Property Ref and Version: ELY109334 - 0004

>> property images



Your William H Brown office: 6 Forehill, ELY, Cambridgeshire, CB7 4AF
T 01353 663311 E ely@williamhbrown.co.uk

property details **approval form**

14 Akeman Close, Stretham, Ely, Cambridgeshire, England, CB6 3JR

Date: 01 November 2024

Property Ref and Version: ELY109334 - 0004

>> **property images**



property details **approval form**

14 Akeman Close, Stretham, Ely, Cambridgeshire, England, CB6 3JR

Date: 01 November 2024

Property Ref and Version: ELY109334 - 0004

>> property images

property details approval form

14 Akeman Close, Stretham, Ely, Cambridgeshire, England, CB6 3JR

Date: 01 November 2024

Property Ref and Version: ELY109334 - 0004

>> floor plan

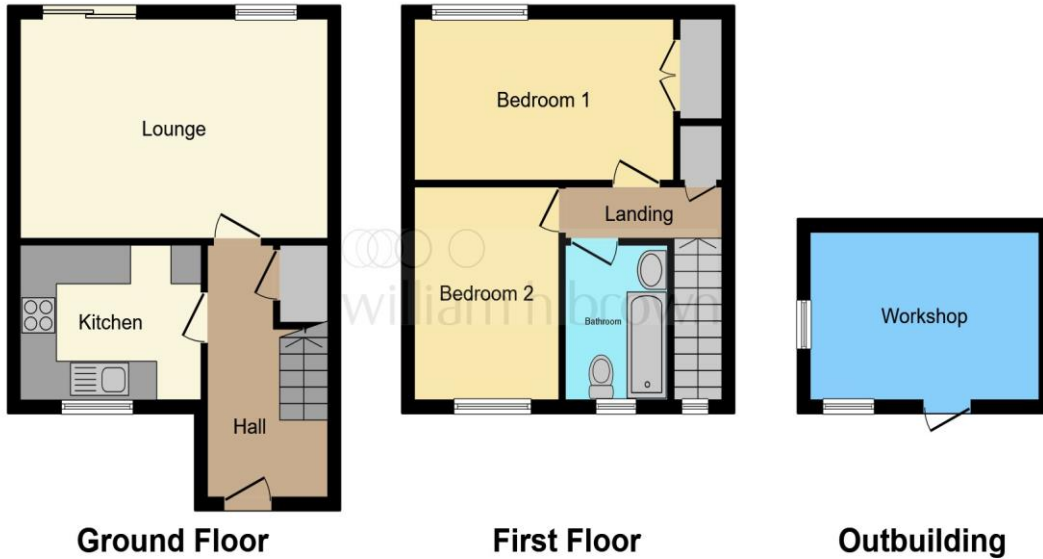

This floor plan is for illustrative purposes only. It is not drawn to scale. Any measurements, floor areas (including any total floor area), openings and orientation are approximate. No details are guaranteed, they cannot be relied upon for any purpose and they do not form part of any agreement. No liability is taken for any error, omission or misstatement. A party must rely upon its own inspection(s). Powered by www.focalagent.com

>> approval

	Signature	Date
Bradley Stratton	<i>B.STRATTON</i>	01/11/2024
Mr C. Adams		

Your William H Brown office: 6 Forehill, ELY, Cambridgeshire, CB7 4AF

T 01353 663311 E ely@williamhbrown.co.uk

0

RESI/CON016/18