



Meadowsweet, Walnut Tree MILTON KEYNES MK7 7BP

welcome to

Meadowsweet, Walnut Tree MILTON KEYNES

Excellent THREE/ FOUR bedroom DETACHED property situated in the popular area of Walnut Tree. Features OFF ROAD PARKING FOR SEVERAL CARS, GARAGE and REAR GARDEN. One not to be missed, viewing is highly recommended!

Entrance Hall

Double-glazed door to the front, tiled floor, hooks for hanging coats, fuse board & door to the living room.

Living Room

14' 6" x 9' 10" (4.42m x 3.00m)

Double-glazed window to the front aspect, laminate flooring, TV & telephone points, radiator, and door to the kitchen/ breakfast room and entrance hall.

Kitchen / Breakfast Room

14' 4" x 10' 11" (4.37m x 3.33m)

Double-glazed window & door with additional side window to the rear aspect. Fitted with a range of units at base & eye level with solid laminate work surfaces. Central island with solid laminate work surface & breakfast bar, with 6 ring gas hob, oven and side storage. Stainless steel sink and drainer unit with chrome mixer taps, tiled splashbacks. Dishwasher & integrated fridge freezer. Triple pendant lighting. Radiator. Pantry storage. Doors to rear lobby and stairs rising to the first floor.

Rear Lobby

Doors to dining room/bedroom four, shower room & garage.

Shower Room

Electric power shower in corner shower enclosure, partly tiled, vinyl floor tiled, electric heater, extractor fan, wick and hand wash basin.

Dining Room / Bedroom Four

7' 4" x 10' 1" (2.24m x 3.07m)

Double-glazed window to the rear, built-in storage, radiator and laminate flooring.

Landing

Double-glazed frosted window to the side, carpeted, access to the boarded loft space, and doors to bedrooms one, two, three and family shower room.

Bedroom One

9' 9" x 8' 1" (2.97m x 2.46m)

Double-glazed window the front, carpeted, alcove storage area, and radiator.

Bedroom Two

10' 1" x 8' 1" (3.07m x 2.46m)

Double-glazed window to the rear, alcove storage area, carpeted, radiator, and door to the airing cupboard.

Bedroom Three

6' 1" x 6' 9" (1.85m x 2.06m)

Double-glazed window to the front, laminate flooring, and radiator.

Family Shower Room

Double walk-in glass shower enclosure with electric power shower, chrome wall towel radiator, panelled splashbacks, vanity with basin with chrome mixer taps & storage cupboards, wick and melamine flooring

Outside

Front

Fully block paved driveway offering off-road parking for up to six vehicles leading to the front door, garage and side gate.

Rear Garden

Enclosed wood panel fencing. Sandstone patio entertaining area partially covered. Partly laid to lawn leading to additional patio. shed, water tap & side gate access.

Garage

13' 2" x 7' 10" (4.01m x 2.39m)

With Up & Over door, partly converted to storage area with electric, power sockets and plumbing for washing machine, eaves storage and door to rear lobby.

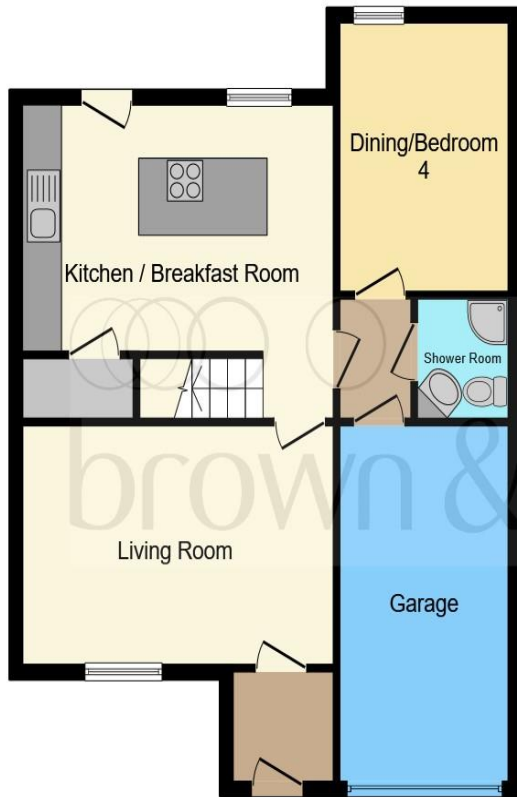

Ground Floor

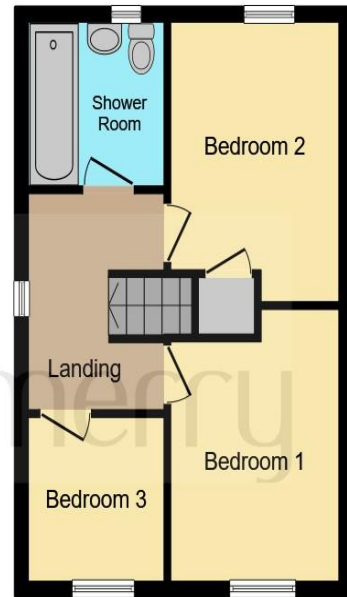

First Floor

This floor plan is for illustrative purposes only. It is not drawn to scale. Any measurements, floor areas (including any total floor area), openings and orientation are approximate. No details are guaranteed, they cannot be relied upon for any purpose and they do not form part of any agreement. No liability is taken for any error, omission or misstatement. A party must rely upon its own inspection(s). Powered by www.focalagent.com



welcome to

Meadowsweet,

Walnut Tree MILTON KEYNES

- THREE/ FOUR BEDROOM DETACHED
- DRIVEWAY PROVIDING PARKING FOR UP TO 6 VEHICLES
- POPULAR LOCATION
- KITCHEN/BREAKFAST ROOM
- DINING ROOM / BEDROOM FOUR

Tenure: Freehold EPC Rating: D

£395,000



view this property online [brownmerry.co.uk/Property/WOS104946](https://www.brownmerry.co.uk/Property/WOS104946)



Property Ref:
WOS104946 - 0012

1. MONEY LAUNDERING REGULATIONS Intending purchasers will be asked to produce identification documentation at a later stage and we would ask for your co-operation in order that there is no delay in agreeing the sale. 2. These particulars do not constitute part or all of an offer or contract. 3. The measurements indicated are supplied for guidance only and as such must be considered incorrect. Potential buyers are advised to recheck measurements before committing to any expense. 4. We have not tested any apparatus, equipment, fixtures or services and it is in the buyers interest to check the working condition of any appliances. 5. Where an EPC, or a Home Report (Scotland only) is held for this property, it is available for inspection at the branch by appointment. If you require a printed version of a Home Report, you will need to pay a reasonable production charge reflecting printing and other costs. 6. We are not able to offer an opinion either written or verbal on the content of these reports and this must be obtained from your legal representative. 7. Whilst we take care in preparing these reports, a buyer should ensure that his/her legal representative confirms as soon as possible all matters relating to title including the extent and boundaries of the property and other important matters before exchange of contracts.

Brown & Merry is a trading name of Sequence (UK) Limited which is registered in England and Wales under company number 4268443, Registered Office is Cumbria House, 16-20 Hockliffe Street, Leighton Buzzard, Bedfordshire, LU7 1GN. VAT Registration Number is 500 2481 05.

brown & merry



01908 583231



WoburnSands@brownmerry.co.uk



9 High Street, Woburn Sands, MILTON KEYNES,
Buckinghamshire, MK17 8RG



brownmerry.co.uk