



**ELM TREE WALK**  
**TRING, HERTFORDSHIRE HP23 5EB**



# ELM TREE WALK

GUIDE PRICE

£375,000

FREEHOLD

TRING. HERTFORDSHIRE HP23 5EB

**This well-proportioned family home is conveniently located close to schools and neighbourhood shops and within a short walk to the town centre. The property which is in need of some updating, is offered with no upper chain.**

The porch opens to an entrance hall with a cloakroom and a spacious lounge/dining room with patio doors leading to the garden.

The kitchen has fitted cupboards and space for a cooker, fridge and washing machine.

Moving upstairs and the three well-proportioned bedrooms offer space with two double rooms, both with fitted wardrobes, and a good size single. There is a family bathroom complete with walk in shower room with wash hand basin, WC and shower.

Outside there is a footpath leading to the front door, a paved garden with flower borders. The rear garden is low maintenance, mature shrubs and flower beds.

There is a detached garage in a block.

Tring is an attractive market town on the northern edge of the Chilterns and is surrounded by countryside. The A41 by-pass gives access to the M25 and for the commuter there is a fast and frequent train service to London Euston averaging 40 minutes. The town centre provides a mix of specialist and day-to-day shopping facilities including Marks & Spencer, Simply Food, Tesco, butchers, newsagents, Costa Coffee and the popular Akeman restaurant as well as many other places to eat. The Charter Market is held on Fridays and there is a Farmers Market which takes place on 2<sup>nd</sup> and 4<sup>th</sup> Saturdays. There is a good choice of private and state schools including Tring School & Tring Park School for Performing Arts. Nearby Berkhamsted also offers a choice of preparatory and public schools.









## Ground Floor

Approx. 37.0 sq. metres (398.6 sq. feet)

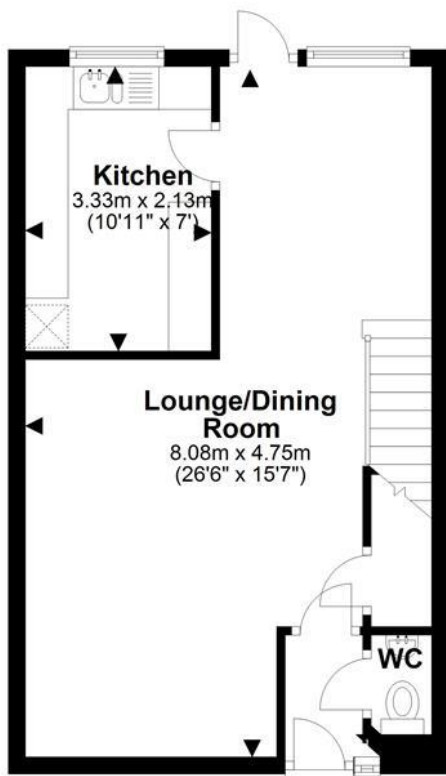

## First Floor

Approx. 40.1 sq. metres (431.9 sq. feet)

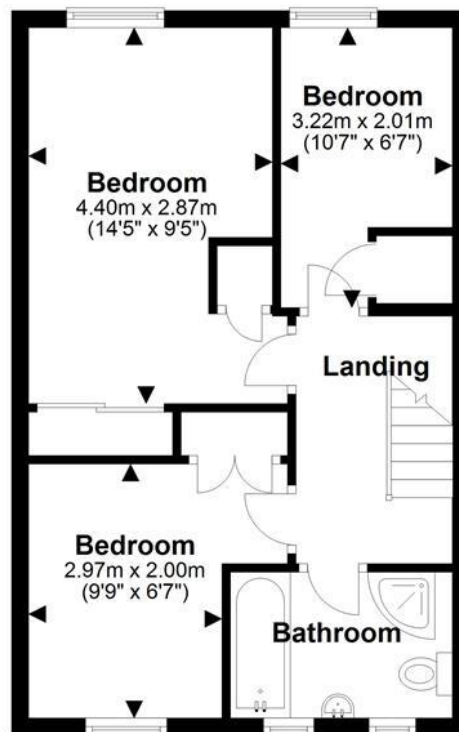

Total area: approx. 77.2 sq. metres (830.5 sq. feet)

Disclaimer - Floor plan is for marketing purposes only and is to be used as a guide - SKM Studio  
Plan produced using PlanUp.

TRG108594 – Version 3  
EPC rating – C Council Tax Band - C



01442 824133

[tring@brownandmerry.co.uk](mailto:tring@brownandmerry.co.uk)

41 High Street, Tring, Herts, HP23 5AA

[www.brownandmerry.co.uk](http://www.brownandmerry.co.uk)

1. MONEY LAUNDERING REGULATIONS Intending purchasers will be asked to produce identification documentation at a later stage and we would ask for your co-operation in order that there is no delay in agreeing the sale. 2. These particulars do not constitute part or all of an offer or contract. 3. The measurements indicated are supplied for guidance only and as such must be considered incorrect. Potential buyers are advised to recheck measurements before committing to any expense. 4. We have not tested any apparatus, equipment, fixtures or services and it is in the buyers interest to check the working condition of any appliances. 5. Where an EPC, or a Home Report (Scotland only) is held for this property, it is available for inspection at the branch by appointment. If you require a printed version of a Home Report, you will need to pay a reasonable production charge reflecting printing and other costs. 6. We are not able to offer an opinion either written or verbal on the content of these reports and this must be obtained from your legal representative. 7. Whilst we take care in preparing these reports, a buyer should ensure that his/her legal representative confirms as soon as possible all matters relating to title including the extent and boundaries of the property and other important matters before exchange of contracts.

Brown & Merry is a trading name of Sequence (UK) Limited which is registered in England and Wales under company number 4268443, Registered Office is Cumbria House, 16-20 Hockliffe Street, Leighton Buzzard, Bedfordshire, LU7 1GN. VAT Registration Number is 500 2481 05.

