



Essenden Court, Stony Stratford, Milton Keynes, MK11 1NW

welcome to

Essenden Court, Stony Stratford, Milton Keynes

Situated in GALLEY HILL area of Milton Keynes and with NO UPPER CHAIN with living/dining room, kitchen, utility room, three bedrooms, family bathroom, driveway and SINGLE GARAGE. The property has had some renovating work done which includes a modern boiler, refitted kitchen and new carpets.

Porch:

Entrance Hall:

Enter via composite door to entrance hall. Entrance hall has doors leading to all ground floor accommodation and stairs rising to the first floor landing.

Kitchen:

8' 6" x 7' 7" (2.59m x 2.31m)

A brand new kitchen which has been recently refitted. The kitchen has a range of eye and base level units with worktop surfaces, stainless steel sink with mixer tap over, tiled splashback, integral electric oven with extractor hood over, four ring gas hob and space for various utilities. There is a double glazed window to the rear aspect and an opening into the living/dining room.

Living / Dining Room:

21' x 10' 2" (6.40m x 3.10m)

Double glazed patio doors to the rear aspect, double glazed window to the front aspect, newly laid carpet flooring and radiator.

Utility Room:

10' 6" x 5' 3" (3.20m x 1.60m)

Storage units with a sink and space for various utility items. Window to the front aspect.

Landing:

Doors to all First floor accommodation and access to the loft via a loft void.

Bedroom One:

11' x 10' 2" (3.35m x 3.10m)

Carpet flooring, radiator and window to the front aspect.

Bedroom Two:

10' 2" x 10' (3.10m x 3.05m)

Carpet floor, storage cupboard, radiator and window to the rear aspect.

Bedroom Three:

8' 6" x 7' 7" (2.59m x 2.31m)

Carpet floor, radiator and window to the rear aspect.

Bathroom:

8' 6" x 6' 7" (2.59m x 2.01m)

Frosted window to the front aspect, panelled bathtub, wash hand basin and WC.





**Outside:
Garden:**

Enclosed by timber panel fencing with a gated entrance to the single garage. The garden is mainly laid to lawn and has a patio area.

Parking:

There is a drive way for several vehicles with further gated parking and access to the single garage.

Single Garage:

The garage has an up and over door.



view this property online brownandmerry.co.uk/Property/STS107250



welcome to

Essenden Court, Stony Stratford, Milton Keynes

- NO UPPER CHAIN
- THREE BEDROOM SEMI-DETACHED
- LIVING/REFITTED KITCHEN WITH MODERN BOILER
- NEW ROOF, RADIATORS, DOORS, WINDOWS AND ELECTRIC BOARD
- DRIVEWAY PROVIDING PARKING

Tenure: Freehold EPC Rating: E

guide price

£325,000

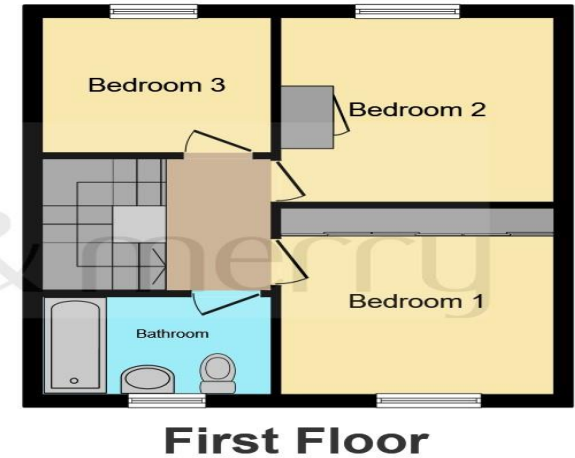

This floor plan is for illustrative purposes only. It is not drawn to scale. Any measurements, floor areas (including any total floor area), openings and orientation are approximate. No details are guaranteed, they cannot be relied upon for any purpose and they do not form part of any agreement. No liability is taken for any error, omission or misstatement. A party must rely upon its own inspection(s). Powered by www.focalagent.com

view this property online brownandmerry.co.uk/Property/STS107250



Property Ref:
STS107250 - 0005

1. MONEY LAUNDERING REGULATIONS Intending purchasers will be asked to produce identification documentation at a later stage and we would ask for your co-operation in order that there is no delay in agreeing the sale. 2. These particulars do not constitute part or all of an offer or contract. 3. The measurements indicated are supplied for guidance only and as such must be considered incorrect. Potential buyers are advised to recheck measurements before committing to any expense. 4. We have not tested any apparatus, equipment, fixtures or services and it is in the buyers interest to check the working condition of any appliances. 5. Where an EPC, or a Home Report (Scotland only) is held for this property, it is available for inspection at the branch by appointment. If you require a printed version of a Home Report, you will need to pay a reasonable production charge reflecting printing and other costs. 6. We are not able to offer an opinion either written or verbal on the content of these reports and this must be obtained from your legal representative. 7. Whilst we take care in preparing these reports, a buyer should ensure that his/her legal representative confirms as soon as possible all matters relating to title including the extent and boundaries of the property and other important matters before exchange of contracts.

Brown & Merry is a trading name of Sequence (UK) Limited which is registered in England and Wales under company number 4268443, Registered Office is Cumbria House, 16-20 Hockliffe Street, Leighton Buzzard, Bedfordshire, LU7 1GN. VAT Registration Number is 500 2481 05.

brown & merry



01908 562011



stonystatford@brownandmerry.co.uk



65 High Street, MILTON KEYNES,
Buckinghamshire, MK11 1AY



brownandmerry.co.uk

