



Hesketh Road, Yardley Gobion Towcester NN12 7TS

welcome to

Hesketh Road, Yardley Gobion Towcester

Nestled in the sought after village of Yardley Gobion, this delightful THREE bedroom, SEMI-DETACHED property offers spacious and versatile living, perfect for families and well connected location. This fantastic home is not to be missed. Contact us today to arrange a viewing!

Entrance Hall:

Radiator.

Sitting Room:

15' 3" x 10' 7" (4.65m x 3.23m)

Fireplace with hearth and surround, radiator, double glazed bay window to front aspect and double glazed window to side aspect.

Kitchen/Diner:

15' 2" Max x 14' 4" Max (4.62m Max x 4.37m Max)

Fitted with a range of units to both base and eye level with worksurface over, stainless steel sink with mixer taps over, built in double oven, gas hob, space for washing machine, fridge and freezer, radiator and double glazed window to side aspect.

Diner/Family Room

15' 5" Max x 6' 9" (4.70m Max x 2.06m)

Double glazed windows to side and rear aspect, double glazed French doors to garden and radiator.

Landing:

Doors to all rooms:

Bedroom One:

12' Max x 11' 2" (3.66m Max x 3.40m)

Double glazed window to rear aspect, built in wardrobes and radiator.

Bedroom Two:

11' Max x 11' 3" Max (3.35m Max x 3.43m Max)

Double glazed window to front aspect and radiator.

Bedroom Three:

6' 3" x 8' 3" Max (1.91m x 2.51m Max)

Double glazed window to front aspect and radiator.

Bathroom:

Suite comprising: Bath with electric shower over, WC, wash hand basin, shaver point, radiator and double glazed window to rear aspect.

Outside:

Front:

Low wall with mature shrubs and path and driveway providing off road parking for four cars and leading to entrance door.

Single Garage:

Rear:

With a grass and paved area, leading to garage.



Ground Floor

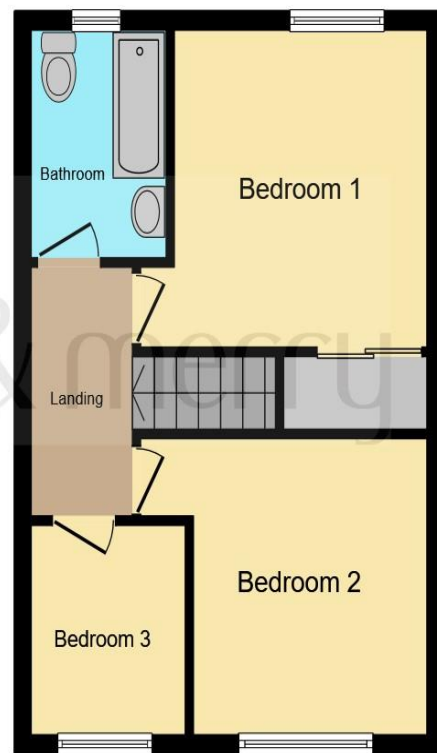

First Floor

This floor plan is for illustrative purposes only. It is not drawn to scale. Any measurements, floor areas (including any total floor area), openings and orientation are approximate. No details are guaranteed, they cannot be relied upon for any purpose and they do not form part of any agreement. No liability is taken for any error, omission or misstatement. A party must rely upon its own inspection(s). Powered by www.focalagent.com



welcome to
Hesketh Road,
Yardley Gobion Towcester

- THREE BEDROOM SEMI-DETACHED
- EXTENDED TO THE REAR
- DRIVEWAY FOR MULTIPLE VEHICLES
- SINGLE GARAGE
- VILLAGE LOCATION

Tenure: Freehold EPC Rating: D
Council Tax Band: C

£325,000



view this property online [brownandmerry.co.uk/Property/STS108165](https://www.brownandmerry.co.uk/Property/STS108165)



Property Ref:
STS108165 - 0004

1. MONEY LAUNDERING REGULATIONS Intending purchasers will be asked to produce identification documentation at a later stage and we would ask for your co-operation in order that there is no delay in agreeing the sale. 2. These particulars do not constitute part or all of an offer or contract. 3. The measurements indicated are supplied for guidance only and as such must be considered incorrect. Potential buyers are advised to recheck measurements before committing to any expense. 4. We have not tested any apparatus, equipment, fixtures or services and it is in the buyers interest to check the working condition of any appliances. 5. Where an EPC, or a Home Report (Scotland only) is held for this property, it is available for inspection at the branch by appointment. If you require a printed version of a Home Report, you will need to pay a reasonable production charge reflecting printing and other costs. 6. We are not able to offer an opinion either written or verbal on the content of these reports and this must be obtained from your legal representative. 7. Whilst we take care in preparing these reports, a buyer should ensure that his/her legal representative confirms as soon as possible all matters relating to title including the extent and boundaries of the property and other important matters before exchange of contracts.

Brown & Merry is a trading name of Sequence (UK) Limited which is registered in England and Wales under company number 4268443, Registered Office is Cumbria House, 16-20 Hockliffe Street, Leighton Buzzard, Bedfordshire, LU7 1GN. VAT Registration Number is 500 2481 05.

brown & merry



01908 562011



stonystatford@brownandmerry.co.uk



65 High Street, MILTON KEYNES,
Buckinghamshire, MK11 1AY



[brownandmerry.co.uk](https://www.brownandmerry.co.uk)