



**Fortune Street, Brooklands Milton Keynes MK10 7NJ**

**welcome to**

## **Fortune Street, Brooklands Milton Keynes**

Situated within the popular and modern Brooklands development stands this MID-TERRACE FAMILY HOME. Being close to amenities, Milton Keynes Coach Way and the M1 motorway this well presented property benefits from downstairs CLOAKROOM, EN-SUITE and FAMILY BATHROOM, ROOF TERRACE, GARDEN and PARKING.

### **Kitchen/ Diner:**

17' 6" x 12' 6" ( 5.33m x 3.81m )  
UPVC Composite door to front entrance. Double glazed window to front. Range of modern gloss fitted kitchen storage units at base and eye level. Integrated fridge/freezer, integrated dishwasher. Kitchen peninsula with breakfast bar overhang. Fitted electric oven, induction hob and floating stainless steel chimney style extractor fan. 1.5 stainless steel sink. Wood effect work surfaces with uplift and wood effect flooring. Open plan area with space for dining table and chairs. Two radiators. Recessing lighting and tiled splash-back surround.

### **Cloakroom:**

WC. Pedestal wash hand basin. Radiator.

### **Inner Hallway:**

Door leading to rear garden. Doors to cloakroom and storage cupboard. Wood effect flooring. Stairs to the first floor landing.

### **First Floor Lounge:**

17' 10" x 10' 11" ( 5.44m x 3.33m )  
Dual aspect room with double glazed windows to front and rear aspect. Carpet to floor, radiator

### **First Floor Landing:**

Double glazed window to the side aspect. Staircase window. Radiator. Carpet to flooring. Airing cupboard housing washing machine. Stairs to the second floor landing.

### **Bedroom One:**

13' 3" x 12' 6" ( 4.04m x 3.81m )  
Double glazed window to the front. Radiator. Built in wardrobe. Door to en-suite shower room.

### **En-Suite Shower Room:**

WC. Heated towel rail. Extractor fan. Large walk in shower cubicle. Inset wash hand basin with mixer tap. Partly tiled walls. Fitted wall mirror. Electric shaver point.

### **Bedroom Two:**

11' 10" x 10' 11" ( 3.61m x 3.33m )  
Double glazed door to Balcony to the front aspect, double glazed window to rear, carpet radiator.

### **Bedroom Three:**

11' 10" x 10' 11" ( 3.61m x 3.33m )  
Double glazed window to front aspect, carpet, radiator.

### **Bathroom:**

Paneled bath with glass screen electric shower, Inset wash hand basin with mixer tap. Partly tiled walls. Fitted wall mirror. Heated towel rail. Electric Shaver point.

### **Rear Garden:**

Mostly laid to artificial lawn with patio area, side gate into carport.

### **Carport:**

Parking for two cars and Gate leading to rear garden.



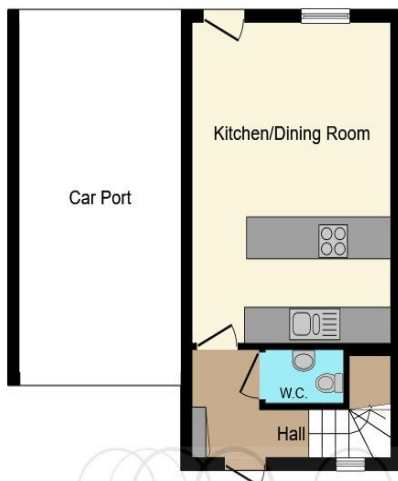

**Ground Floor**



**Second Floor**



**First Floor**

This floor plan is for illustrative purposes only. It is not drawn to scale. Any measurements, floor areas (including any total floor area), openings and orientation are approximate. No details are guaranteed, they cannot be relied upon for any purpose and they do not form part of any agreement. No liability is taken for any error, omission or misstatement. A party must rely upon its own inspection(s). Powered by [www.focalagent.com](http://www.focalagent.com)



**welcome to**  
**Fortune Street,**  
**Brooklands Milton Keynes**

- MID-TERRACE FAMILY HOME
- THREE BEDROOMS
- EN-SUITE AND FAMILY BATHROOM
- KITCHEN/DINER
- ROOF TERRACE, GARDEN and PARKING

Tenure: Freehold EPC Rating: B  
Council Tax Band: D

guide price  
**£425,000**



**view this property online** [brownandmerry.co.uk/Property/NPL107659](https://www.brownandmerry.co.uk/Property/NPL107659)



Property Ref:  
NPL107659 - 0004

1. MONEY LAUNDERING REGULATIONS Intending purchasers will be asked to produce identification documentation at a later stage and we would ask for your co-operation in order that there is no delay in agreeing the sale. 2. These particulars do not constitute part or all of an offer or contract. 3. The measurements indicated are supplied for guidance only and as such must be considered incorrect. Potential buyers are advised to recheck measurements before committing to any expense. 4. We have not tested any apparatus, equipment, fixtures or services and it is in the buyers interest to check the working condition of any appliances. 5. Where an EPC, or a Home Report (Scotland only) is held for this property, it is available for inspection at the branch by appointment. If you require a printed version of a Home Report, you will need to pay a reasonable production charge reflecting printing and other costs. 6. We are not able to offer an opinion either written or verbal on the content of these reports and this must be obtained from your legal representative. 7. Whilst we take care in preparing these reports, a buyer should ensure that his/her legal representative confirms as soon as possible all matters relating to title including the extent and boundaries of the property and other important matters before exchange of contracts.

Brown & Merry is a trading name of Sequence (UK) Limited which is registered in England and Wales under company number 4268443, Registered Office is Cumbria House, 16-20 Hockliffe Street, Leighton Buzzard, Bedfordshire, LU7 1GN. VAT Registration Number is 500 2481 05.

  
**brown & merry**



**01908 611242**



[newportpagnell@brownandmerry.co.uk](mailto:newportpagnell@brownandmerry.co.uk)



74A High Street, Newport Pagnell, MILTON  
KEYNES, Buckinghamshire, MK16 8AQ



**[brownandmerry.co.uk](https://www.brownandmerry.co.uk)**