



Nicholas Mead, Great Linford Milton Keynes MK14 5EL

welcome to

Nicholas Mead, Great Linford Milton Keynes

Standing on a CORNER PLOT at the bottom of a quiet CUL-DE-SAC stands this end of terraced family home. The property boasts SEPARATE RECEPTION ROOMS, UTILITY and CLOAKROOM, WELL PROPORTIONED BEDROOMS, ENCLOSED REAR GARDEN and DOUBLE LENGTH SINGLE GARAGE.

Entrance Porch:

Entrance via double glazed Upvc door, storage cupboard.

Entrance Hall:

Double glazed front door to property leading to family room, door to under stairs storage cupboard.

Cloakroom:

Fitted with a suite to comprise; Wash hand basin and w.c. Double glazed window to front aspect, wood laminate flooring.

Lounge:

21' 6" max x 13' 6" max (6.55m max x 4.11m max)
Two double glazed windows to side aspect, fireplace, wood laminate flooring, T.V. point, radiator, stairs rising to first floor landing, double doors to garden.

Dining Room:

14' 1" max x 9' 5" max (4.29m max x 2.87m max)
Doors from entrance hall, lounge leading to dining room and doors leading to conservatory, wood laminate flooring, radiator.

Kitchen:

11' 6" max x 8' 1" max (3.51m max x 2.46m max)
Fitted with a range of eye and base level units with work surfaces over, sink with mixer tap and drainer, gas cooker with extractor fan over, spotlights, tiled flooring, double glazed window to front.

Utility Room:

7' 4" x 4' 9" (2.24m x 1.45m)
Plumbing for a washing machine, electric points, small worktop space, wood laminate flooring.

Conservatory:

8' x 9' 5" (2.44m x 2.87m)
Double glazed patio doors to rear garden, electric radiator, wood laminate flooring.

Landing:

Two cupboards, airing cupboard with system boiler and tank, second airing cupboard. Doors to upstairs accommodation.

Bedroom One:

12' 8" max x 11' 4" max (3.86m max x 3.45m max)
Double glazed window to side aspect, radiator.

Bedroom Two:

12' 2" max x 11' 2" max (3.71m max x 3.40m max)
Double glazed window to rear aspect, double panel radiator.

Bedroom Three:

9' 7" max x 8' max (2.92m max x 2.44m max)
Double glazed window to front aspect.

Bathroom:

Fitted with a suite to comprise: Bath with fitted shower head and taps, wash hand basin and w.c. tiled splash back surrounds, heated towel rail, laminate flooring.

Outside:

Front Garden:

Laid to shingle with wooden picket fence surround, gate to garden and paving leading to front door.

Rear Garden:

Mainly laid to lawn, large decking area, large side entrance, electric and water supplies.

Garage:

Double length single garage plus one parking space.



Ground Floor

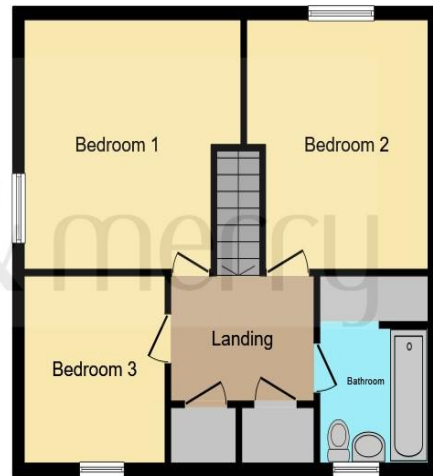

First Floor

This floor plan is for illustrative purposes only. It is not drawn to scale. Any measurements, floor areas (including any total floor area), openings and orientation are approximate. No details are guaranteed, they cannot be relied upon for any purpose and they do not form part of any agreement. No liability is taken for any error, omission or misstatement. A party must rely upon its own inspection(s). Powered by www.focalagent.com



welcome to
Nicholas Mead,
Great Linford Milton Keynes

- Three bedrooms
- Downstairs cloakroom & utility room
- Conservatory
- Garden to front and rear
- Double length single garage

Tenure: Freehold EPC Rating: C

guide price

£350,000



view this property online [browbandmerry.co.uk/Property/NPL107167](https://www.browbandmerry.co.uk/Property/NPL107167)



Property Ref:
NPL107167 - 0003

1. MONEY LAUNDERING REGULATIONS Intending purchasers will be asked to produce identification documentation at a later stage and we would ask for your co-operation in order that there is no delay in agreeing the sale. 2. These particulars do not constitute part or all of an offer or contract. 3. The measurements indicated are supplied for guidance only and as such must be considered incorrect. Potential buyers are advised to recheck measurements before committing to any expense. 4. We have not tested any apparatus, equipment, fixtures or services and it is in the buyers interest to check the working condition of any appliances. 5. Where an EPC, or a Home Report (Scotland only) is held for this property, it is available for inspection at the branch by appointment. If you require a printed version of a Home Report, you will need to pay a reasonable production charge reflecting printing and other costs. 6. We are not able to offer an opinion either written or verbal on the content of these reports and this must be obtained from your legal representative. 7. Whilst we take care in preparing these reports, a buyer should ensure that his/her legal representative confirms as soon as possible all matters relating to title including the extent and boundaries of the property and other important matters before exchange of contracts.

Brown & Merry is a trading name of Sequence (UK) Limited which is registered in England and Wales under company number 4268443, Registered Office is Cumbria House, 16-20 Hockliffe Street, Leighton Buzzard, Bedfordshire, LU7 1GN. VAT Registration Number is 500 2481 05.

brown & merry



01908 611242



newportpagnell@brownandmerry.co.uk



74A High Street, Newport Pagnell, MILTON
KEYNES, Buckinghamshire, MK16 8AQ



[brownandmerry.co.uk](https://www.browbandmerry.co.uk)