



**Glovers Lane, Heelands Milton Keynes MK13 7LW**

**welcome to**

## **Glovers Lane, Heelands Milton Keynes**

Situated within close proximity of the MAINLINE RAILWAY STATION and LOCAL AMENITIES stands this MID-TERRACE FAMILY HOME. The property is offered in GOOD CONDITION throughout and benefits from a DOWNSTAIRS CLOAKROOM, KITCHEN/DINER, MODERN BATHROOM, GARDENS and PARKING.

### **Storage Porch:**

With power, Smart meters and space for bins.

### **Entrance Hall:**

LVT flooring, storage space under stairs for coats and shoes.

### **Cloakroom:**

Fitted with a suite to comprise: Wash hand basin and w.c. Tiled splash backs.

### **Lounge:**

16' 6" x 10' 2" ( 5.03m x 3.10m )

Wood LVT flooring throughout, sliding patio doors to rear garden, wood panelling on walls, T.V. point, double glazed window to rear.

### **Kitchen / Diner:**

16' 9" max x 10' 3" max ( 5.11m max x 3.12m max )

Fitted with a range of eye and base level units with work surfaces over, newly fitted tap with spray hose attachment, integrated double oven with grill, induction hob with extractor fan over, space for washing machine, dish washer and space for tumble dryer and fridge, double glazed windows to front aspect, space for dining area, tiled splash back surround, spotlights, and LVT flooring.

### **Landing:**

Doors to bedrooms and bathroom, door to airing cupboard with storage space and housing the combination boiler, one alcove providing additional storage space, access to loft which is partially boarded.

### **Bedroom One:**

13' 7" x 8' 3" ( 4.14m x 2.51m )

Good sized bedroom recently decorated with aerial cable, new coving to the ceiling and new skirting boards. Double glazed window to front, and radiator.

### **Bedroom Two:**

13' 6" x 8' 3" ( 4.11m x 2.51m )

Good sized bedroom recently decorated with aerial cable, new coving to the ceiling and new skirting boards. Double glazed window to rear, and radiator.

### **Bedroom Three:**

8' 11" x 7' 5" ( 2.72m x 2.26m )

Newly decorated with new coving to the ceiling and new skirting boards. Double glazed window to rear and radiator.

### **Bathroom:**

Modern bathroom fitted with a suite to comprise: Bath with mixer taps and waterfall shower head over, built-in unit with toilet and wash hand basin with mixer tap, tiled floor to ceiling, heated towel rail, frosted glass window to front, spotlights, and extractor fan.

### **Outside:**

#### **Front Garden:**

Gate leading to property, limestone patio, lawned area, outside tap, enclosed fencing.

#### **Rear Garden:**

Wood decking with integrated lights leading to patio area, power/electric socket, wooden shed in garden. Double sized gates giving access to sandstone paving on reinforced concrete base to hold a car.

### **Parking:**

Car parking space in garden.



**Ground Floor**

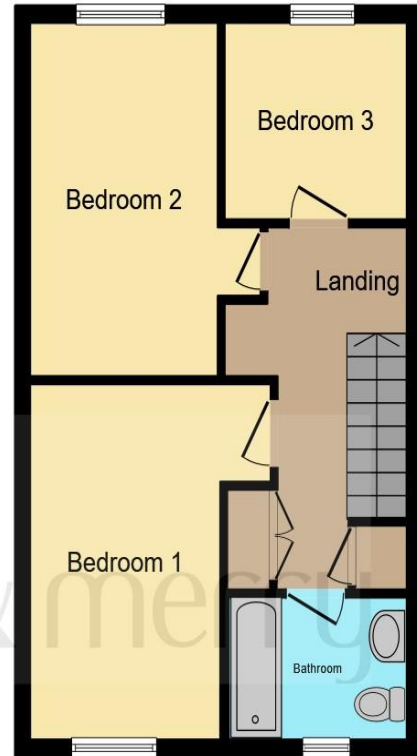

**First Floor**

This floor plan is for illustrative purposes only. It is not drawn to scale. Any measurements, floor areas (including any total floor area), openings and orientation are approximate. No details are guaranteed, they cannot be relied upon for any purpose and they do not form part of any agreement. No liability is taken for any error, omission or misstatement. A party must rely upon its own inspection(s). Powered by [www.focalagent.com](http://www.focalagent.com)



**welcome to**  
**Glovers Lane,**  
**Heelands Milton Keynes**

- THREE BEDROOM MID-TERRACE FAMILY HOME
- RECENTLY REFURBISHED
- DOWNSTAIRS CLOAKROOM
- KITCHEN/DINER
- FRONT AND REAR GARDENS AND PARKING

Tenure: Freehold EPC Rating: C

guide price

**£290,000**



**view this property online** [brownandmerry.co.uk/Property/NPL107204](https://www.brownandmerry.co.uk/Property/NPL107204)



Property Ref:  
NPL107204 - 0006

1. MONEY LAUNDERING REGULATIONS Intending purchasers will be asked to produce identification documentation at a later stage and we would ask for your co-operation in order that there is no delay in agreeing the sale. 2. These particulars do not constitute part or all of an offer or contract. 3. The measurements indicated are supplied for guidance only and as such must be considered incorrect. Potential buyers are advised to recheck measurements before committing to any expense. 4. We have not tested any apparatus, equipment, fixtures or services and it is in the buyers interest to check the working condition of any appliances. 5. Where an EPC, or a Home Report (Scotland only) is held for this property, it is available for inspection at the branch by appointment. If you require a printed version of a Home Report, you will need to pay a reasonable production charge reflecting printing and other costs. 6. We are not able to offer an opinion either written or verbal on the content of these reports and this must be obtained from your legal representative. 7. Whilst we take care in preparing these reports, a buyer should ensure that his/her legal representative confirms as soon as possible all matters relating to title including the extent and boundaries of the property and other important matters before exchange of contracts.

Brown & Merry is a trading name of Sequence (UK) Limited which is registered in England and Wales under company number 4268443, Registered Office is Cumbria House, 16-20 Hockliffe Street, Leighton Buzzard, Bedfordshire, LU7 1GN. VAT Registration Number is 500 2481 05.

  
brown & merry



**01908 611242**



[newportpagnell@brownandmerry.co.uk](mailto:newportpagnell@brownandmerry.co.uk)



74A High Street, Newport Pagnell, MILTON  
KEYNES, Buckinghamshire, MK16 8AQ



**[brownandmerry.co.uk](https://www.brownandmerry.co.uk)**