



Avon Square, Hemel Hempstead HP2 6DZ

welcome to

Avon Square, Hemel Hempstead

Located in a cul-de-sac in a quiet residential area is this three / four bedroom town house.



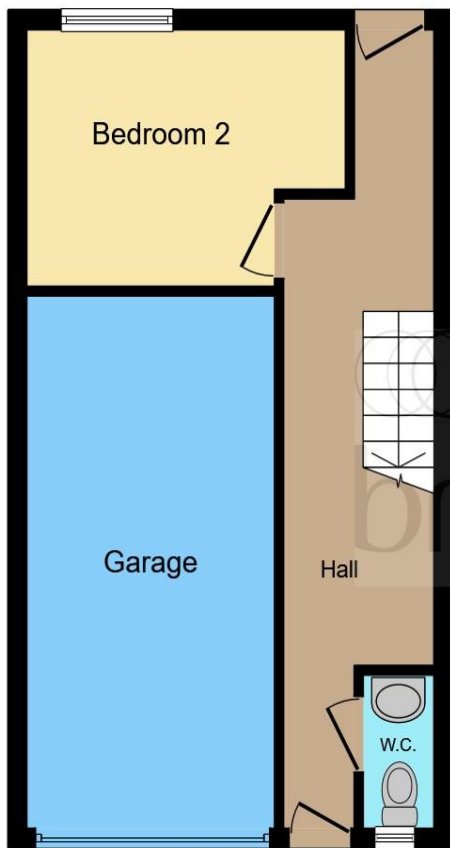

Ground Floor

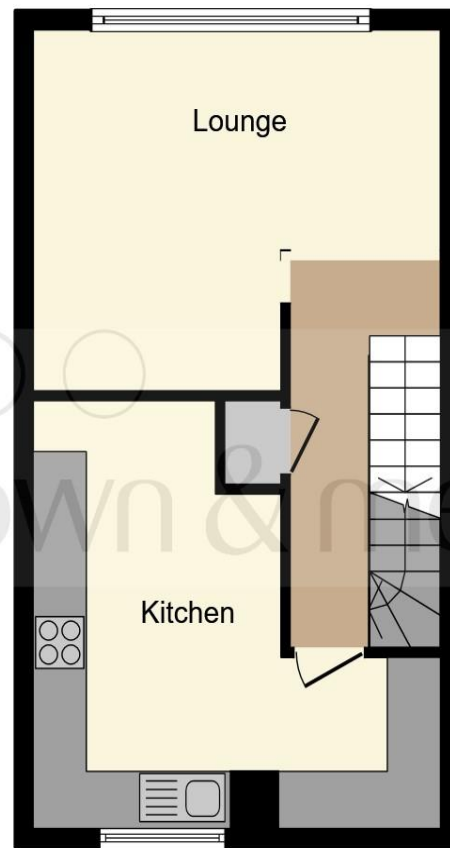

First Floor

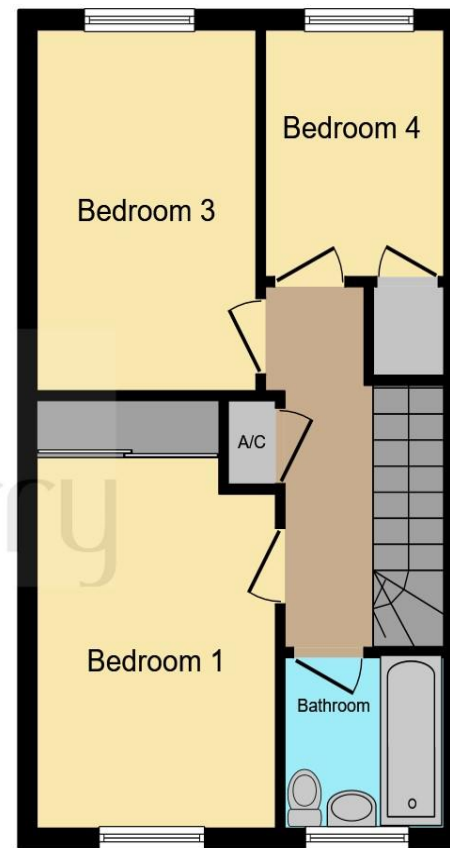

Second Floor

Total floor area 115.9 m² (1,248 sq.ft.) approx

This floor plan is for illustrative purposes only. It is not drawn to scale. Any measurements, floor areas (including any total floor area), openings and orientation are approximate. No details are guaranteed, they cannot be relied upon for any purpose and they do not form part of any agreement. No liability is taken for any error, omission or misstatement. A party must rely upon its own inspection(s). Powered by www.focalagent.com

Entrance Hall

Cloakroom

Bedroom Four / Study

11' 8" To Max x 8' 10" To Max (3.56m To Max x 2.69m To Max)

First Floor Landing

Lounge

15' 2" To Max x 12' 6" To Max (4.62m To Max x 3.81m To Max)

Kitchen

15' 1" To Max x 14' 6" To Max (4.60m To Max x 4.42m To Max)

Second Floor Landing

Bedroom One

12' 1" To Wardrobes x 9' 1" To Max (3.68m To Wardrobes x 2.77m To Max)

Bedroom Two

12' 4" x 8' 5" (3.76m x 2.57m)

Bedroom Three

8' 8" To Wardrobe x 6' 6" (2.64m To Wardrobe x 1.98m)

Bathroom

Outside

Rear Garden

Garage

welcome to

Avon Square, Hemel Hempstead

- Cul-De-Sac Location
- Quiet Residential Area
- Three / Four Bedroom Town House
- Spacious Living Accommodation
- Good Sized Kitchen & Family Bathroom

Tenure: Freehold EPC Rating: D

£400,000



Please note the marker reflects the postcode not the actual property

view this property online [brownandmerry.co.uk/Property/HHD110168](https://www.brownandmerry.co.uk/Property/HHD110168)



Property Ref:
HHD110168 - 0002

1. MONEY LAUNDERING REGULATIONS Intending purchasers will be asked to produce identification documentation at a later stage and we would ask for your co-operation in order that there is no delay in agreeing the sale. 2. These particulars do not constitute part or all of an offer or contract. 3. The measurements indicated are supplied for guidance only and as such must be considered incorrect. Potential buyers are advised to recheck measurements before committing to any expense. 4. We have not tested any apparatus, equipment, fixtures or services and it is in the buyers interest to check the working condition of any appliances. 5. Where an EPC, or a Home Report (Scotland only) is held for this property, it is available for inspection at the branch by appointment. If you require a printed version of a Home Report, you will need to pay a reasonable production charge reflecting printing and other costs. 6. We are not able to offer an opinion either written or verbal on the content of these reports and this must be obtained from your legal representative. 7. Whilst we take care in preparing these reports, a buyer should ensure that his/her legal representative confirms as soon as possible all matters relating to title including the extent and boundaries of the property and other important matters before exchange of contracts.

brown & merry



01442 232400



HemelHempstead@brownandmerry.co.uk



57 Marlowes, HEMEL HEMPSTEAD,
Hertfordshire, HP1 1LE



[brownandmerry.co.uk](https://www.brownandmerry.co.uk)