



Fareham House Marlowes, Hemel Hempstead HP1 1DZ

welcome to

Fareham House Marlowes, Hemel Hempstead

**** NO UPPER CHAIN **** Located in the CENTRE OF TOWN and close to great shopping and transport facilities is this well presented spacious two bedroom flat.





Ground Floor

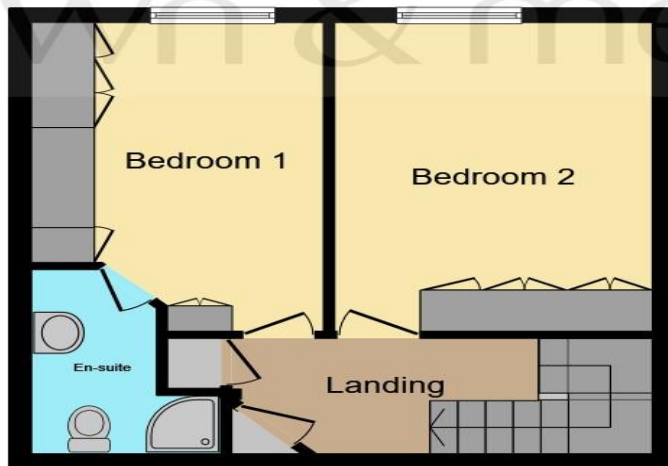

First Floor

Total floor area 74.2 sq.m. (799 sq.ft.) approx

This plan is for illustration purposes only and may not be representative of the property. Plan not to scale.

Entrance Hall

Lounge

14' 9" x 11' 6" (4.50m x 3.51m)

Kitchen

12' 2" x 7' 7" (3.71m x 2.31m)

Bathroom

Lower Landing

Bedroom One

14' 9" x 9' 1" (4.50m x 2.77m)

En-Suite

Bedroom Two

14' 9" x 10' 6" (4.50m x 3.20m)

welcome to

Fareham House Marlowes, Hemel Hempstead

- No Upper Chain
- Two Bedroom Flat In A Town Centre Location
- Spacious Living Accommodation
- Large Kitchen
- Bedroom With En-Suite Shower Room

Tenure: Leasehold EPC Rating: E

£190,000



Please note the marker reflects the postcode not the actual property

view this property online [brownandmerry.co.uk/Property/HHD109747](https://www.brownandmerry.co.uk/Property/HHD109747)

This is a Leasehold property. We are awaiting further details about the Term of the lease. For further information please contact the branch. Please note additional fees could be incurred for items such as Leasehold packs.

1. MONEY LAUNDERING REGULATIONS Intending purchasers will be asked to produce identification documentation at a later stage and we would ask for your co-operation in order that there is no delay in agreeing the sale. 2. These particulars do not constitute part or all of an offer or contract. 3. The measurements indicated are supplied for guidance only and as such must be considered incorrect. Potential buyers are advised to recheck measurements before committing to any expense. 4. We have not tested any apparatus, equipment, fixtures or services and it is in the buyers interest to check the working condition of any appliances. 5. Where an EPC, or a Home Report (Scotland only) is held for this property, it is available for inspection at the branch by appointment. If you require a printed version of a Home Report, you will need to pay a reasonable production charge reflecting printing and other costs. 6. We are not able to offer an opinion either written or verbal on the content of these reports and this must be obtained from your legal representative. 7. Whilst we take care in preparing these reports, a buyer should ensure that his/her legal representative confirms as soon as possible all matters relating to title including the extent and boundaries of the property and other important matters before exchange of contracts.



Property Ref:
HHD109747 - 0002

brown & merry



01442 232400



HemelHempstead@brownandmerry.co.uk



57 Marlowes, HEMEL HEMPSTEAD,
Hertfordshire, HP1 1LE



[brownandmerry.co.uk](https://www.brownandmerry.co.uk)