



Mill House Rose Lane, Nash Mills Wharf Hemel Hempstead HP3 9GL



welcome to

Mill House Rose Lane, Nash Mills Wharf Hemel Hempstead

** NO UPPER CHAIN ** Located in the sought after Nash Mills Wharf development and being very well presented throughout is this two double bedroom first floor apartment which overlooks open fields.



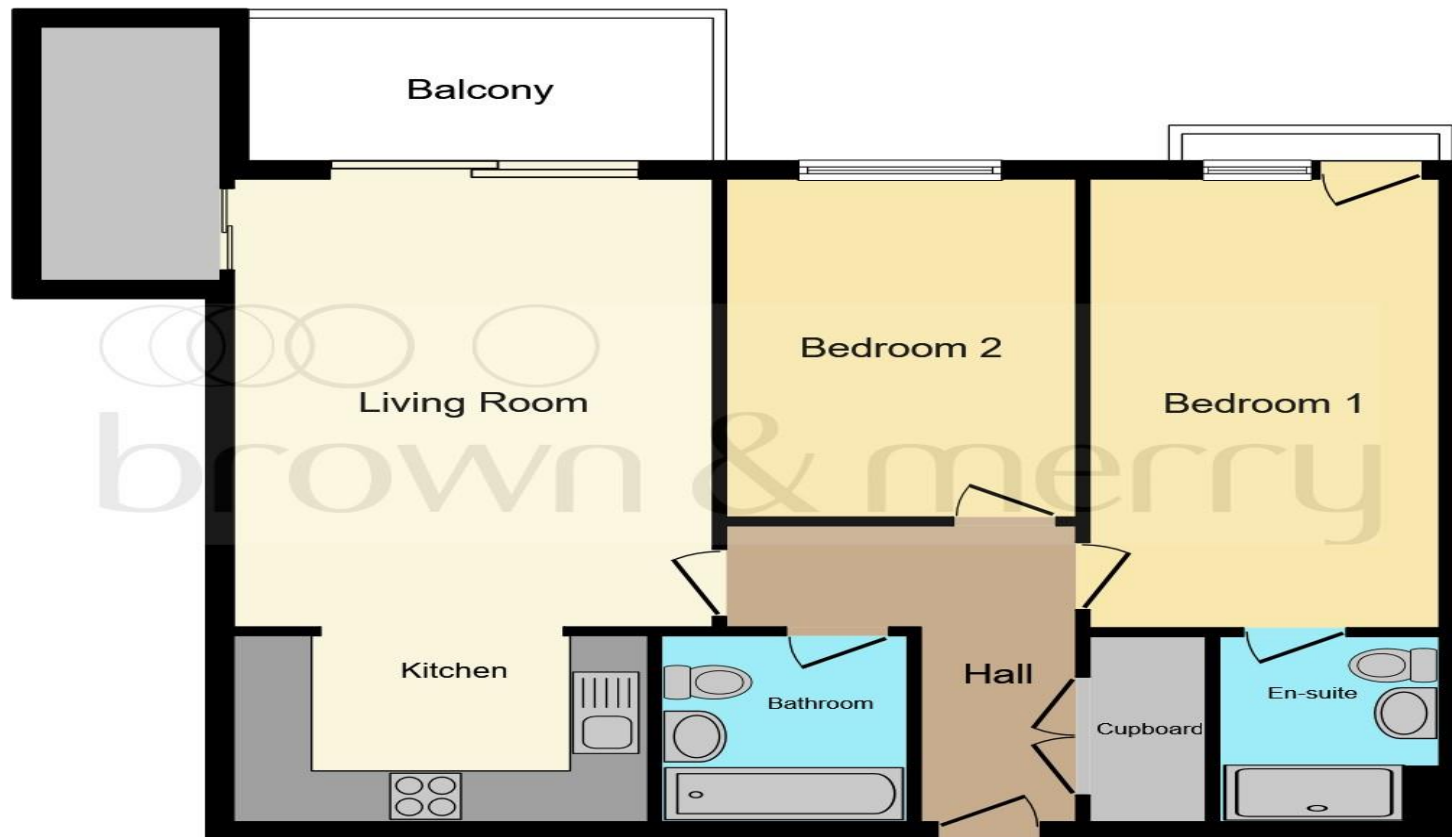

Entrance Hall

Open Plan Lounge / Kitchen

24' 4" To Max x 11' 11" (7.42m To Max x 3.63m)

Bedroom One

17' 9" To Max x 8' 10" (5.41m To Max x 2.69m)

En-Suite

Bedroom Two

13' 3" x 8' 10" (4.04m x 2.69m)

Bathroom

Outside

Allocated Parking

Total floor area 74.9 sq.m. (807 sq.ft.) approx

This plan is for illustration purposes only and may not be representative of the property. Plan not to scale.

Powered by audioagent.com

welcome to

Mill House Rose Lane, Nash Mills Wharf Hemel Hempstead

- No Upper Chain
- Sought After Residential Area
- Two Bedroom First Floor Apartment Which Overlooks Open Fields
- Modern Open Plan Living Accommodation
- Master Bedroom With En-Suite

Tenure: Leasehold EPC Rating: B

offers in excess of

£300,000



Please note the marker reflects the postcode not the actual property

view this property online [brownmerry.co.uk/Property/HHD110071](https://www.brownmerry.co.uk/Property/HHD110071)

This is a Leasehold property with details as follows; Term of Lease 125 years from 01 Jan 2013. Should you require further information please contact the branch. Please Note additional fees could be incurred for items such as Leasehold packs.

1. MONEY LAUNDERING REGULATIONS Intending purchasers will be asked to produce identification documentation at a later stage and we would ask for your co-operation in order that there is no delay in agreeing the sale. 2. These particulars do not constitute part or all of an offer or contract. 3. The measurements indicated are supplied for guidance only and as such must be considered incorrect. Potential buyers are advised to recheck measurements before committing to any expense. 4. We have not tested any apparatus, equipment, fixtures or services and it is in the buyers interest to check the working condition of any appliances. 5. Where an EPC, or a Home Report (Scotland only) is held for this property, it is available for inspection at the branch by appointment. If you require a printed version of a Home Report, you will need to pay a reasonable production charge reflecting printing and other costs. 6. We are not able to offer an opinion either written or verbal on the content of these reports and this must be obtained from your legal representative. 7. Whilst we take care in preparing these reports, a buyer should ensure that his/her legal representative confirms as soon as possible all matters relating to title including the extent and boundaries of the property and other important matters before exchange of contracts.



Property Ref:
HHD110071 - 0003

brown & merry



01442 232400



HemelHempstead@brownmerry.co.uk



57 Marlowes, HEMEL HEMPSTEAD,
Hertfordshire, HP1 1LE



[brownmerry.co.uk](https://www.brownmerry.co.uk)