



**Northridge Way, Hemel Hempstead HP1 2AF**



**welcome to**

**Northridge Way, Hemel Hempstead**

Located in the sought after area of Boxmoor and being within walking distance of Boxmoor Village, Boxmoor Moor and Hemel Hempstead Mainline Train Station is this one bedroom first floor maisonette. Features include good sized living accommodation, kitchen, bathroom and allocated parking.



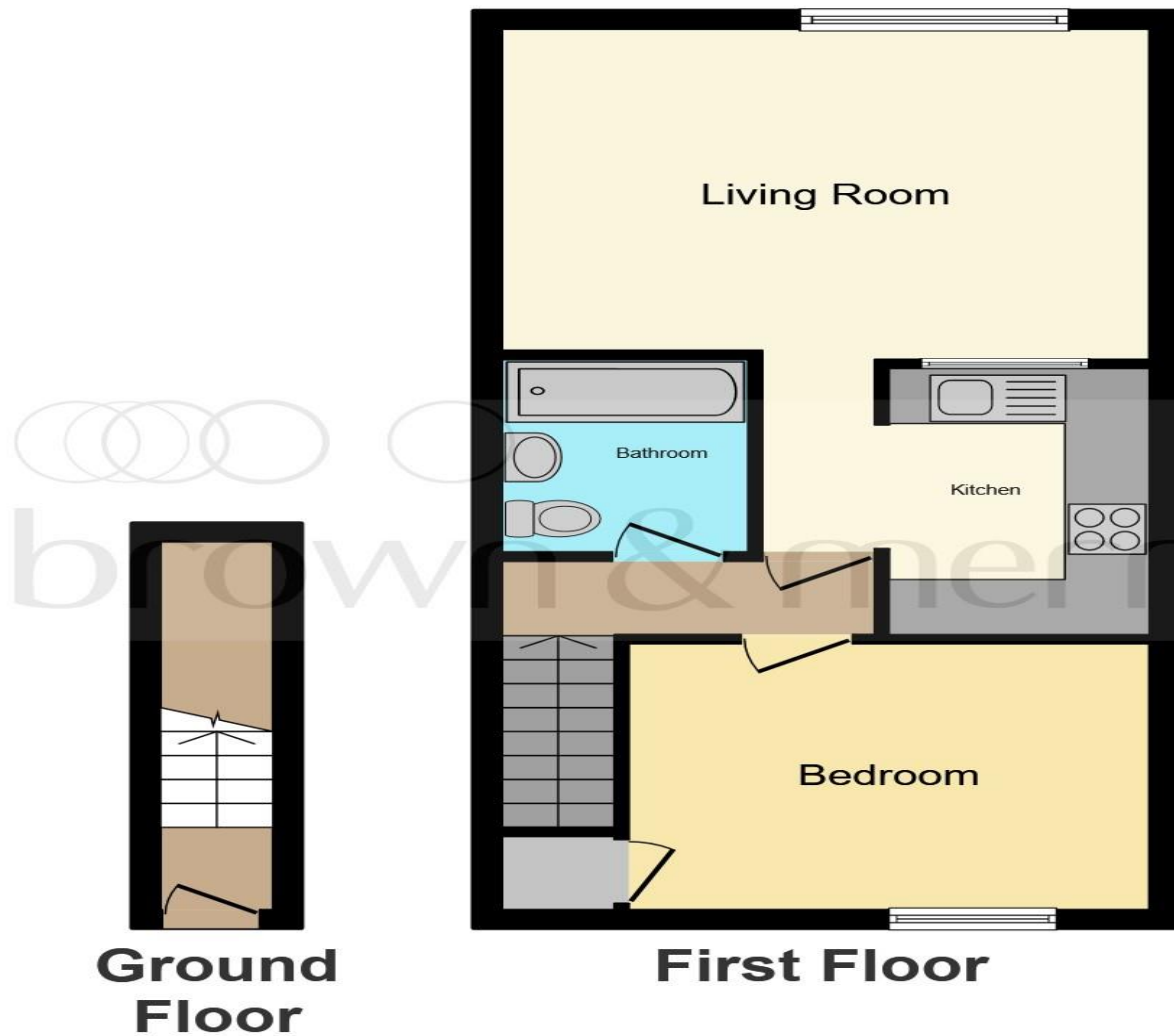

**Entrance Hall**

**Lounge**

14' 9" x 11' 8" ( 4.50m x 3.56m )

**Kitchen**

9' 4" x 9' ( 2.84m x 2.74m )

**Bedroom One**

11' 9" x 9' 4" ( 3.58m x 2.84m )

**Bathroom**

**Outside**

**Allocated Parking Space**

This plan is for illustration purposes only and may not be representative of the property. Plan not to scale.

Powered by [audioagent.com](http://audioagent.com)

welcome to

## Northridge Way, Hemel Hempstead

- Sought After Residential Area
- Walking Distance Of Boxmoor Village, Boxmoor Moor & Hemel Hempstead Mainline Train Station
- First Floor Maisonette
- One Bedroom
- Good Sized Living Accommodation

Tenure: Leasehold EPC Rating: C

# £190,000



Please note the marker reflects the postcode not the actual property

**view this property online** [brownmerry.co.uk/Property/HHD109402](https://www.brownmerry.co.uk/Property/HHD109402)

This is a Leasehold property. We are awaiting further details about the Term of the lease. For further information please contact the branch. Please note additional fees could be incurred for items such as Leasehold packs.

1. MONEY LAUNDERING REGULATIONS Intending purchasers will be asked to produce identification documentation at a later stage and we would ask for your co-operation in order that there is no delay in agreeing the sale. 2. These particulars do not constitute part or all of an offer or contract. 3. The measurements indicated are supplied for guidance only and as such must be considered incorrect. Potential buyers are advised to recheck measurements before committing to any expense. 4. We have not tested any apparatus, equipment, fixtures or services and it is in the buyers interest to check the working condition of any appliances. 5. Where an EPC, or a Home Report (Scotland only) is held for this property, it is available for inspection at the branch by appointment. If you require a printed version of a Home Report, you will need to pay a reasonable production charge reflecting printing and other costs. 6. We are not able to offer an opinion either written or verbal on the content of these reports and this must be obtained from your legal representative. 7. Whilst we take care in preparing these reports, a buyer should ensure that his/her legal representative confirms as soon as possible all matters relating to title including the extent and boundaries of the property and other important matters before exchange of contracts.



Property Ref:  
HHD109402 - 0006

  
brown & merry



**01442 232400**



[HemelHempstead@brownmerry.co.uk](mailto:HemelHempstead@brownmerry.co.uk)



57 Marlowes, HEMEL HEMPSTEAD,  
Hertfordshire, HP1 1LE



**[brownmerry.co.uk](https://www.brownmerry.co.uk)**