



Frederick Street, Waddesdon AYLESBURY HP18 0LX

welcome to

Frederick Street, Waddesdon AYLESBURY

Brown & Merry are pleased to offer for sale this two bedroom character home being situated within this popular Buckinghamshire village of Waddesdon. The property features gas heating system with radiators, double glazing, door opening to spacious lounge/dining room, fitted kitchen, ground floor bathroom, two first floor bedrooms, rear garden. Internal viewing is highly recommended to fully appreciate this village property.



Accommodation Comprises

Lounge/ Dining Room

11' 2" x 22' 6" (3.40m x 6.86m)

Kitchen

6' 4" x 7' (1.93m x 2.13m)

Rear Lobby

Bathroom

Landing & First Floor

Bedroom One

14' 2" x 10' 5" (4.32m x 3.17m)

Bedroom Two

11' 7" x 8' 2" (3.53m x 2.49m)

Bathroom

Outside

Rear Garden

The village is steeped in history with a church of Norman origins and the old Roman Military Road, Akeman Street used to pass through the place. Of some renown is the magnificent Waddesdon Manor, Baron Ferdinand De Rothschild bought the land and it is said he picked the site for his residence after hunting in the area. The nearby market towns and villages provide a wealth of historical and interesting places to visit including the local Waddesdon Manor, Claydon House and Quainton Steam Railway. Shopping facilities are situated at Bicester Village Retail Outlet, Friar's Square Centre in Aylesbury, Milton Keynes and Oxford. The village itself offers Shops, a Post Office, a Doctor's Surgery, Pubs, the Five Arrows Hotel and an Indian Restaurant. Aylesbury is about 5 miles with railway station to London (Marylebone approx. 60 mins), or Haddenham/Thame Parkway about 9 miles. The market town of Thame is about 10 miles and Oxford is approx. 23 miles. The M40 motorway beyond gives access to London, Oxford and Birmingham.

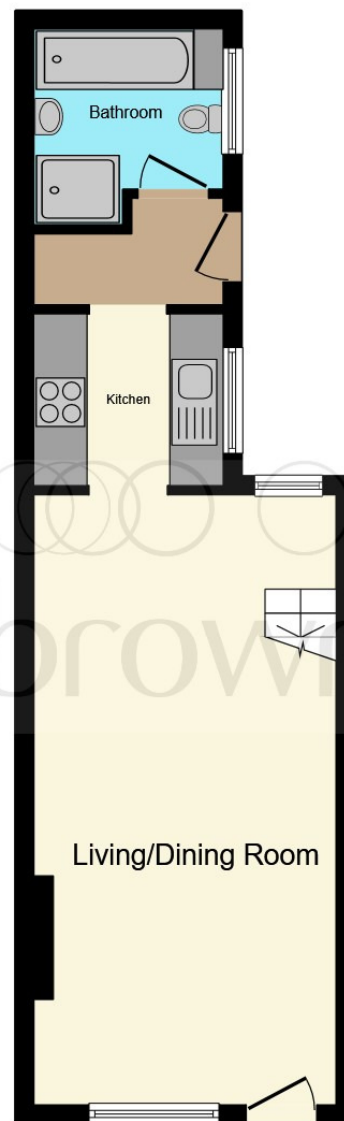

Ground Floor

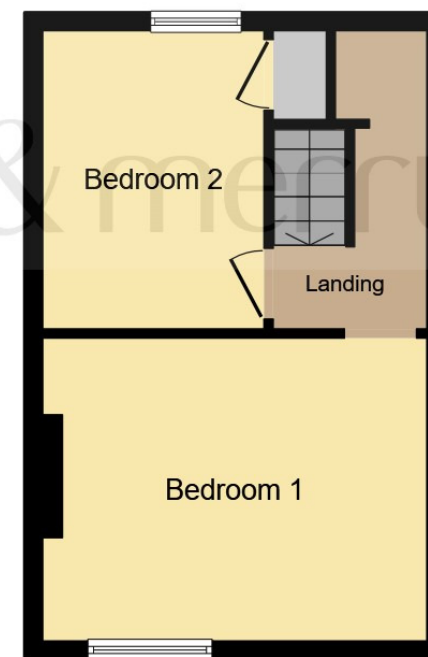

First Floor

This plan is for illustration purposes only and may not be representative of the property. Plan not to scale.

Powered by audioagent.com



check out more properties at brownandmerry.co.uk



welcome to

Frederick Street, Waddesdon AYLESBURY

- CHAIN FREE
- TWO BEDROOMS
- LOUNGE/DINING ROOM
- WADDESDON SCHOOL
- GAS CENTRAL HEATING
- MUST BE VIEWED

Tenure: Freehold EPC Rating: E

£350,000

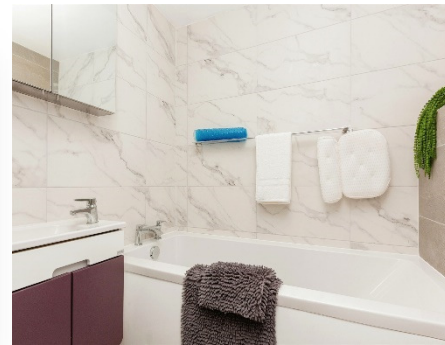

Please note the marker reflects the postcode not the actual property

check out more properties at brownandmerry.co.uk



Property Ref:
AYL114190 - 0002

1. MONEY LAUNDERING REGULATIONS Intending purchasers will be asked to produce identification documentation at a later stage and we would ask for your co-operation in order that there is no delay in agreeing the sale. 2. These particulars do not constitute part or all of an offer or contract. 3. The measurements indicated are supplied for guidance only and as such must be considered incorrect. Potential buyers are advised to recheck measurements before committing to any expense. 4. We have not tested any apparatus, equipment, fixtures or services and it is in the buyers interest to check the working condition of any appliances. 5. Where an EPC, or a Home Report (Scotland only) is held for this property, it is available for inspection at the branch by appointment. If you require a printed version of a Home Report, you will need to pay a reasonable production charge reflecting printing and other costs. 6. We are not able to offer an opinion either written or verbal on the content of these reports and this must be obtained from your legal representative. 7. Whilst we take care in preparing these reports, a buyer should ensure that his/her legal representative confirms as soon as possible all matters relating to title including the extent and boundaries of the property and other important matters before exchange of contracts.

 brown & merry



01296 488111



Aylesbury@brownandmerry.co.uk



5-7 Market Street, AYLESBURY,
Buckinghamshire, HP20 2PN



brownandmerry.co.uk