



Stephenson Close, Prebendal Farm Aylesbury HP19 7QU



welcome to

Stephenson Close, Prebendal Farm Aylesbury HP19 7QU

A three bedroom terraced family home being situated within a cul-de-sac location and featuring entrance hall, cloakroom, lounge/dining room, kitchen, three well-proportioned bedrooms, bathroom, enclosed rear garden, driveway providing off road parking.



Accommodation Comprises:

Entrance Hall

Cloakroom

Lounge/ Dining Room

21' 7" x 9' 6" extending to 12' 4" max (6.58m x 2.90m extending to 3.76m max)

Kitchen

10' 7" x 8' 1" plus door recess (3.23m x 2.46m plus door recess)

First Floor & Landing

Master Bedroom

12' 7" x 10' 6" max (3.84m x 3.20m max)

Bedroom Two

11' 6" x 8' 3" (3.51m x 2.51m)

Bedroom Three

10' 1" x 10' 2" (3.07m x 3.10m)

Bathroom

Outside

Rear Garden

Driveway

Agent Notes

Please note the Solar panels are leased and for further information, please call the office.



Ground Floor

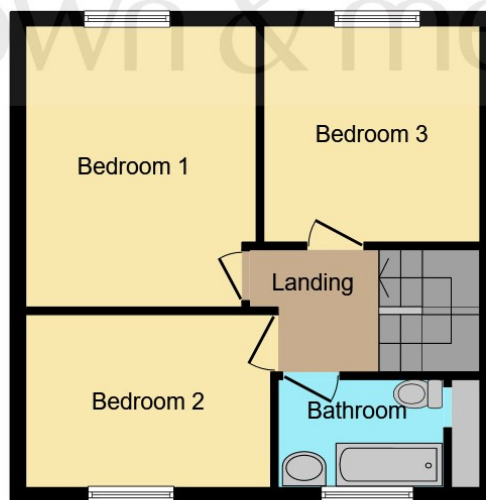

First Floor



This plan is for illustration purposes only and may not be representative of the property. Plan not to scale.

Powered by audioagent.com



check out more properties at brownandmerry.co.uk



welcome to

Stephenson Close, Prebendal Farm Aylesbury

- THREE BEDROOM TERRACED HOME
- ENTRANCE HALL & CLOAKROOM
- LOUNGE/DINING ROOM & KITCHEN
- BATHROOM
- REAR GARDEN & DRIVEWAY

Tenure: Freehold EPC Rating: D

£270,000



Please note the marker reflects the
postcode not the actual property

check out more properties at [browndmerry.co.uk](https://www.browndmerry.co.uk)



Property Ref:
AYL113760 - 0007

1. MONEY LAUNDERING REGULATIONS Intending purchasers will be asked to produce identification documentation at a later stage and we would ask for your co-operation in order that there is no delay in agreeing the sale. 2. These particulars do not constitute part or all of an offer or contract. 3. The measurements indicated are supplied for guidance only and as such must be considered incorrect. Potential buyers are advised to recheck measurements before committing to any expense. 4. We have not tested any apparatus, equipment, fixtures or services and it is in the buyers interest to check the working condition of any appliances. 5. Where an EPC, or a Home Report (Scotland only) is held for this property, it is available for inspection at the branch by appointment. If you require a printed version of a Home Report, you will need to pay a reasonable production charge reflecting printing and other costs. 6. We are not able to offer an opinion either written or verbal on the content of these reports and this must be obtained from your legal representative. 7. Whilst we take care in preparing these reports, a buyer should ensure that his/her legal representative confirms as soon as possible all matters relating to title including the extent and boundaries of the property and other important matters before exchange of contracts.

brown & merry



01296 488111



Aylesbury@browndmerry.co.uk



5-7 Market Street, AYLESBURY,
Buckinghamshire, HP20 2PN



[browndmerry.co.uk](https://www.browndmerry.co.uk)