

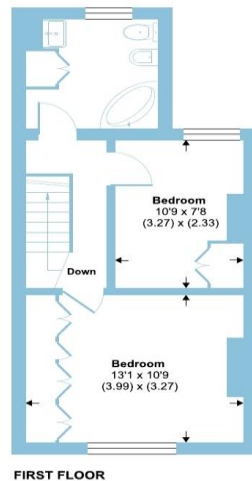

**Brunswick Grove, London N11 1ED**

## Brunswick Grove, London, N11

Approximate Area = 770 sq ft / 71.5 sq m  
 Outbuilding = 14 sq ft / 1.3 sq m  
 Total = 784 sq ft / 72.8 sq m  
 For identification only - Not to scale

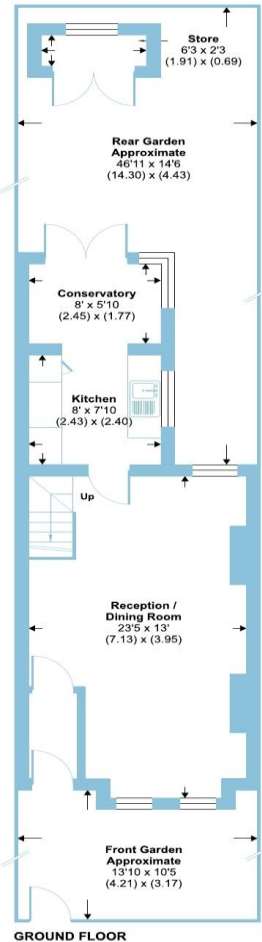

Floor plan produced in accordance with RICS Property Measurement 2nd Edition, incorporating International Property Measurement Standards (IPMS2 Residential). © richcom 2025. Produced for Barnard Marcus. REF: 1261911

barnard marcus

## welcome to Brunswick Grove, London

- Two Bedrooms
- Conservatory
- Peaceful Location

Tenure: Freehold

EPC Rating: D

- Rear Garden backing onto Public Green Space
- 0.7 miles to New Southgate Mainline & 0.9 Miles to Arnos Grove Tube Stations

# £550,000



A 2-bedroom terraced period home presented in liveable order throughout having been well-maintained by the current owner. New Southgate Mainline 0.7 miles & Arnos Grove 0.9 miles Tube stations are within close-proximity and could be appealing to those needing to commute into London.

This residence comprises of a through lounge diner to a fitted kitchen opening to this home's conservatory. To the rear there a good-sized garden backing onto the areas local green space, which is very popular with local residents. To the first floor you will find two double bedrooms and a family bathroom. Externally this property is approached via a front garden with on street parking.

Steeped in history, New Southgate & Friern Barnet also known as little Barnet is perfect for both families and commuters. For those needing good transport links, Friern Barnet benefits from fast access in and out of central London via the zone four Piccadilly Line tube station at Arnos Grove and Overground at New Southgate. For car users, the A406 (North Circular Road) is nearby.

**view this property online** [barnardmarcus.co.uk/Property/WTS107344](https://barnardmarcus.co.uk/Property/WTS107344)



Property Ref:

WTS107344 - 0002

1. MONEY LAUNDERING REGULATIONS Intending purchasers will be asked to produce identification documentation at a later stage and we would ask for your co-operation in order that there is no delay in agreeing the sale. 2. These particulars do not constitute part or all of an offer or contract. 3. The measurements indicated are supplied for guidance only and as such must be considered incorrect. Potential buyers are advised to recheck measurements before committing to any expense. 4. We have not tested any apparatus, equipment, fixtures or services and it is in the buyers interest to check the working condition of any appliances. 5. Where an EPC, or a Home Report (Scotland only) is held for this property, it is available for inspection at the branch by appointment. If you require a printed version of a Home Report, you will need to pay a reasonable production charge reflecting printing and other costs. 6. We are not able to offer an opinion either written or verbal on the content of these reports and this must be obtained from your legal representative. 7. Whilst we take care in preparing these reports, a buyer should ensure that his/her legal representative confirms as soon as possible all matters relating to title including the extent and boundaries of the property and other important matters before exchange of contracts.

Barnard Marcus is a trading name of Sequence (UK) Limited which is registered in England and Wales under company number 4268443, Registered Office is Cumbria House, 16-20 Hockliffe Street, Leighton Buzzard, Bedfordshire, LU7 1GN. VAT Registration Number is 500 2481 05.



barnard marcus



020 8446 6888



Whetstone@barnardmarcus.co.uk



1285 High Road, Whetstone, LONDON, N20 9HS



[barnardmarcus.co.uk](https://barnardmarcus.co.uk)