



Pippin Way, Alresford, Colchester, CO7 8FL

welcome to

Pippin Way, Alresford, Colchester

This modern and beautifully presented one bedroom first floor SHARED OWNERSHIP apartment is situated in the popular village of Alresford. around 6 miles south east of Colchester. The village benefits from local amenities, schooling and train station.



Early viewing is advised of this stunning first floor apartment situated in the lovely village of Alresford and offered on a SHARED OWNERSHIP basis.

The well presented accommodation comprises entrance hall, open plan lounge/diner/kitchen, double bedroom and bathroom. Externally the property benefits from allocated parking and a communal garden.

Communal Entrance Door To:

Communal Entrance Hall

Stairs to first floor.

Entrance Door To:

Entrance Hall

Radiator, utility cupboard, storage cupboard, carpet.

Lounge / Diner / Kitchen

22' max x 10' 1" max (6.71m max x 3.07m max)

Lounge / Dining Area

Two radiators, upvc double glazed window to side, carpet.

Kiktchen Area

Work surfaces, inset single sink and drainer with mixer tap, range of cupboards and drawers, integral electric oven and four ring gas hob with extractor hood over, space and plumbing for washing machine + tumble dryer + fridge/freezer, vinyl flooring, upvc double glazed window to side, wall mounted gas boiler.

Bedroom

11' 1" max x 10' 1" max (3.38m max x 3.07m max)

Upvc double glazed window to side, radiator.

Bathroom

Three piece suite comprising panel enclosed bath with shower over, low level w.c. and pedestal wash hand basin, part tiled walls, radiator, upvc double glazed window to side, vinyl flooring.

Outside

There is an allocated parking space, communal parking and gardens.

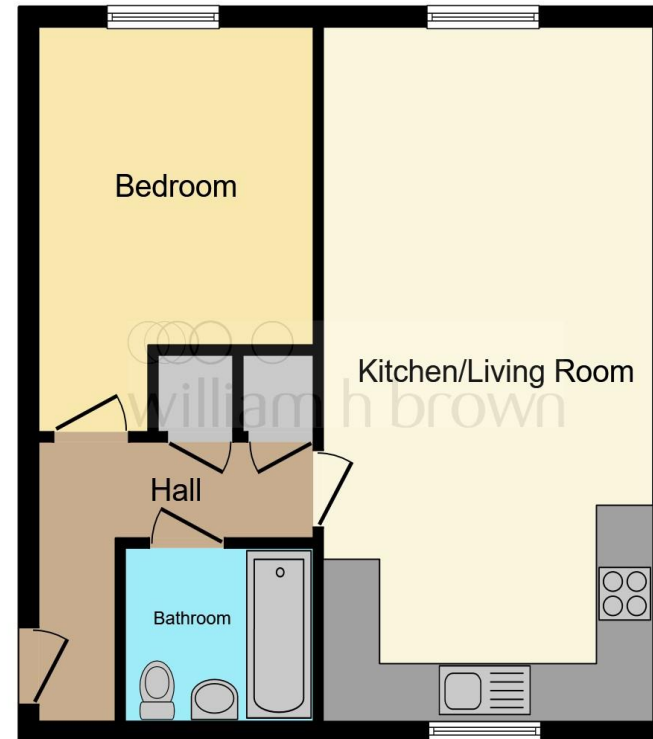

This floor plan is for illustrative purposes only. It is not drawn to scale. Any measurements, floor areas (including any total floor area), openings and orientation are approximate. No details are guaranteed, they cannot be relied upon for any purpose and they do not form part of any agreement. No liability is taken for any error, omission or misstatement. A party must rely upon its own inspection(s). Powered by www.focalagent.com



view this property online williamhbrown.co.uk/Property/CCS120050



welcome to

Pippin Way, Alresford Colchester

- SHARED OWNERSHIP First Floor Apartment
- Spacious Open Plan Living
- Double Bedroom
- Allocated Parking
- Communal Garden
- Popular Village Location
- Close To Train Station

Tenure: Leasehold EPC Rating: B

This is a Leasehold property with details as follows; Term of Lease 125 years from 30 Aug 2019. Should you require further information please contact the branch. Please Note additional fees could be incurred for items such as Leasehold packs.

£96,200



directions to this property:

Refer to map



Please note the marker reflects the postcode not the actual property

view this property online [williamhbrown.co.uk/Property/CCS120050](https://www.williamhbrown.co.uk/Property/CCS120050)



Property Ref:
CCS120050 - 0003

1. MONEY LAUNDERING REGULATIONS Intending purchasers will be asked to produce identification documentation at a later stage and we would ask for your co-operation in order that there is no delay in agreeing the sale. 2. These particulars do not constitute part or all of an offer or contract. 3. The measurements indicated are supplied for guidance only and as such must be considered incorrect. Potential buyers are advised to recheck measurements before committing to any expense. 4. We have not tested any apparatus, equipment, fixtures or services and it is in the buyers interest to check the working condition of any appliances. 5. Where an EPC, or a Home Report (Scotland only) is held for this property, it is available for inspection at the branch by appointment. If you require a printed version of a Home Report, you will need to pay a reasonable production charge reflecting printing and other costs. 6. We are not able to offer an opinion either written or verbal on the content of these reports and this must be obtained from your legal representative. 7. Whilst we take care in preparing these reports, a buyer should ensure that his/her legal representative confirms as soon as possible all matters relating to title including the extent and boundaries of the property and other important matters before exchange of contracts.

William H Brown is a trading name of Sequence (UK) Limited which is registered in England and Wales under company number 4268443, Registered Office is Cumbria House, 16-20 Hockliffe Street, Leighton Buzzard, Bedfordshire, LU7 1GN. VAT Registration Number is 500 2481 05.



william h brown



01206 577772



Colchester@williamhbrown.co.uk



8 Culver Street West, COLCHESTER, Essex, CO1 1JG



williamhbrown.co.uk